



OKLAHOMA DEPARTMENT OF TRANSPORTATION
SURVEY DIVISION

FLOOD INFORMATION FORM

District #:	1 <input type="checkbox"/> 2 <input type="checkbox"/> 3 <input type="checkbox"/> 4 <input type="checkbox"/> 5 <input type="checkbox"/> 6 <input type="checkbox"/> 7 <input checked="" type="checkbox"/> 8 <input type="checkbox"/>
County:	Love
Date Highwater occurred:	4/28/2021
Highway Number:	SH 32
Name of Stream:	none
Direction and distance from nearest town, or highway junction	On SH 32 approx. 0.75 miles West of I-35
Section, Township, Range:	Section 24 T 7 S , R 1 E
Description of Location:	Shots taken on centerline of highway.
Latitude	33^56'25.54161" N
Longitude	097 08 24.57021 W
Highwater Elevation:	845.24'
Level Datum & Source:	NAVD88 Geoid 18
Method used:	GPS Network
Date Elevation Obtained:	4/29/2021
Apparent Magnitude:	Normal <input type="checkbox"/> Medium <input checked="" type="checkbox"/> Extreme <input type="checkbox"/> Unknown <input type="checkbox"/>
Was Highwater Mark obtained from actual water, drift, local resident, or other source?	Obtained information from Marietta Maintenance barn.
Explanatory Remarks:	Flash Flood in the area.

Name (Signature) Lynn Hurley

Name (Printed) Lynn Hurley

Date 4-29-2021

Note: Show Vicinity Map on back of form

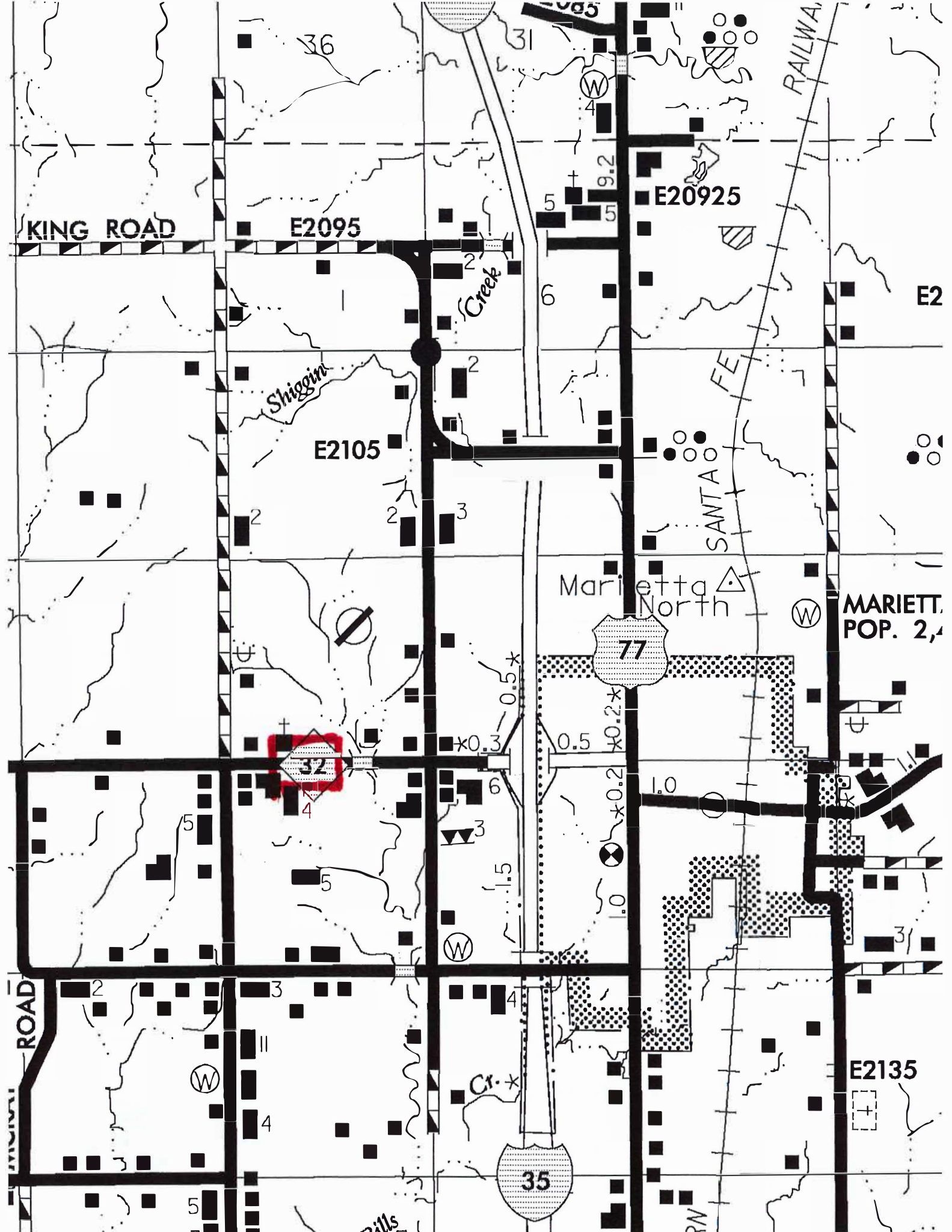

36

31

KING ROAD

E2095

E20925

E2

Shigoin

E2105

SANTA FE

Marietta North

MARIETT.
POP. 2,400

77

32

1.0

ROAD

E2135

35

Cr. *

hills

RN