



OKLAHOMA DEPARTMENT OF TRANSPORTATION
SURVEY DIVISION

FLOOD INFORMATION FORM

Division #:	1 <input type="checkbox"/> 2 <input type="checkbox"/> 3 <input type="checkbox"/> 4 <input type="checkbox"/> 5 <input type="checkbox"/> 6 <input type="checkbox"/> 7 X <input checked="" type="checkbox"/> 8 <input type="checkbox"/>
County:	Love
Date Highwater occurred:	06/17/2015
Highway Number:	I-35
Name of Stream:	Red River
Direction and distance from nearest town, or highway junction	I-35 @ Texas Border
Section, Township, Range:	Sec. 36 T-9-S R-1 E
Description of Location:	13938, 16644, F-141-A,B, Sta. 0+00
Highwater Elevation:	679.8882
Level Datum & Source:	NAVD83 GPS Static
Method used:	GPS Static
Date Elevation Obtained:	10/28/2015
Apparent Magnitude:	Normal <input type="checkbox"/> Medium <input type="checkbox"/> Extreme X <input checked="" type="checkbox"/> Don't Know <input type="checkbox"/>
Was Highwater Mark obtained from actual water, drift, local resident, or other source?	ODOT Maintenance
Explanatory Remarks:	

Note: Show Vicinity Map on back of form

Name (signature) 

Name (Printed) ROBERT UHLES

Date: 11/09/15

LOVE COUNTY

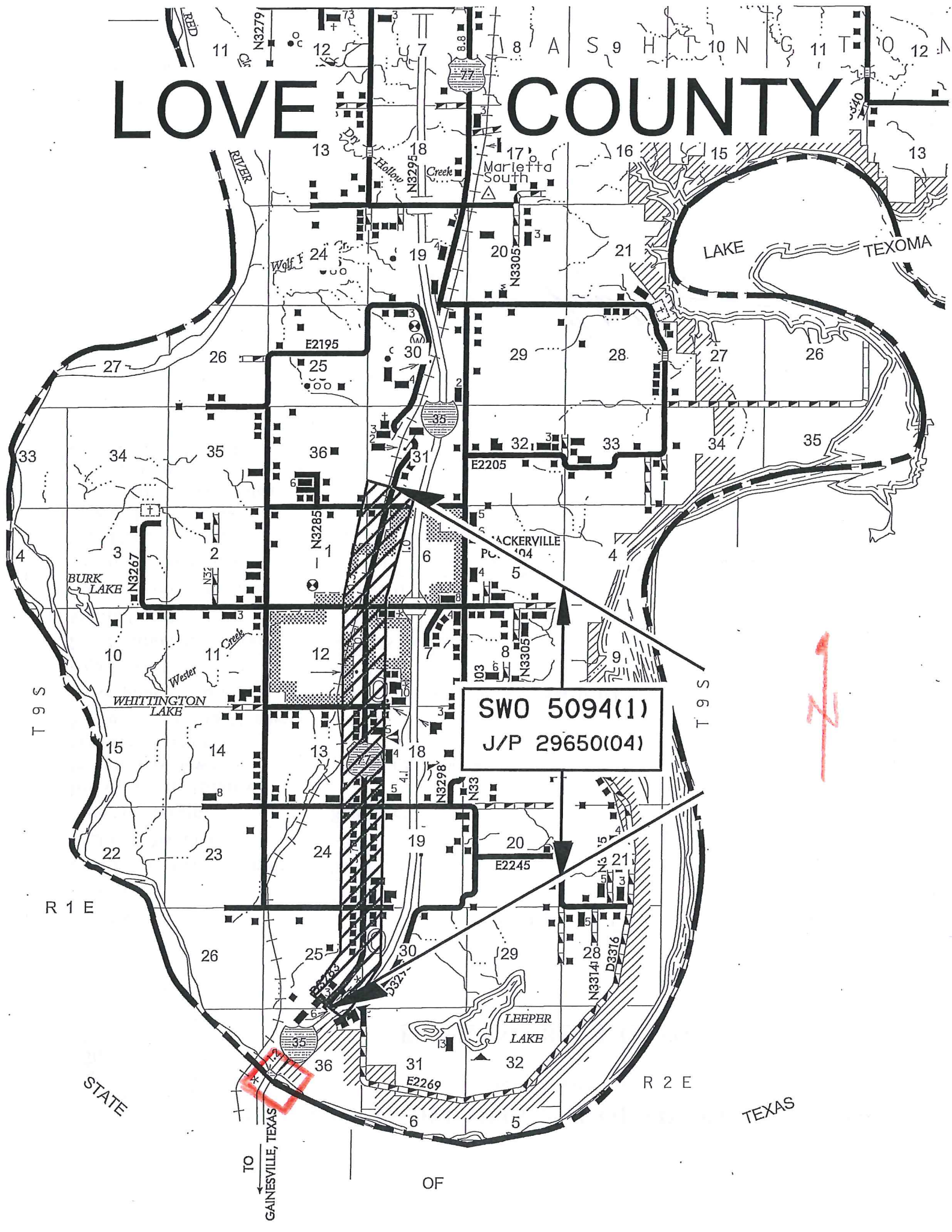

SWO 5094(1)
J/P 29650(04)

