

STATE OF OKLAHOMA
DEPARTMENT OF HIGHWAYS
SURVEY DIVISION

FLOOD INFORMATION FORM

To be used in obtaining and transmitting flood water elevations for Survey Division office record files. This information to be obtained by all Chiefs of Party or others in their vicinity in times of unusual high water, or at any time available from a reliable source. The elevations can be recorded by level reading, by measurement from bridge floor, in relation to a house, above roadbed or any other dependable, clear manner that fits the situation, the highest order possible to be used. Separate report to be made on each crossing or place obtained.

County LOVE Date highwater occurred OCTOBER 13, 1981
Highway number US 77 Name of stream LITTLE HICKORY CREEK
Direction and distance from nearest town, village or store 6.5 MILES NORTH
OF MARIETTA, OKLAHOMA.

Section, Township and Range SEC. 18, T6S, R2E.

Description of Location LOCATED AT STATION 134+00 OF F.A.P-NO. 142 ABC
US 77 PLANS.

Elevation 699.0 Source of levels FROM PLANS FAP #142.

Method obtained ENGINEERS LEVEL Date obtained OCTOBER 15, 1981.

Did it appear to be normal medium extreme do not know

Was highwater mark obtained from actual water, drift, local resident,
U. S. Engineers, etc.? ACTUAL WATER MARKS ON HOUSE AND DRIFTS AT BRIDGE.

Explanatory Remarks WATER WAS 1.0 FEET DEEP ON BRIDGE FLOOR.

Location to be shown on back of this sheet as a check.

Field Note: To be sent to
Survey Engineer

Bobby Earl Huland
Chief of Party

JUNE 15, 1982.
Date

Location No. 6

CARTER COUNTY

JEFERSON COUNTY

MARSHALL COUNTY

SPARTAN COUNTY

STATE OF OKLAHOMA

TERRAS

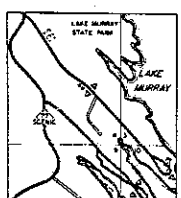
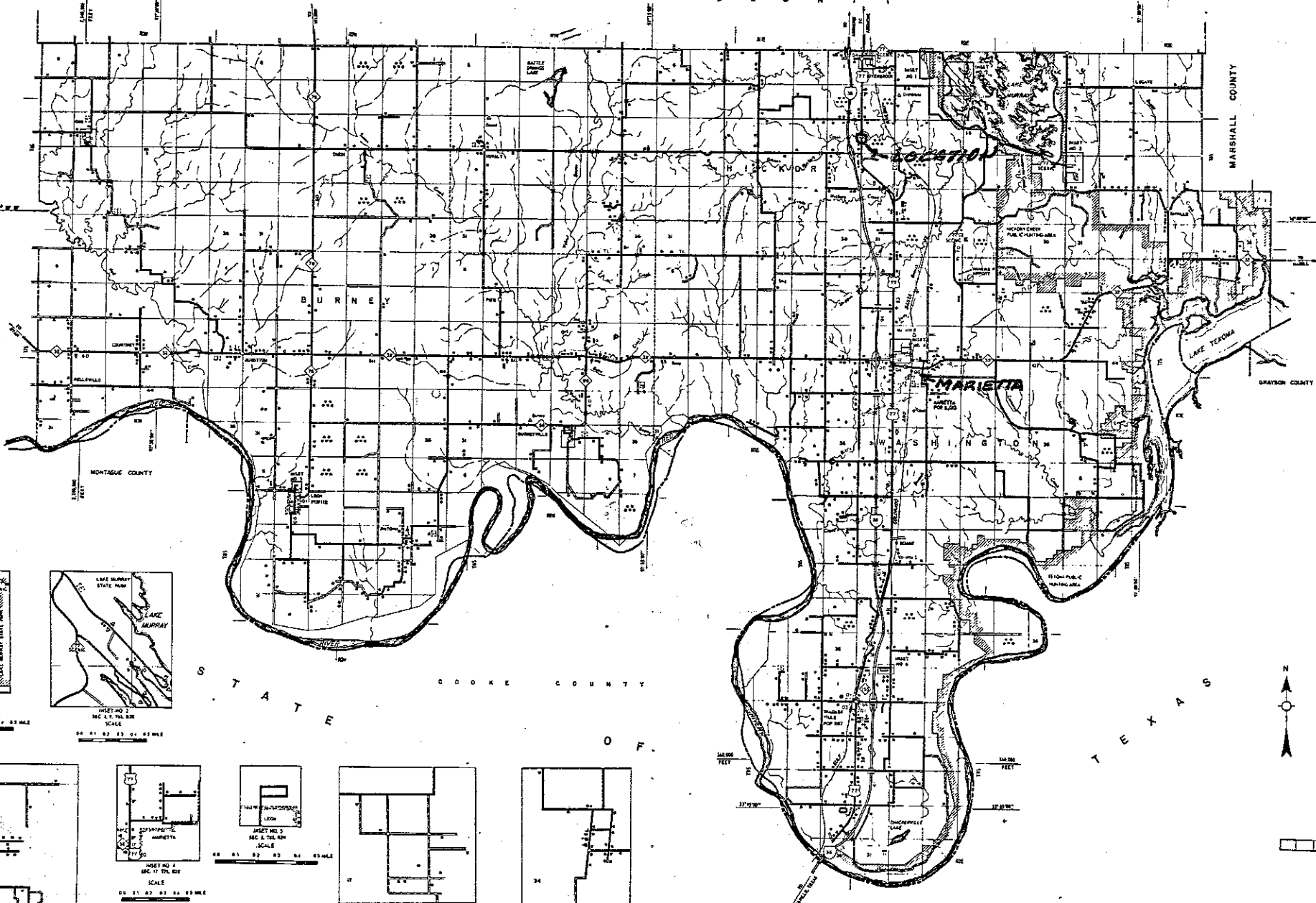

0 1 2 3 4 5 MILE

0 1 2 3 4 5 MILE

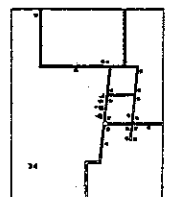
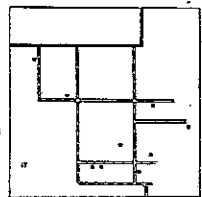
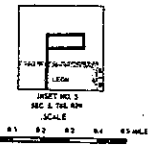
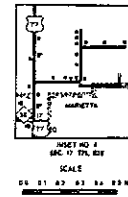
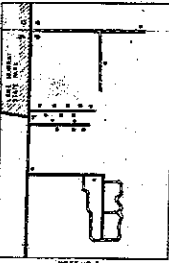

0 1 2 3 4 5 MILE

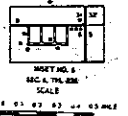
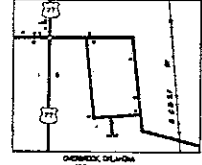

0 1 2 3 4 5 MILE

0 1 2 3 4 5 MILE

0 1 2 3 4 5 MILE

ALL DATA CURRENT TO
DATE OF INVENTORY
JULY 1958
ORIGINAL DRAFTED BY U.S. DEC. 1955
STATE SYSTEM REVISED TO JAN. 1958

GENERAL HIGHWAY MAP
LOVE COUNTY
OKLAHOMA
PREPARED BY THE
OKLAHOMA DEPARTMENT OF TRANSPORTATION
PLANNING DIVISION

IN COOPERATION WITH THE
U.S. DEPARTMENT OF TRANSPORTATION
FEDERAL HIGHWAY ADMINISTRATION

SCALE

NOT FOR RESALE

Legend and symbols for various map features including roads, water bodies, and land use. Includes a small map of Oklahoma showing the location of Love County.

OKLAHOMA DEPARTMENT OF TRANSPORTATION
PLANNING DIVISION
100 N.E. 11th STREET
TULSA, OKLAHOMA 74103