

STATE OF OKLAHOMA  
DEPARTMENT OF HIGHWAYS  
SURVEY DIVISION

Survey Division  
Form No. 16  
Rev. Sept. 10, 1961

FLOOD INFORMATION FORM

To be used in obtaining and transmitting flood water elevations for Survey Division office record files. This information to be obtained by all Chiefs of Party or others in their vicinity in times of unusual high water, or at any time available from a reliable source. The elevations can be recorded by level reading, by measurement from bridge floor, in relation to a house, above roadbed or any other dependable, clear manner that fits the situation, the highest order possible to be used. Separate report to be made on each crossing or place obtained.

County LOVE Date highwater occurred OCTOBER 13, 1981

Highway number I-35 Name of stream HICKORY CREEK

Direction and distance from nearest town, village or store 7.0 MILE NORTH OF MARIETTA, OKLAHOMA.

Section, Township and Range SEC. 12, T6S, R1E

Description of Location I-35 SOUTH BOUND LANE AT STA. 1191+26.00 OF I-35-1(24)022 PLANS.

Elevation 708.5 Source of levels USC&GS - PLANS

Method obtained ENGINEERS LEVEL Date obtained OCTOBER 15, 1981

Did it appear to be  normal  medium  extreme  do not know

Was highwater mark obtained from actual water, drift, local resident, U. S. Engineers, etc.? WATER MARK ON BRIDGE SOUTH BOUND LANE.

Explanatory Remarks WATER WAS 8.9 FEET BELOW BRIDGE FLOOR.

Location to be shown on back of this sheet as a check.

Field Note: To be sent to  
Survey Engineer

Bobby Earl Garland  
Chief of Party

JUNE 15, 1982  
Date

Location No. 8

CARTER COUNTY

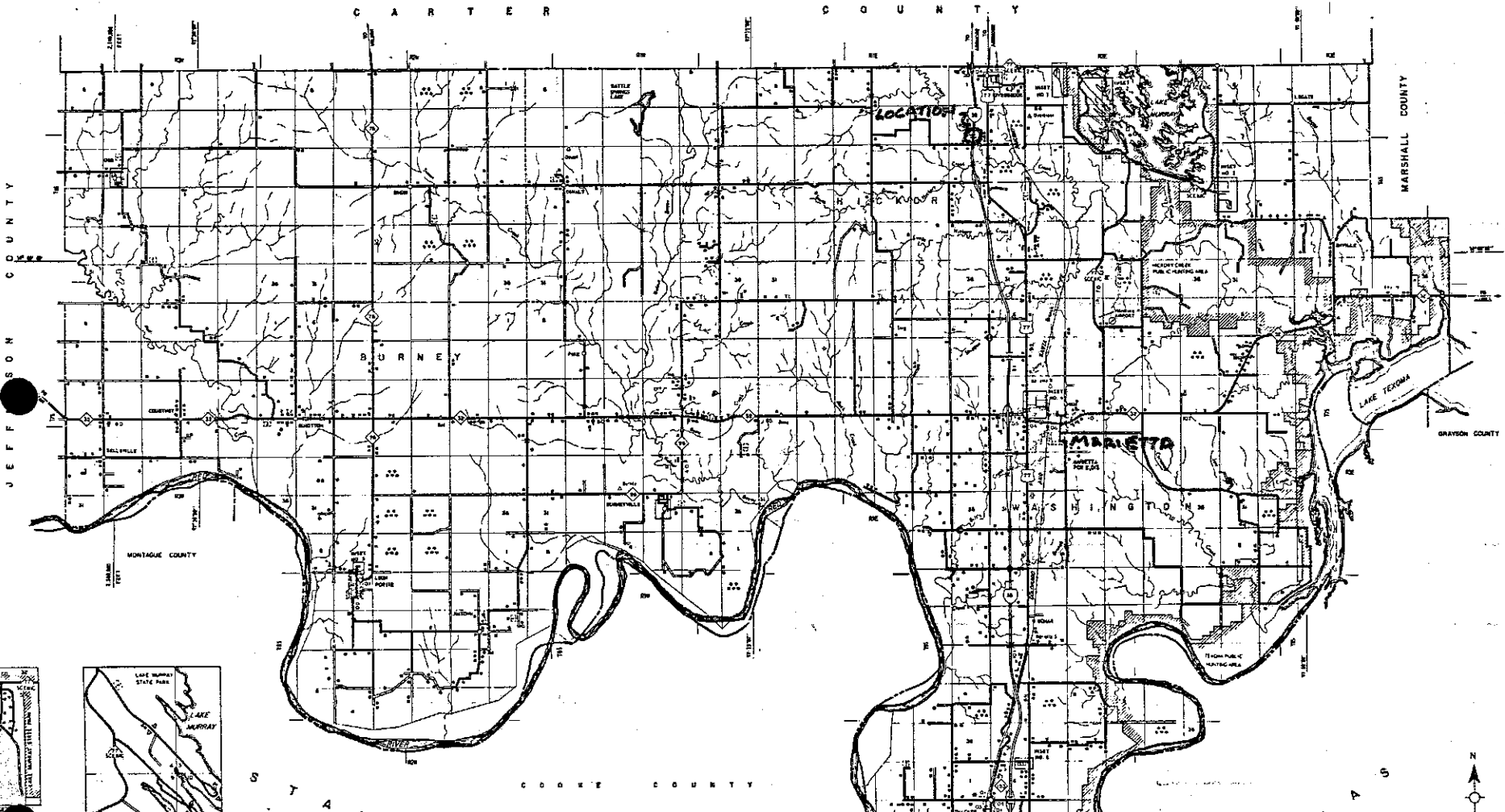

Legend table with symbols for various map features such as roads, water bodies, and land parcels.

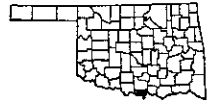
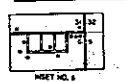
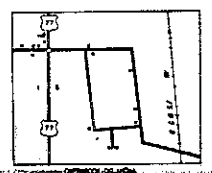
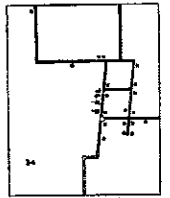
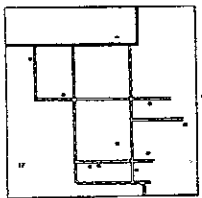
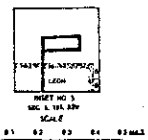
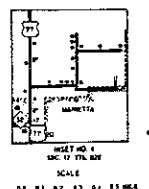
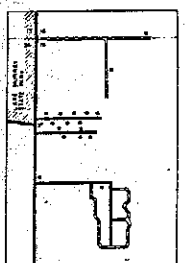
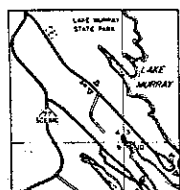

GENERAL HIGHWAY MAP  
LOVE COUNTY  
OKLAHOMA

Prepared by the  
OKLAHOMA DEPARTMENT OF TRANSPORTATION  
PLANNING DIVISION

U.S. DEPARTMENT OF TRANSPORTATION  
FEDERAL HIGHWAY ADMINISTRATION

ALL DATA CURRENT TO  
DATE OF SURVEY  
JULY 1958  
ORIGINAL DRAFTING BY U.S. DEC. 1958  
STATE SYSTEM REVISED TO DATE 1958

NOT FOR RESALE