

Survey Division
Form No. 16
Rev. Sept. 10, 1961

STATE OF OKLAHOMA
DEPARTMENT OF HIGHWAYS
SURVEY DIVISION

FLOOD INFORMATION FORM

To be used in obtaining and transmitting flood water elevations for Survey Division office record files. This information to be obtained by all Chiefs of Party or others in their vicinity in times of unusual high water, or at any time available from a reliable source. The elevations can be recorded by level reading, by measurement from bridge floor, in relation to a house, above roadbed or any other dependable, clear manner that fits the situation, the highest order possible to be used. Separate report to be made on each crossing or place obtained.

County LOVE Date highwater occurred OCTOBER 13, 1981

Highway number SH 32 Name of stream WALNUT CREEK AREA.

Direction and distance from nearest town, village or store 10 MILES WEST OF MARIETTA, OKLAHOMA.

Section, Township and Range SEC. 15 & 16, T7S, R1W.

Description of Location THIS IN THE CREEK AREA OF WALNUT CREEK - FROM STA. 451+31.9 TO STA. 479+85.91 OF S.A.P-821(2) SH 32 PLANS.

Elevation 704.5 Source of levels USC&GS (PLANS)

Method obtained ENGINEERS LEVEL Date obtained OCTOBER 15, 1981

Did it appear to be normal medium extreme do not know

Was highwater mark obtained from actual water, drift, local resident, U. S. Engineers, etc.? ACTUAL WATER MARK.

Explanatory Remarks WATER CROSSED SH 32 HWY. EAST OF BRIDGE, FROM STA. 483 TO STA. 500 APPROX. 1.0 FEET DEEP OF SAP-821(2) PLANS.

Location to be shown on back of this sheet as a check.

Field Note: To be sent to
Survey Engineer

Bobby Earl Garland
Chief of Party

JUNE 15, 1982
Date

Location No. 9

CARTER COUNTY

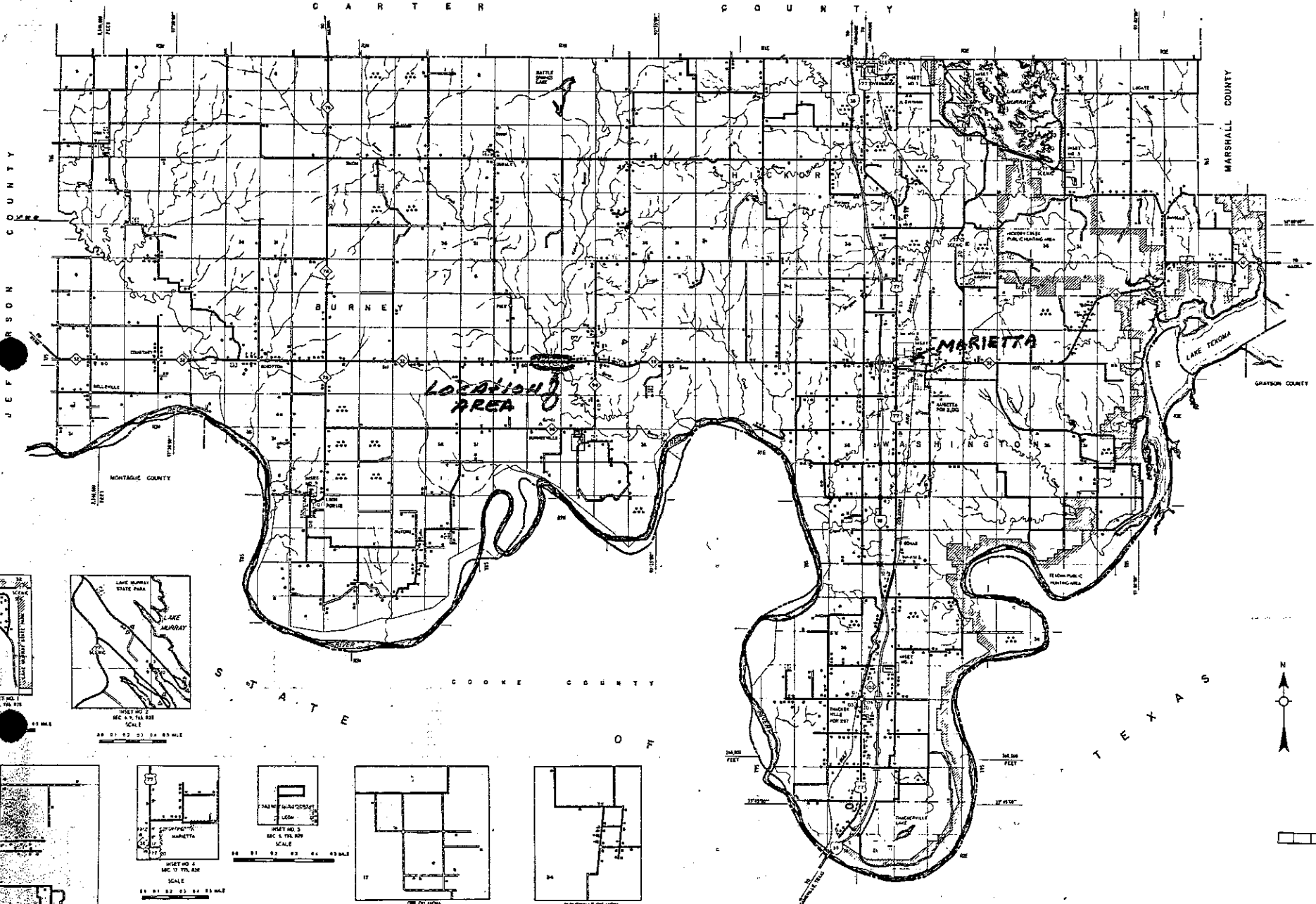

- 1. PROPOSED HIGHWAY
- 2. EXISTING HIGHWAY
- 3. RAILROAD
- 4. CANAL
- 5. WATERWAY
- 6. FLOOD PLAIN
- 7. UNDEVELOPED LAND
- 8. CROPLAND
- 9. PASTURE
- 10. WOODLAND
- 11. SWAMP
- 12. LAKE
- 13. RIVER
- 14. CREEK
- 15. TOWN
- 16. VILLAGE
- 17. SCHOOL
- 18. CHURCH
- 19. PUBLIC BUILDING
- 20. PRIVATE BUILDING
- 21. POWER LINE
- 22. TELEPHONE LINE
- 23. FENCE
- 24. ELEVATION
- 25. SPOT ELEVATION
- 26. SECTION CORNER
- 27. QUARTER CORNER
- 28. TIE LINE
- 29. EASEMENT
- 30. RIGHT-OF-WAY
- 31. ADJACENT PROPERTY
- 32. ADJACENT SECTION
- 33. ADJACENT COUNTY
- 34. ADJACENT STATE
- 35. ADJACENT COUNTRY
- 36. ADJACENT OCEAN
- 37. ADJACENT MOUNTAIN
- 38. ADJACENT PLAIN
- 39. ADJACENT HILLS
- 40. ADJACENT VALLEY
- 41. ADJACENT MOUNTAIN RANGE
- 42. ADJACENT PLAIN
- 43. ADJACENT HILLS
- 44. ADJACENT VALLEY
- 45. ADJACENT MOUNTAIN RANGE
- 46. ADJACENT PLAIN
- 47. ADJACENT HILLS
- 48. ADJACENT VALLEY
- 49. ADJACENT MOUNTAIN RANGE
- 50. ADJACENT PLAIN
- 51. ADJACENT HILLS
- 52. ADJACENT VALLEY
- 53. ADJACENT MOUNTAIN RANGE
- 54. ADJACENT PLAIN
- 55. ADJACENT HILLS
- 56. ADJACENT VALLEY
- 57. ADJACENT MOUNTAIN RANGE
- 58. ADJACENT PLAIN
- 59. ADJACENT HILLS
- 60. ADJACENT VALLEY
- 61. ADJACENT MOUNTAIN RANGE
- 62. ADJACENT PLAIN
- 63. ADJACENT HILLS
- 64. ADJACENT VALLEY
- 65. ADJACENT MOUNTAIN RANGE
- 66. ADJACENT PLAIN
- 67. ADJACENT HILLS
- 68. ADJACENT VALLEY
- 69. ADJACENT MOUNTAIN RANGE
- 70. ADJACENT PLAIN
- 71. ADJACENT HILLS
- 72. ADJACENT VALLEY
- 73. ADJACENT MOUNTAIN RANGE
- 74. ADJACENT PLAIN
- 75. ADJACENT HILLS
- 76. ADJACENT VALLEY
- 77. ADJACENT MOUNTAIN RANGE
- 78. ADJACENT PLAIN
- 79. ADJACENT HILLS
- 80. ADJACENT VALLEY
- 81. ADJACENT MOUNTAIN RANGE
- 82. ADJACENT PLAIN
- 83. ADJACENT HILLS
- 84. ADJACENT VALLEY
- 85. ADJACENT MOUNTAIN RANGE
- 86. ADJACENT PLAIN
- 87. ADJACENT HILLS
- 88. ADJACENT VALLEY
- 89. ADJACENT MOUNTAIN RANGE
- 90. ADJACENT PLAIN
- 91. ADJACENT HILLS
- 92. ADJACENT VALLEY
- 93. ADJACENT MOUNTAIN RANGE
- 94. ADJACENT PLAIN
- 95. ADJACENT HILLS
- 96. ADJACENT VALLEY
- 97. ADJACENT MOUNTAIN RANGE
- 98. ADJACENT PLAIN
- 99. ADJACENT HILLS
- 100. ADJACENT VALLEY
- 101. ADJACENT MOUNTAIN RANGE
- 102. ADJACENT PLAIN
- 103. ADJACENT HILLS
- 104. ADJACENT VALLEY
- 105. ADJACENT MOUNTAIN RANGE
- 106. ADJACENT PLAIN
- 107. ADJACENT HILLS
- 108. ADJACENT VALLEY
- 109. ADJACENT MOUNTAIN RANGE
- 110. ADJACENT PLAIN
- 111. ADJACENT HILLS
- 112. ADJACENT VALLEY
- 113. ADJACENT MOUNTAIN RANGE
- 114. ADJACENT PLAIN
- 115. ADJACENT HILLS
- 116. ADJACENT VALLEY
- 117. ADJACENT MOUNTAIN RANGE
- 118. ADJACENT PLAIN
- 119. ADJACENT HILLS
- 120. ADJACENT VALLEY
- 121. ADJACENT MOUNTAIN RANGE
- 122. ADJACENT PLAIN
- 123. ADJACENT HILLS
- 124. ADJACENT VALLEY
- 125. ADJACENT MOUNTAIN RANGE
- 126. ADJACENT PLAIN
- 127. ADJACENT HILLS
- 128. ADJACENT VALLEY
- 129. ADJACENT MOUNTAIN RANGE
- 130. ADJACENT PLAIN
- 131. ADJACENT HILLS
- 132. ADJACENT VALLEY
- 133. ADJACENT MOUNTAIN RANGE
- 134. ADJACENT PLAIN
- 135. ADJACENT HILLS
- 136. ADJACENT VALLEY
- 137. ADJACENT MOUNTAIN RANGE
- 138. ADJACENT PLAIN
- 139. ADJACENT HILLS
- 140. ADJACENT VALLEY
- 141. ADJACENT MOUNTAIN RANGE
- 142. ADJACENT PLAIN
- 143. ADJACENT HILLS
- 144. ADJACENT VALLEY
- 145. ADJACENT MOUNTAIN RANGE
- 146. ADJACENT PLAIN
- 147. ADJACENT HILLS
- 148. ADJACENT VALLEY
- 149. ADJACENT MOUNTAIN RANGE
- 150. ADJACENT PLAIN
- 151. ADJACENT HILLS
- 152. ADJACENT VALLEY
- 153. ADJACENT MOUNTAIN RANGE
- 154. ADJACENT PLAIN
- 155. ADJACENT HILLS
- 156. ADJACENT VALLEY
- 157. ADJACENT MOUNTAIN RANGE
- 158. ADJACENT PLAIN
- 159. ADJACENT HILLS
- 160. ADJACENT VALLEY
- 161. ADJACENT MOUNTAIN RANGE
- 162. ADJACENT PLAIN
- 163. ADJACENT HILLS
- 164. ADJACENT VALLEY
- 165. ADJACENT MOUNTAIN RANGE
- 166. ADJACENT PLAIN
- 167. ADJACENT HILLS
- 168. ADJACENT VALLEY
- 169. ADJACENT MOUNTAIN RANGE
- 170. ADJACENT PLAIN
- 171. ADJACENT HILLS
- 172. ADJACENT VALLEY
- 173. ADJACENT MOUNTAIN RANGE
- 174. ADJACENT PLAIN
- 175. ADJACENT HILLS
- 176. ADJACENT VALLEY
- 177. ADJACENT MOUNTAIN RANGE
- 178. ADJACENT PLAIN
- 179. ADJACENT HILLS
- 180. ADJACENT VALLEY
- 181. ADJACENT MOUNTAIN RANGE
- 182. ADJACENT PLAIN
- 183. ADJACENT HILLS
- 184. ADJACENT VALLEY
- 185. ADJACENT MOUNTAIN RANGE
- 186. ADJACENT PLAIN
- 187. ADJACENT HILLS
- 188. ADJACENT VALLEY
- 189. ADJACENT MOUNTAIN RANGE
- 190. ADJACENT PLAIN
- 191. ADJACENT HILLS
- 192. ADJACENT VALLEY
- 193. ADJACENT MOUNTAIN RANGE
- 194. ADJACENT PLAIN
- 195. ADJACENT HILLS
- 196. ADJACENT VALLEY
- 197. ADJACENT MOUNTAIN RANGE
- 198. ADJACENT PLAIN
- 199. ADJACENT HILLS
- 200. ADJACENT VALLEY

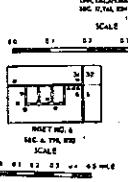
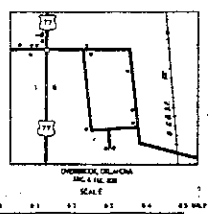
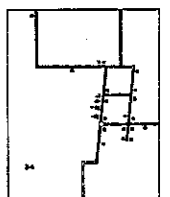
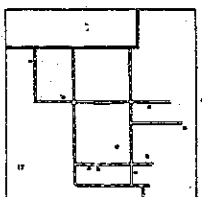
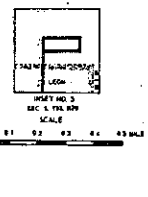
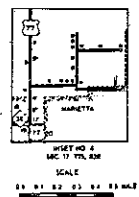
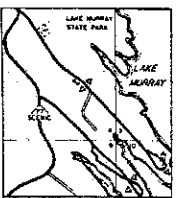

ALL DATA SUBJECT TO DATE OF INVENTORY JULY 1974
OKLAHOMA DRAFTING SERVICE, INC. 1974
STATE SYSTEM REVISED TO JAN. 1960

GENERAL HIGHWAY MAP
LOVE COUNTY
OKLAHOMA

PREPARED BY
OKLAHOMA DEPARTMENT OF TRANSPORT
PLANNING DIVISION

U.S. DEPARTMENT OF TRANSPORTATION
FEDERAL HIGHWAY ADMINISTRATION

NOT FOR RESALE

ALL RIGHTS RESERVED