

Survey Division  
Form No. 16  
Rev. Sept. 10, 1961

STATE OF OKLAHOMA  
DEPARTMENT OF HIGHWAYS  
SURVEY DIVISION

FLOOD INFORMATION FORM

To be used in obtaining and transmitting flood water elevations for Survey Division office record files. This information to be obtained by all Chiefs of Party or others in their vicinity in times of unusual high water, or at any time available from a reliable source. The elevations can be recorded by level reading, by measurement from bridge floor, in relation to a house, above roadbed or any other dependable, clear manner that fits the situation, the highest order possible to be used. Separate report to be made on each crossing or place obtained.

County LOVE Date highwater occurred OCTOBER 13, 1981

Highway number SH 96 Name of stream WALNUT CREEK

Direction and distance from nearest town, village or store 1.0 MILE NORTHEAST  
OF BURNEYVILLE, OKLAHOMA.

Section, Township and Range SEC. 22 & 23, T7S, R1W.

Description of Location \_\_\_\_\_

Elevation 3.7 FEET BELOW Source of levels NO. PLANS TAKEN FROM BR. FLOOR

EXISTING BR. FLOOR

Method obtained ENGINEERS LEVEL Date obtained OCTOBER 15, 1981

Did it appear to be  normal  medium  extreme  do not know

Was highwater mark obtained from actual water, drift, local resident,  
U. S. Engineers, etc.? WATER MARK

Explanatory Remarks WATER WAS 3.7 FEET BELOW EXISTING BRIDGE FLOOR.

THIS BRIDGE WAS NOT UNDER WATER

ROAD CLOSED DUE TO WATER OVER

ROAD BOTH NORTH & SOUTH OF BRIDGE

Location to be shown on back of this sheet as a check.

Field Note: To be sent to  
Survey Engineer

Bobby E. Ireland  
Chief of Party

JUNE 15, 1981

Date

Location No. 10

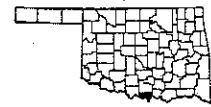
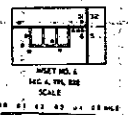
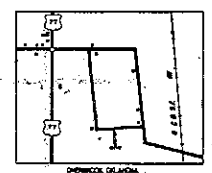
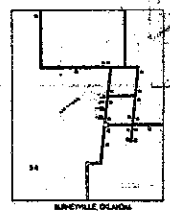
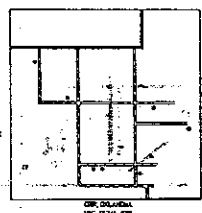
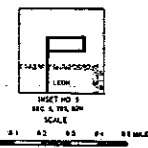
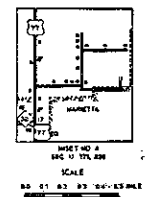
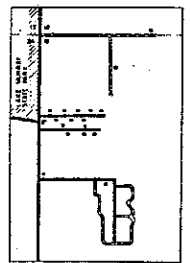
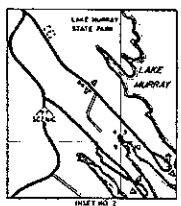
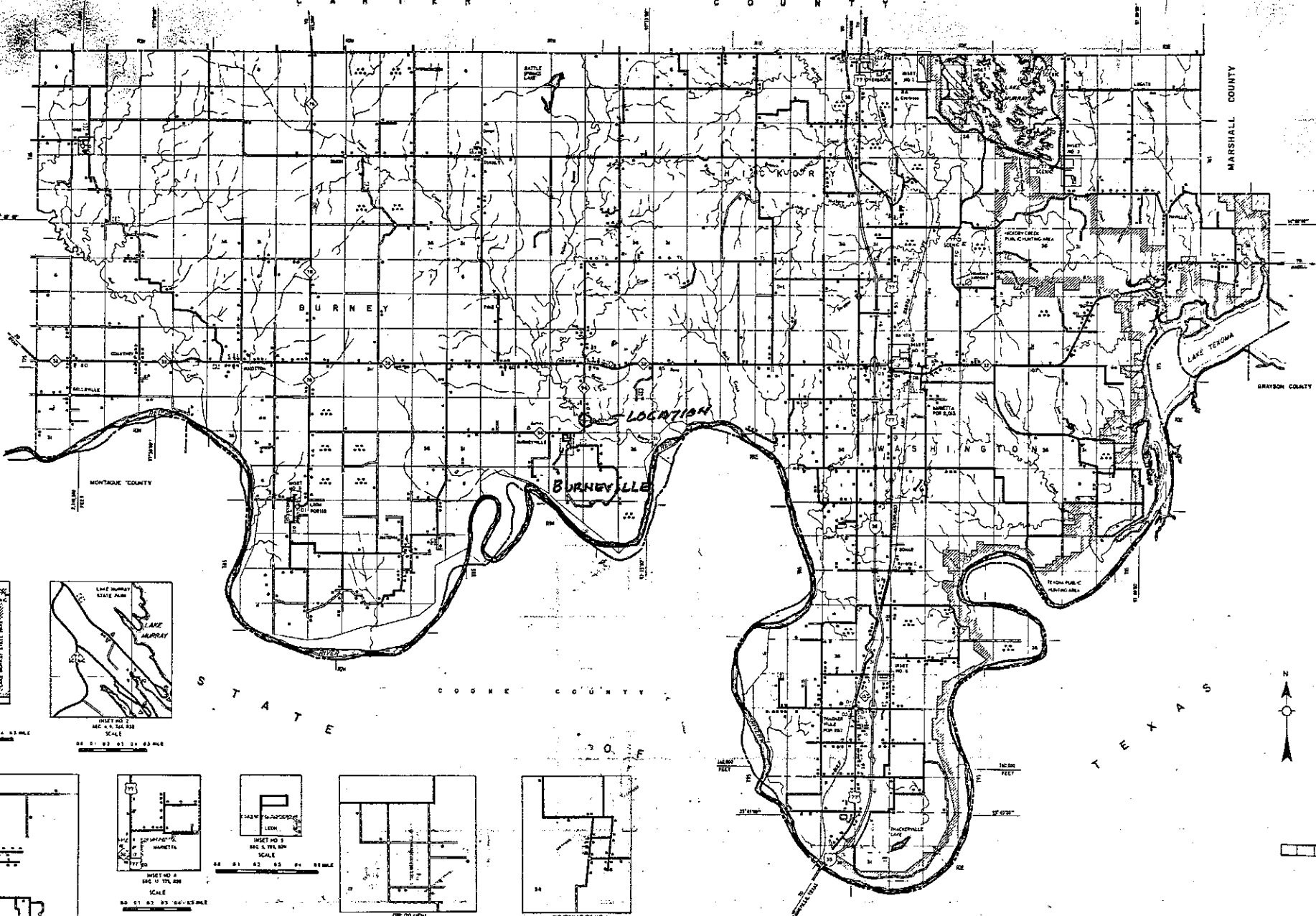

**GENERAL HIGHWAY MAP**  
**LOVE COUNTY**  
**OKLAHOMA**  
 PREPARED BY THE  
**OKLAHOMA DEPARTMENT OF TRANSPORTATION**  
**PLANNING DIVISION**

IN COOPERATION WITH THE  
**U.S. DEPARTMENT OF TRANSPORTATION**  
**FEDERAL HIGHWAY ADMINISTRATION**

ALL DATA CURRENT TO  
 DATE OF INVENTORY  
 JULY 1966  
 ORIGINAL DRAFTING BY MSB DEC 1965  
 STATE SYSTEM REVISED TO JAL 1966

**NOT FOR RESALE**