

STATE OF OKLAHOMA
DEPARTMENT OF HIGHWAYS
PLANS AND SURVEY DEPARTMENT

Plans & Survey Dept.
Form No. 16
Rev. July 10, 1947

FLOOD INFORMATION FORM

To be used in obtaining and transmitting flood water elevations for Plans & Survey office record files. This information to be obtained by all Chiefs of Party in their vicinity in times of unusual high water, or at any time available from a reliable source. The elevations can be recorded by level reading, by measurement from bridge floor, in relation to a house, above roadbed or any other dependable, clear manner that fits the situation, the highest order possible to be used. Separate report to be made on each crossing or place obtained.

County Logan Date highwater occurred 9-16-63

Highway number SH 74 Name of stream Cotton Wood Creek over-flow channel

Direction and distance from nearest town, village or store 12 miles South of Crescent, Oklahoma on SH 74

Section, Township and Range Sections 13 and 14 T 15N R 4 W

Description of Location Cotton Wood Creek over flow bridge which is first Bridge South of Cotton Wood Creek bridge and 12.0 miles South of Crescent

Method obtained V Level

Elevation _____ Source of levels _____

Was highwater mark obtained from actual water, drift, local resident, U. S. Engineers, etc? By local resident and visible drifts

Explanatory Remarks Highwater information was obtained by drifts and resident

Roy Leonard, Route 2, Guthrie, Okla. Roy Leonard lives first house South of bridge and on West side of SH 74. The highwater was 2.1 above hub guard of over flow

bridge which is first bridge South of Main Cotton Wood Creek bridge. Mr. Leonard said this is the highest the water has ever been. Location to be shown on back of this sheet as a check.

Field Note: To be sent to Engr. of Plans & Survey (1 copy).

Office Note: To be filed in Flood Information by Counties.

R.O. CARTMILL BY B.E. Leonard
Chief of Party

10-14-63
Date

SURVEY DIVISION

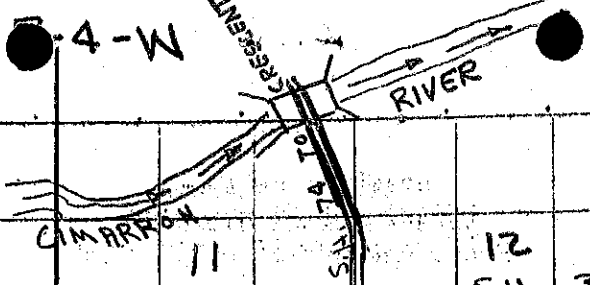

T
16
N

T
15
N

