

Plans & Survey Dept.
Form No. 16
Rev. July 10, 1947

STATE OF OKLAHOMA
DEPARTMENT OF HIGHWAYS
PLANS AND SURVEY DEPARTMENT

FLOOD INFORMATION FORM

To be used in obtaining and transmitting flood water elevations for Plans & Survey office record files. This information to be obtained by all Chiefs of Party in their vicinity in times of unusual high water, or at any time available from a reliable source. The elevations can be recorded by level reading, by measurement from bridge floor, in relation to a house, above roadbed or any other dependable, clear manner that fits the situation, the highest order possible to be used. Separate report to be made on each crossing or place obtained.

County Logan Date highwater occurred 9-16-63

Highway number SH 74 Name of stream Cotton Wood Creek

Direction and distance from nearest town, village or store 12 miles south of Crescent, Oklahoma on SH 74.

Section, Township and Range Section 13 and 14; Township 15-N; Range 4-W

Description of Location Cotton Wood Creek 12.0 miles South of Crescent.

Method obtained Y Level

Elevation _____ Source of levels _____

Was highwater mark obtained from actual water, drift, local resident, U. S. Engineers, etc? By local resident and visiable drifts.

Explanatory Remarks High-water information was obtained from visiable drifts which was 3.0' below bridge floor. And varified by Roy Leonard, Route 2, Guthrie, Oklahoma. He lives in first house south of Cotton Wood Creek bridge and west side of Road, SH 74 This is the highest the water has ever been according to Roy Leonards knowledge.

Location to be shown on back of this sheet as a check.

Field Note: To be sent to Engr. of Plans & Survey (1 copy).
Office Note: To be filed in Flood Information by Counties.

R. O. CARTMILL BY B. E. Ireland
Chief of Party

Date

SECTION

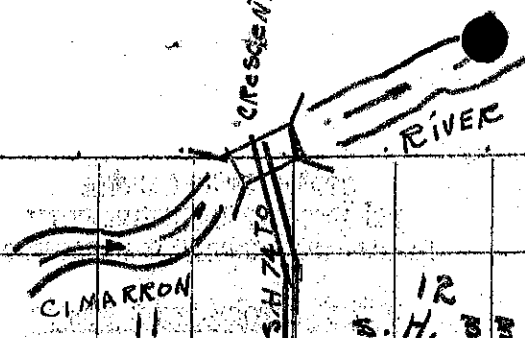

T
16
N



T
15
N

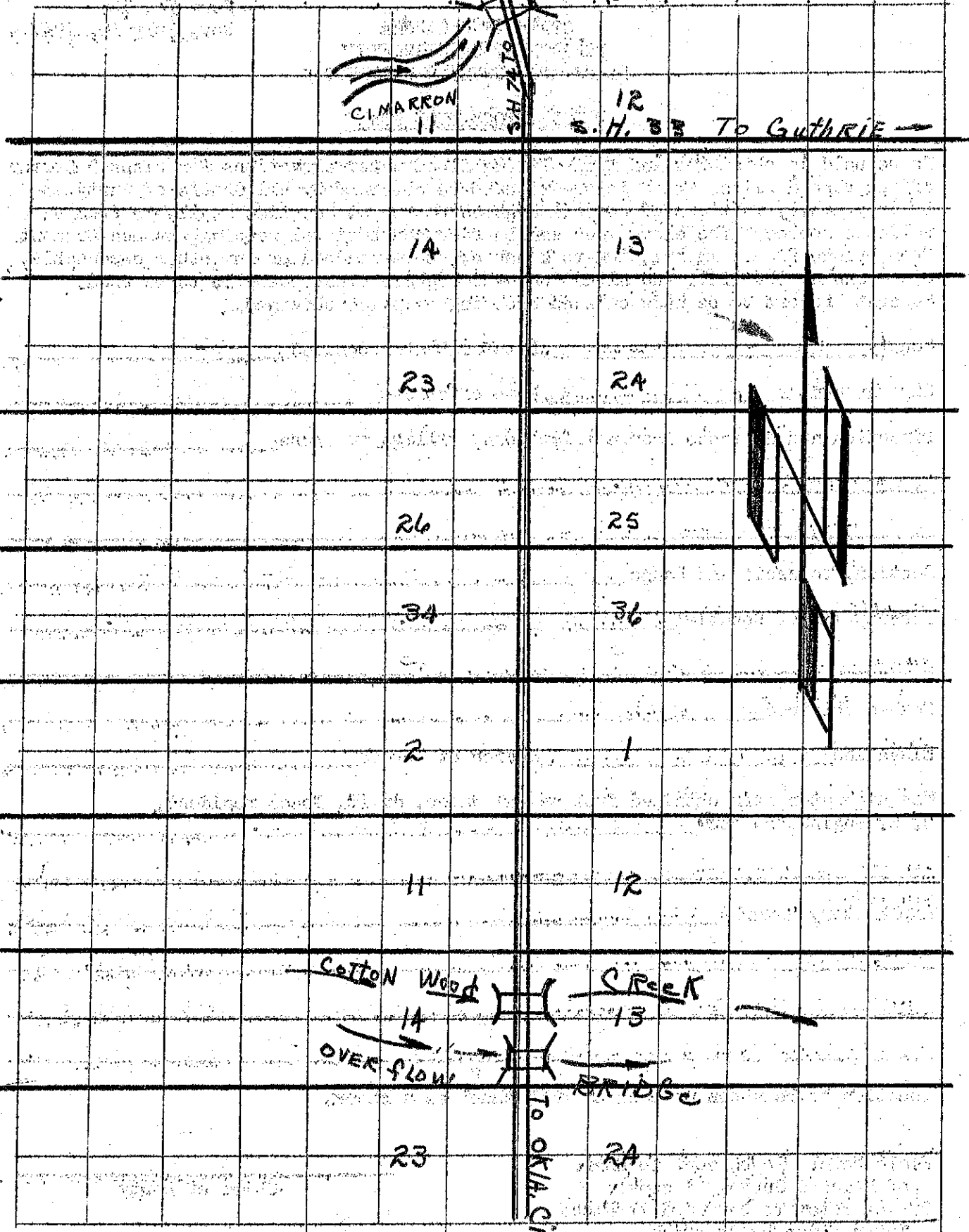
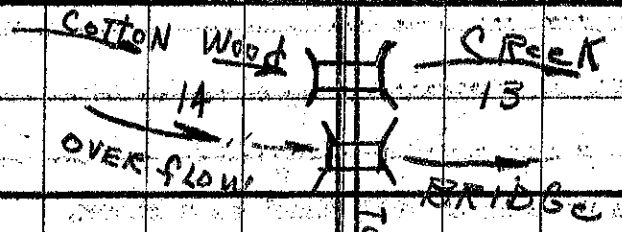

Crescent
S. H. 33
TO OKLA CITY

CIMARRON
11

12
S. H. 33 To Guthrie

14

13

23

24

26

25

34

36

2

1

11

12

Cotton Wood

Creek

14

13

OVERFLOW

BRIDGE

23

24