

STATE OF OKLAHOMA
DEPARTMENT OF HIGHWAYS
PLANS AND SURVEY DEPARTMENT

FLOOD INFORMATION FORM

To be used in obtaining and transmitting flood water elevations for Plans & Survey office record files. This information to be obtained by all Chiefs of Party in their vicinity in times of unusual high water, or at any time available from a reliable source. The elevations can be recorded by level reading, by measurement from bridge floor, in relation to a house, above roadbed or any other dependable, clear manner that fits the situation, the highest order possible to be used. Separate report to be made on each crossing or place obtained.

County Logan Date highwater occurred September 16, 1963

Highway number SH 74 Name of stream Cottonwood Creek

Direction and distance from nearest town, village or store 6 1/2 miles south of Jct. SH 74 & SH 33, or 9 miles west and 7 miles south of Guthrie, Okla. On SH 74 at Cottonwood Creek Bridge.

Section, Township and Range Between Sections 13 & 14, T 15 N, R 4 W.

Description of Location Bridge at Cottonwood Creek, 6 1/2 miles south of Jct. SH 74 & SH 33 on SH 74.

Method obtained Hand Level & Philadelphia Rod.

Elevation 3.5 feet lower than Bridge Source of levels floor at south end of bridge.

Was highwater mark obtained from actual water, drift, local resident, U. S. Engineers, etc? High water was obtained from actual high water.

Explanatory Remarks The rain in this drainage area was extremely spotted, but the rain fall was from 3 to 7 inches in this drainage area.

Location to be shown on back of this sheet as a check.

Field Note: To be sent to Engr. of Plans & Survey (1 copy).
Office Note: To be filed in Flood Information by Counties.

Arnold Redwin
Chief of Party

Oct. 9, 1963
Date

RAW

R3W

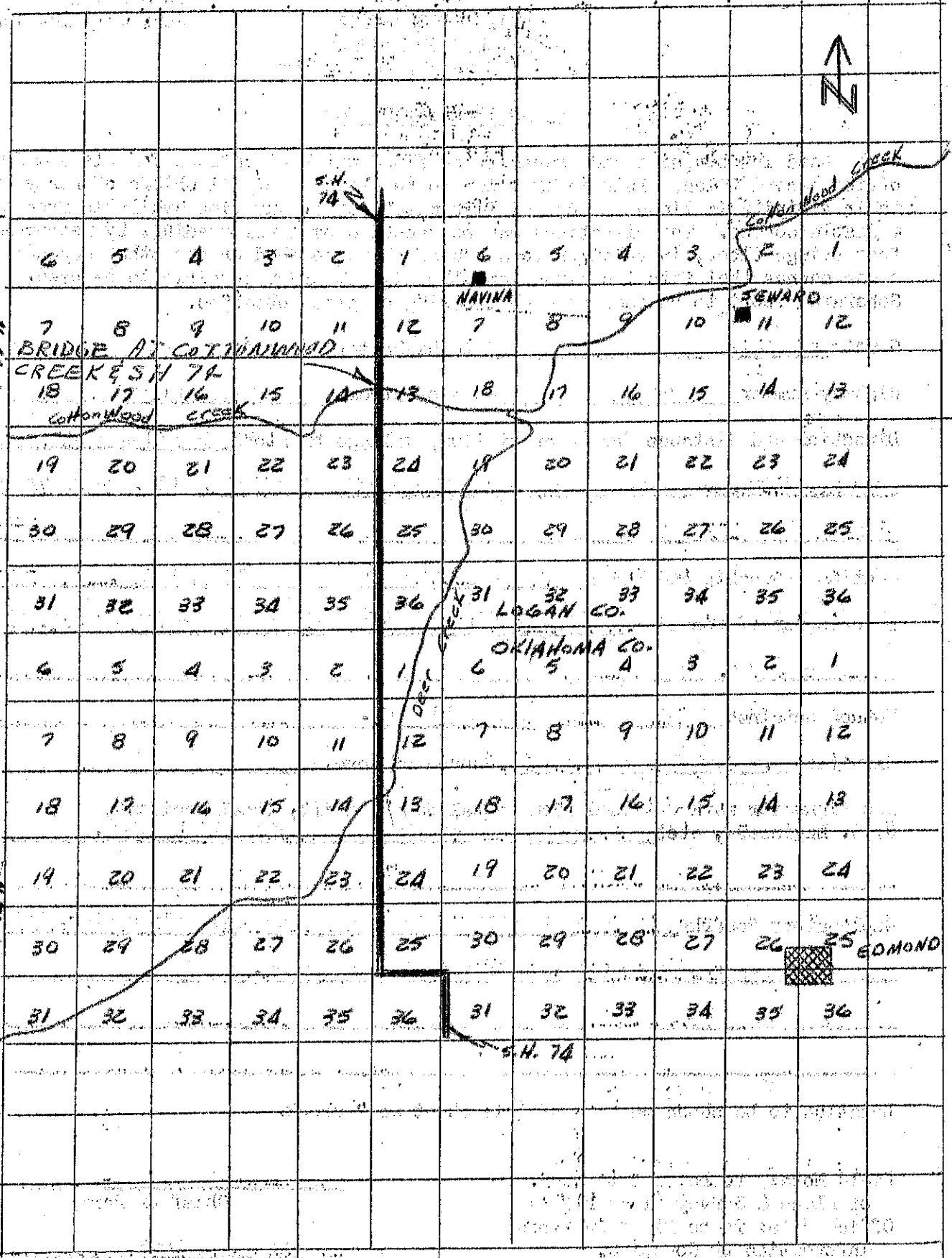

T 15 N

T 15 N

R 4 W

R 3 W

T 14 N

T 14 N

RAW

R3W

BRIDGE AT COTTONWOOD
CREEK S.H. 74
Cottonwood Creek

NAVINA

SEWARD

LOGAN CO.

OKLAHOMA CO.

EDMOND

S.H. 74

S.H. 74

S.H. 74

