

STATE OF OKLAHOMA
DEPARTMENT OF HIGHWAYS
SURVEY DIVISION

FLOOD INFORMATION FORM

To be used in obtaining and transmitting flood water elevations for Survey Division office record files. This information to be obtained by all Chiefs of Party or others in their vicinity in times of unusual high water, or at any time available from a reliable source. The elevations can be recorded by level reading, by measurement from bridge floor, in relation to a house, above roadbed or any other dependable, clear manner that fits the situation, the highest order possible to be used. Separate report to be made on each crossing or place obtained.

County LOGAN Date highwater occurred Sept. 21, 1965

Highway number US 77 Name of stream Cimarron River

Direction and distance from nearest town, village or store Approx. 1.5 miles North of Guthrie at Cimarron River Bridge on US 77

Section, Township and Range Sec. 28 T17N - R2W

Description of Location _____

Elevation _____ Source of levels _____

Method obtained Hand level Date obtained Sept. 22, 1965

Did it appear to be normal medium extreme do not know

Was highwater mark obtained from actual water, drift, local resident, U. S. Engineers, etc.? _____

Explanatory Remarks 9.0 Below Br. seat at South End of Bridge, obtained by W. J. McLaughlin and Bob Hudson from silt on Rock Rip Rap.

Location to be shown on back of this sheet as a check.

Field Note: To be sent to Survey Engineer

W. J. McLaughlin
Chief of Party
9/24/65
Date

LOCATION NO. 10

R2W

R-1-W

INSET NO. 1
SEC 7, T16N, R2W
SCALE

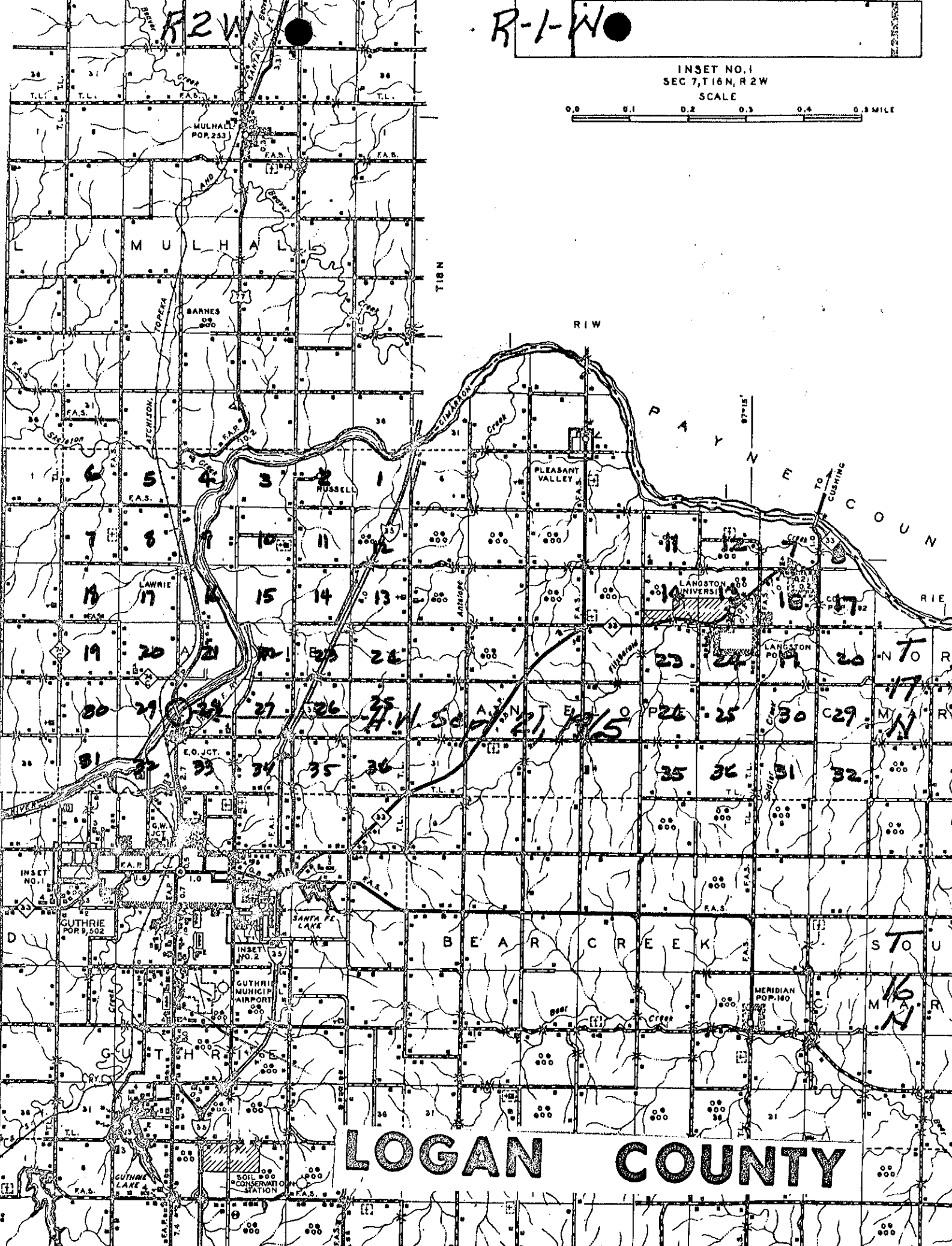

LOGAN COUNTY

Handwritten: A.W. Sect 21, P. 15

Handwritten: 16 N

INSET NO. 1

INSET NO. 2

GUTHRIE POP. 9,502

GUTHRIE MUNICIPAL AIRPORT

MERIDIAN POP. 180

SOIL CONSERVATION

MULHALL POP. 253

PLEASANT VALLEY

LANGSTON UNIVERSITY

LANGSTON POP. 100

RUSSELL

LAWRIE

BEAR CREEK

STOU

GUTHRIE

MERIDIAN

INSET NO. 1

INSET NO. 2

GUTHRIE POP. 9,502

GUTHRIE MUNICIPAL AIRPORT

MERIDIAN POP. 180

SOIL CONSERVATION

MULHALL POP. 253

PLEASANT VALLEY

LANGSTON UNIVERSITY

LANGSTON POP. 100

RUSSELL

LAWRIE

BEAR CREEK

STOU

GUTHRIE

MERIDIAN