

RECEIVED

DEC 6 1973

SURVEY DIVISION

STATE OF OKLAHOMA
DEPARTMENT OF HIGHWAYS
SURVEY DIVISION

Survey Division
Form No. 16
Rev. Sept. 10, 1961

FLOOD INFORMATION FORM

To be used in obtaining and transmitting flood water elevations for Survey Division office record files. This information to be obtained by all Chiefs of Party or others in their vicinity in times of unusual high water, or at any time available from a reliable source. The elevations can be recorded by level reading, by measurement from bridge floor, in relation to a house, above roadbed or any other dependable, clear manner that fits the situation, the highest order possible to be used. Separate report to be made on each crossing or place obtained.

County Logan Date highwater occurred October 11, 1973

Highway number U.S. 77 Name of stream Cimarron River

Direction and distance from nearest town, village or store _____
North of Guthrie.

Section, Township and Range Sec. 28 & 29 - 32 & 33, T-17-N, R-2-W.

Description of Location _____

Down 3.0 from the intersection of
Elevation Sec. 28 & 29 - 32 & 33 T17N Source of levels _____
R2W.

Method obtained Tunnel Level Date obtained October 18, 1973

Did it appear to be normal medium extreme do not know

Was highwater mark obtained from actual water, drift, local resident, U. S. Engineers, etc.? Actual water marks.

Explanatory Remarks _____

Location to be shown on back of this sheet as a check.

Field Note: To be sent to
Survey Engineer

Gene Provolt - Location Engineer
~~Chief of Party~~
October 18, 1973
Date

Location No. 10

P-2-W

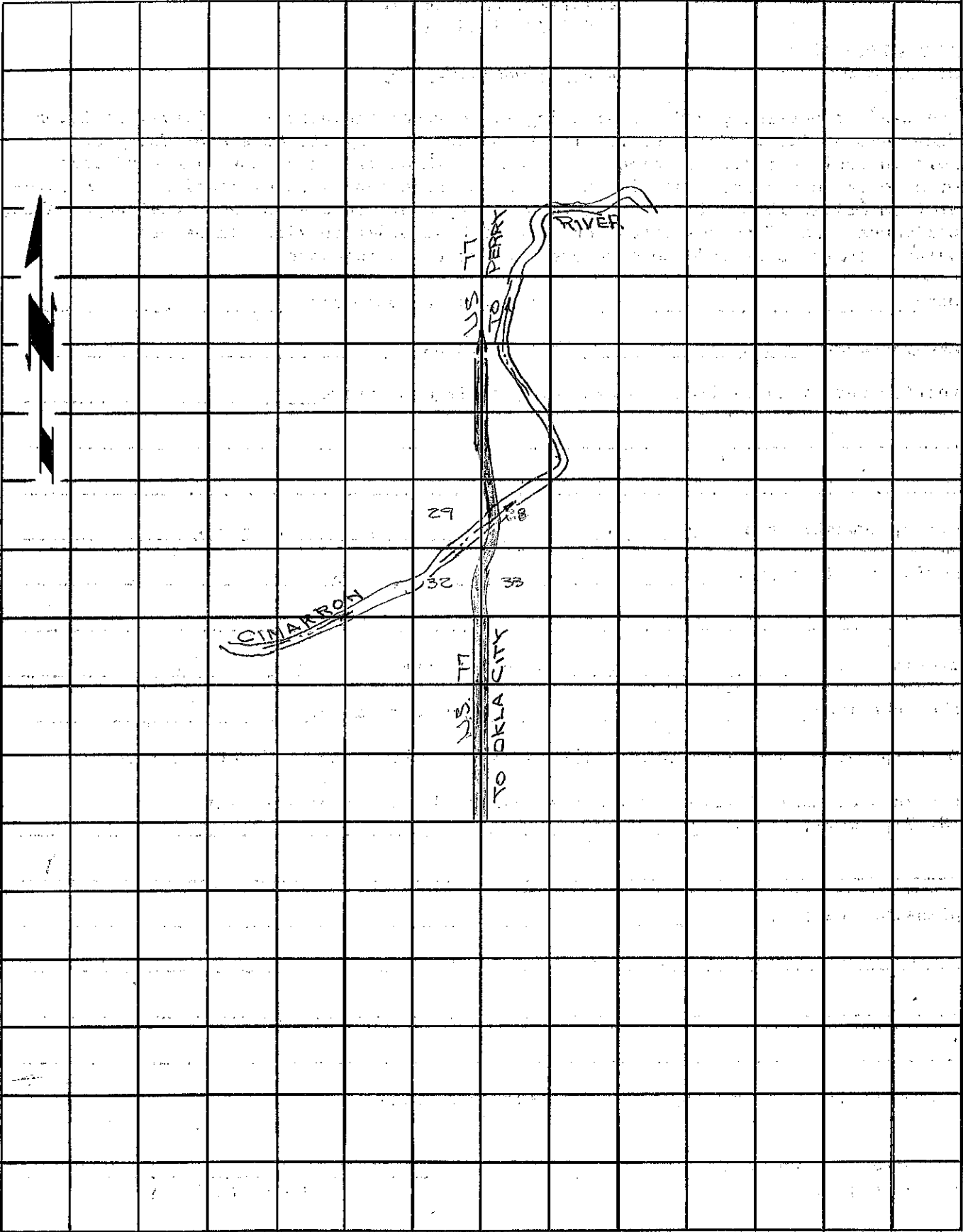

151

CIMARRON

FERRY

RIVER

TO OKLA CITY

29

32

33

38