

STATE OF OKLAHOMA
DEPARTMENT OF HIGHWAYS
SURVEY DIVISION

FLOOD INFORMATION FORM

To be used in obtaining and transmitting flood water elevations for Survey Division office record files. This information to be obtained by all Chiefs of Party or others in their vicinity in times of unusual high water, or at any time available from a reliable source. The elevations can be recorded by level reading, by measurement from bridge floor, in relation to a house, above roadbed or any other dependable, clear manner that fits the situation, the highest order possible to be used. Separate report to be made on each crossing or place obtained.

County LOGAN Date highwater occurred Sept. 21, 1965

Highway number SH 33 Name of stream Cimarron River

Direction and distance from nearest town, village or store Approx 0.9 miles North of Coyle on SH 33 at Cimarron River Bridge

Section, Township and Range Section 7, T17N. R1E

Description of Location At the S. End of River Bridge

Elevation Measured from Floor Br with Ruler Source of levels _____
Method obtained _____ Date obtained Sept. 23, 1965

Did it appear to be normal medium extreme do not know

Was highwater mark obtained from actual water, drift, local resident, U. S. Engineers, etc.?

Explanatory Remarks 9.0 Below Br. Floor at so. end of Cimarron River Bridge

Location to be shown on back of this sheet as a check.

Field Note: To be sent to
Survey Engineer

W. J. McLaughlin
Chief of Party
9/24/65
Date

LOCATION NO 15

R2W

R-1-W

INSET NO. 1
SEC 7, T16N, R2W
SCALE

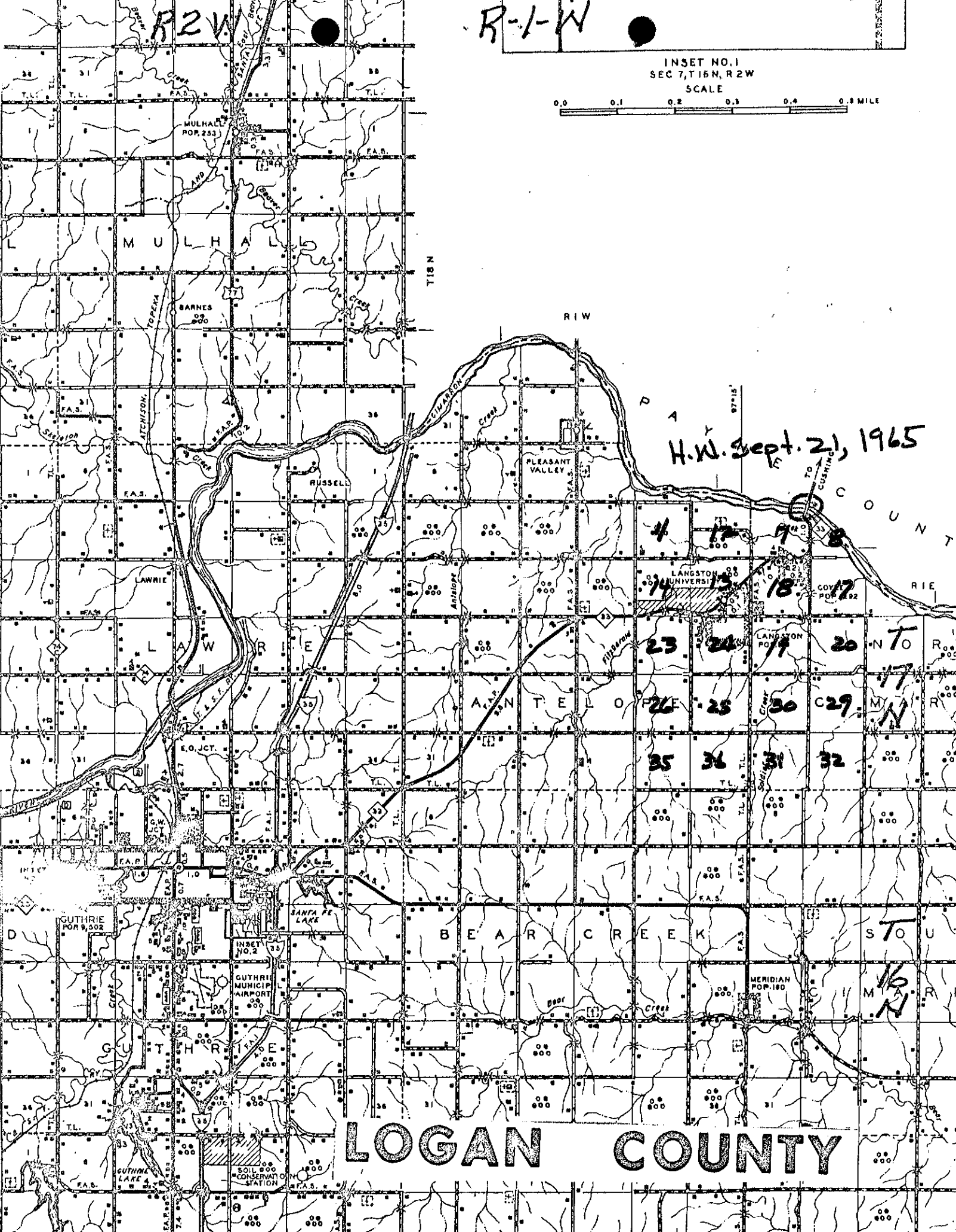
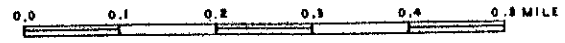

H.W. Sept. 21, 1965

LOGAN COUNTY