

RECEIVED

Plans & Survey Dept.
Form No. 16

JUN 27 1962 Rev. July 10, 1947

STATE OF OKLAHOMA
DEPARTMENT OF HIGHWAYS
PLANS AND SURVEY DEPARTMENT
SURVEY DIVISION

FLOOD INFORMATION FORM

To be used in obtaining and transmitting flood water elevations for Plans & Survey office record files. This information to be obtained by all Chiefs of Party in their vicinity in times of unusual high water, or at any time available from a reliable source. The elevations can be recorded by level reading, by measurement from bridge floor, in relation to a house, above roadbed or any other dependable, clear manner that fits the situation, the highest order possible to be used. Separate report to be made on each crossing or place obtained.

County Logan Date highwater occurred June 9, 1962

Highway number 33 Name of stream Cottonwood Creek

Direction and distance from nearest town, village or store in the City of Guthrie

Section, Township and Range Section 8, T 16 N, R 2 W

Description of Location Drift 5 feet below SW. Wingwall of Bridge

Method obtained _____

Elevation _____ Source of levels _____

Was highwater mark obtained from actual water, drift, local resident, U. S. Engineers, etc? Drift

Explanatory Remarks Top of drift was 5 feet below SW. wingwall of Bridge on Cottonwood Creek in the City of Guthrie on Highway 33.

Location to be shown on back of this sheet as a check.

Field Note: To be sent to Engr. of Plans & Survey (1 copy).
Office Note: To be filed in Flood Information by Counties.

R. P. Cartmill by Hancock
Chief of Party

6-22-62
Date

✓

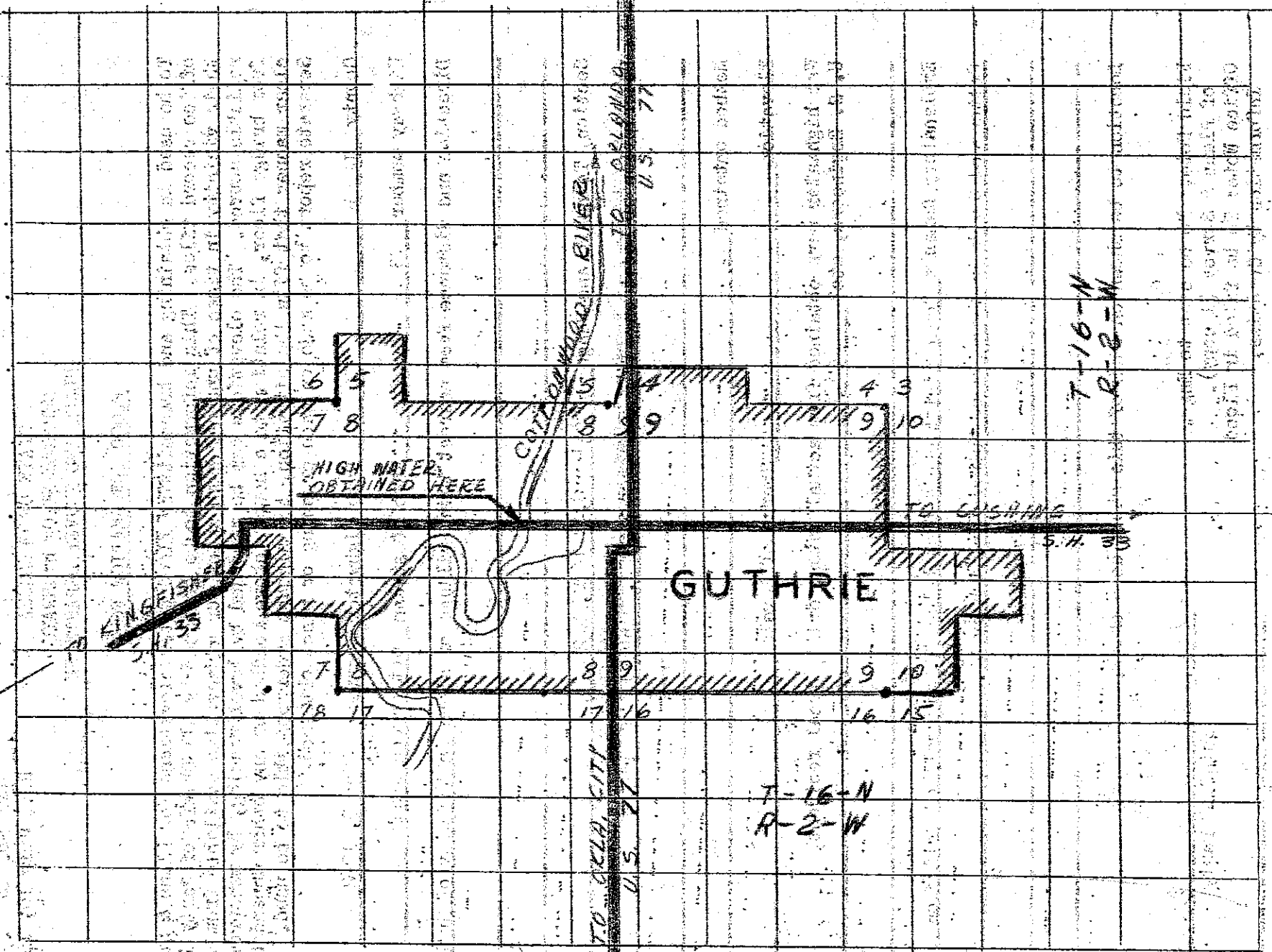

HIGH WATER
OBTAINED HERE

CATAWHA RIVER

KINGFISHER

GUTHRIE

TO CASHING

TO OKLAHOMA CITY
U.S. 77

T-16-N
R-2-W

T-16-N
R-2-W

7 8

6 5

8 9

8 9

9 10

4 3

7 8

18 17

17 16

16 15

S.H. 35