

STATE OF OKLAHOMA
DEPARTMENT OF HIGHWAYS
PLANS AND SURVEY DEPARTMENT

FLOOD INFORMATION FORM

To be used in obtaining and transmitting flood water elevations for Plans & Survey office record files. This information to be obtained by all Chiefs of Party in their vicinity in times of unusual high water, or at any time available from a reliable source. The elevations can be recorded by level reading, by measurement from bridge floor, in relation to a house, above roadbed or any other dependable, clear manner that fits the situation, the highest order possible to be used. Separate report to be made on each crossing or place obtained.

County Lincoln Date highwater occurred May 19, 1949

Highway number S.H. 66 Name of stream Captain Creek

Direction and distance from nearest town, village or store Captain Creek

Bridge just at the west edge of Wellston
on S.H. 66 - Pony steel truss Br

Section, Township and Range Sec 15-T14N-R2E

Description of Location At a bridge built at
Sta 180+ S.A.P. 827A.

Method obtained Wye level

Elevation 1.6 Lower than
Bridge Floor Source of levels _____

Was highwater mark obtained from actual water, drift, local resident,
U. S. Engineers, etc? Actual H.W. Mark on wing walls
of Bridge

Explanatory Remarks This is an extreme H.W.

This information was obtained by A.B. Stephens
and P.D. Clifton - Water went over pavement
south of this Bridge

Location to be shown on back of this sheet as a check.

Field Note: To be sent to Engr.
of Plans & Survey (1 copy).
Office Note: To be filed in Flood
Information by Counties.

A.B. Stephens
Chief of Party
Res Engineer
May 23, 1949
Date

LOCATION NO. 1

R2E

T
14
N

T
14
N

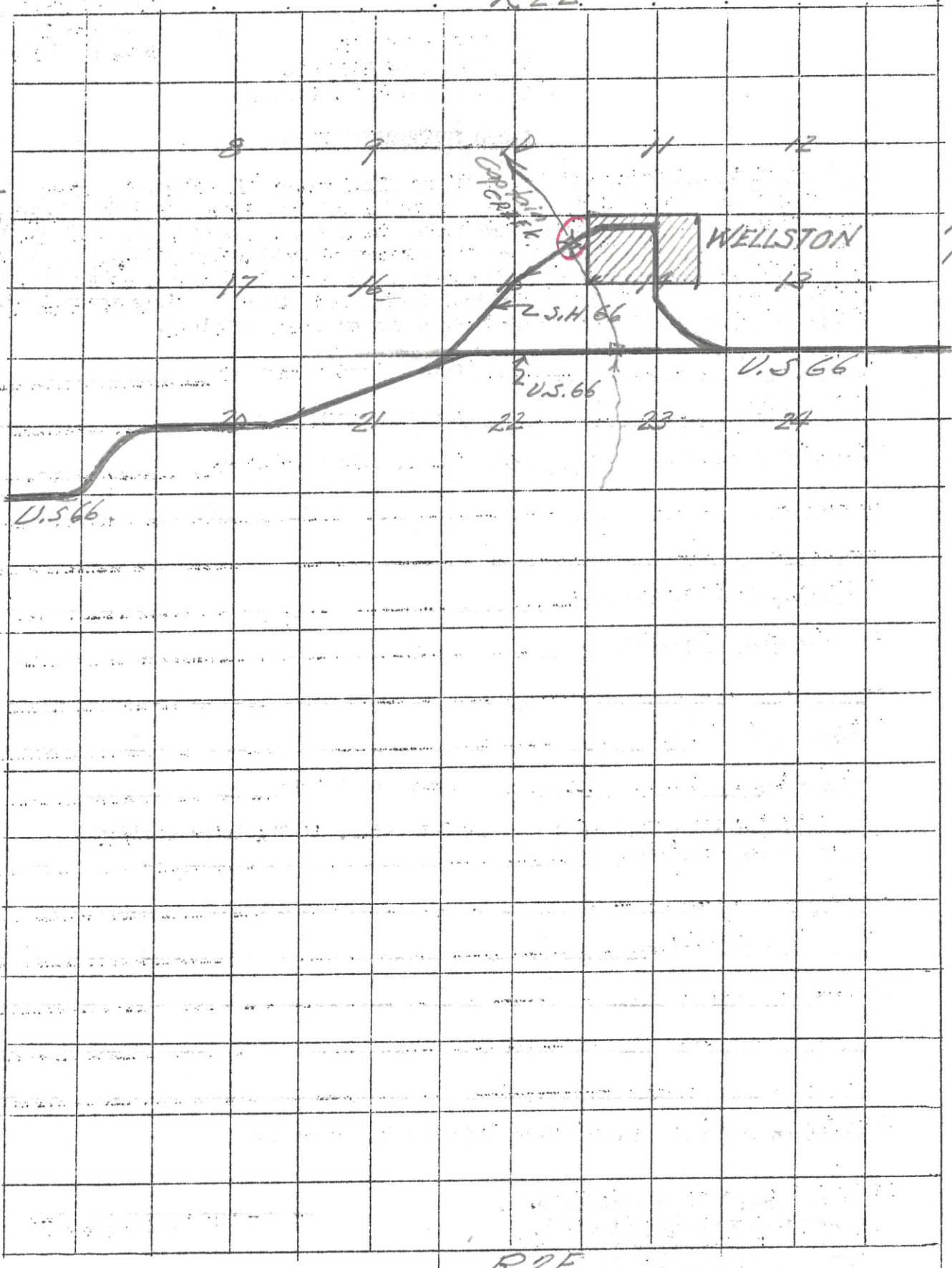

R2E