

STATE OF OKLAHOMA
DEPARTMENT OF HIGHWAYS
PLANS AND SURVEY DEPARTMENT

FLOOD INFORMATION FORM

To be used in obtaining and transmitting flood water elevations for Plans & Survey office record files. This information to be obtained by all Chiefs of Party in their vicinity in times of unusual high water, or at any time available from a reliable source. The elevations can be recorded by level reading, by measurement from bridge floor, in relation to a house, above roadbed or any other dependable, clear manner that fits the situation, the highest order possible to be used. Separate report to be made on each crossing or place obtained.

County Lincoln Date highwater occurred May 19, 1949

Highway number U.S. 66 Name of stream Possum Creek

Direction and distance from nearest town, village or store 1/2 Mile West of Warwick - 7 1/2 Miles West of Chandler

Section, Township and Range Sec 17 - T14N - R3E

Description of Location At Possum Creek Bridge

Sta 373+49.05 S.W.D. 1551(C). Built under FM 137C

Method obtained Wye Level

Elevation 844.0 Source of levels U.S.C.E.S. Taken from S.W.D. 1551(C)

Was highwater mark obtained from actual water, drift, local resident, U. S. Engineers, etc? Taken on actual mark by bridge

Explanatory Remarks Elev of Br. Floor = 842.64

This is an extreme H.W. This information was obtained by A.B. Stephens and D.D. Clifton

Location to be shown on back of this sheet as a check.

Field Note: To be sent to Engr.
of Plans & Survey (1 copy).
Office Note: To be filed in Flood
Information by Counties.

A.B. Stephens
Chief of Party
Resident Engineer
May 23, 1949
Date

LOCATION NO 2

R4E

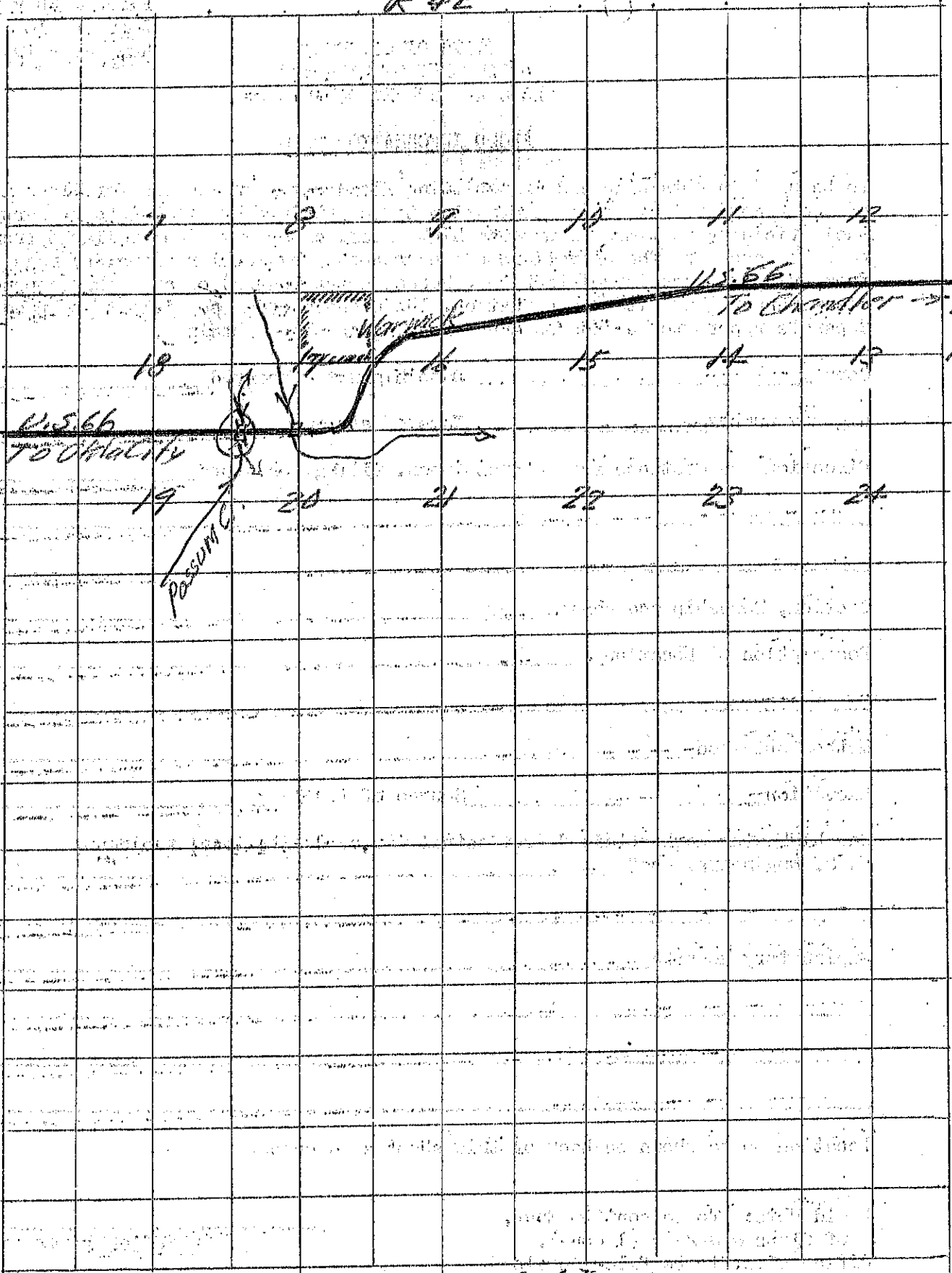

R4E