

SURVEY DIVISION	
✓ GHS	MAY 28 1968
✓ WWV	6-14-68
✓ WNM	6-17-68
✓ CWP	
✓ OCC	6-24-68
GER	
SDD	
RDA	
HFI	
GSS	

Survey Division  
Form No. 16  
Rev. Sept. 10, 1961

STATE OF OKLAHOMA  
DEPARTMENT OF HIGHWAYS  
SURVEY DIVISION

FLOOD INFORMATION FORM

To be used in obtaining and transmitting flood water elevations for Survey Division office record files. This information to be obtained by all Chiefs of Party or others in their vicinity in times of unusual high water, or at any time available from a reliable source. The elevations can be recorded by level reading, by measurement from bridge floor, in relation to a house, above roadbed or any other dependable, clear manner that fits the situation, the highest order possible to be used. Separate report to be made on each crossing or place obtained.

County LeFlore Date highwater occurred May 15, 1968

Highway number US 271 Name of stream Poteau River

Direction and distance from nearest town, village or store Approximately 7 miles east of Spiro, Oklahoma, and approximately 4 miles west of the Oklahoma-Arkansas State Line.

Section, Township and Range On East & West Section Line between Sec's 1 & 2, T-9-N, R-26-E.

Description of Location Hi-water elevation obtained at the east end of the present US 271 concrete and steel truss bridge in place.

Elevation 15.4 feet below BM (BM described below) Source of levels \_\_\_\_\_

Method obtained Measured down from bridge floor. Date obtained May 15, 1968

Did it appear to be  normal  medium  extreme  do not know

Was highwater mark obtained from actual water, drift, local resident, U. S. Engineers, etc.? Actual water elevation. Obtained by Moran and two members of this party.

Explanatory Remarks Water appeared to be at its peak elevation. The Poteau River at Poteau Oklahoma had subsided approximately 4 feet at the time this elevation on US 271 was obtained. Water did not overflow the present US 271 paving. 7.85 inches of rain fell in the Poteau, Oklahoma, area on May 13 & 14, 68 as measured by the rain guage at the State Highway Dept. Maintenance Office at Poteau.

BM = Centerline concrete bridge floor, east end bridge.

Location to be shown on back of this sheet as a check.

Field Note: To be sent to Survey Engineer

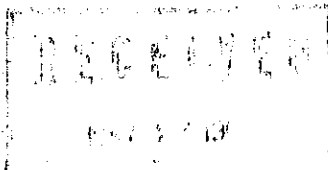

Russ Roy Moran  
Location Engineer  
May 24, 1968

Date

SND - #976  
Project - FAP  
Books Discarded  
84 (5)

LOCATION NO. 7

BM description?

R-26-E

R-27-E

T 10 N  
T 9 N

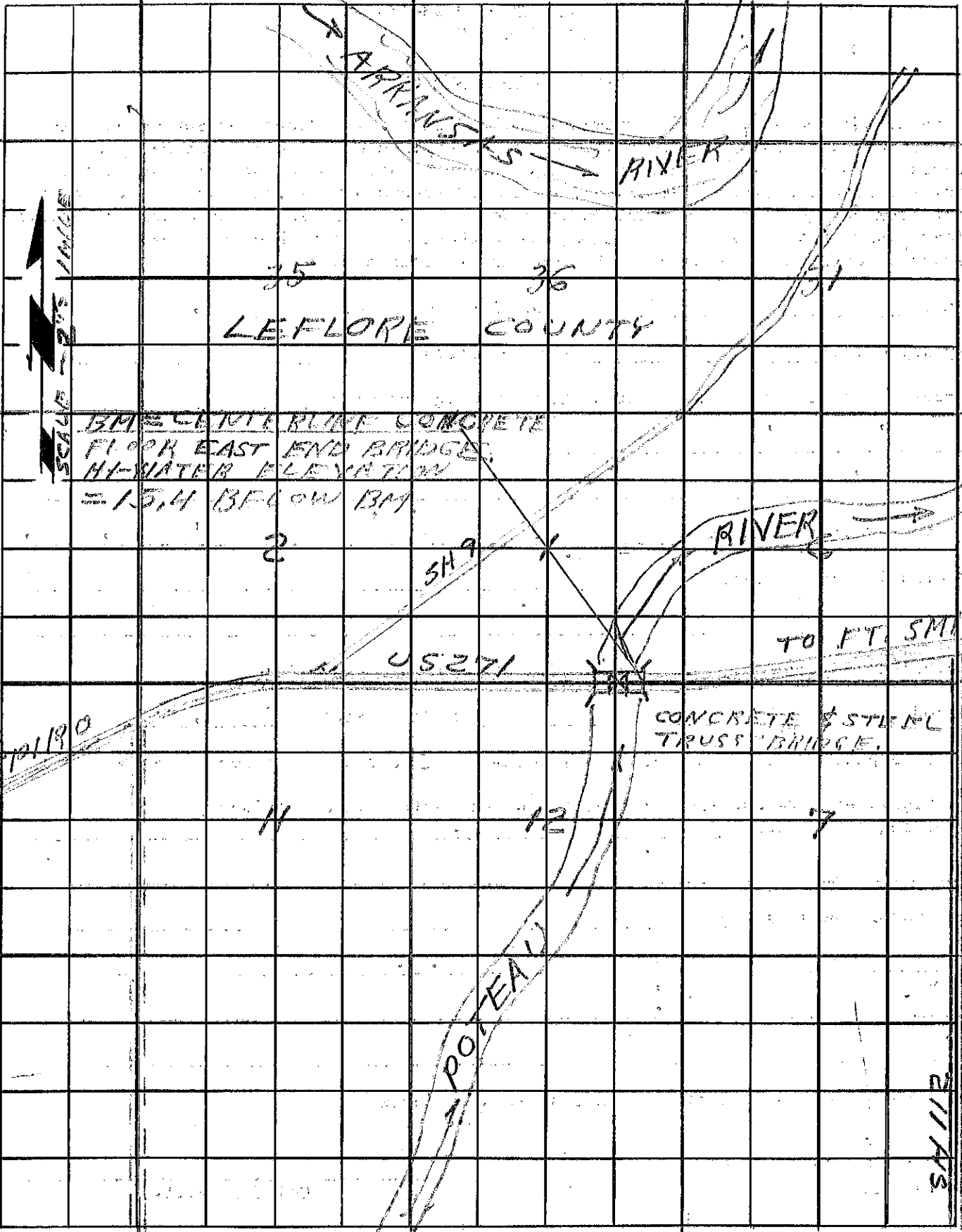

ARKANSAS RIVER

35 36 37  
LEFLORE COUNTY

B.M. CENTERLINE CONCRETE  
FLOOR EAST END BRIDGE.  
HI-WATER ELEVATION  
= 15.4 BELOW B.M.

RIVER

US 271

TO FT. SMITH ARK.

CONCRETE & STEEL  
TRUSS BRIDGE.

POTEAU RIVER

SH 11