

RECEIVED  
DEC 4 1986  
SURVEY DIVISION

Survey Division  
Form No. 16  
Rev. Dec. 2, 1974

STATE OF OKLAHOMA  
DEPARTMENT OF HIGHWAYS  
SURVEY DIVISION

FLOOD INFORMATION FORM

To be used in obtaining and transmitting flood water elevations for Survey Division office record files. This information to be obtained by all Chiefs of Party or others in their vicinity in times of unusual high water, or at any time available from a reliable source. The elevations can be recorded by level reading, by measurement from bridge floor, in relation to a house, above roadbed or any other dependable, clear manner that fits the situation, the highest order possible to be used. Separate report to be made on each crossing or place obtained.

County Leflore Date highwater occurred October 6, 1986

Highway number SH 9 & US 271 Name of stream Cedar Creek

Direction and distance from nearest town, village or store 0.6 mile northeast of Pocola, Okla

Section, Township and Range Section 5, T9N, R27E

Description of Location \_\_\_\_\_

Elevation \_\_\_\_\_ Source of levels \_\_\_\_\_

Method obtained Fennel Level Date obtained October 7, 1986

Did it appear to be  normal  medium  extreme  do not know

Was highwater mark obtained from actual water, drift, local resident, U. S. Engineers, etc.? Actual water marks and residue

Explanatory Remarks Water was 21.0 feet below top of curb (Hubguard) at the NE Corner of Cedar Creek Bridge.

Location to be shown on back of this sheet as a check.

Field Note: To be sent to  
Survey Engineer

James Wayne Rogers  
Location Engineer

October 9, 1986  
Date

LOCATION No. 8

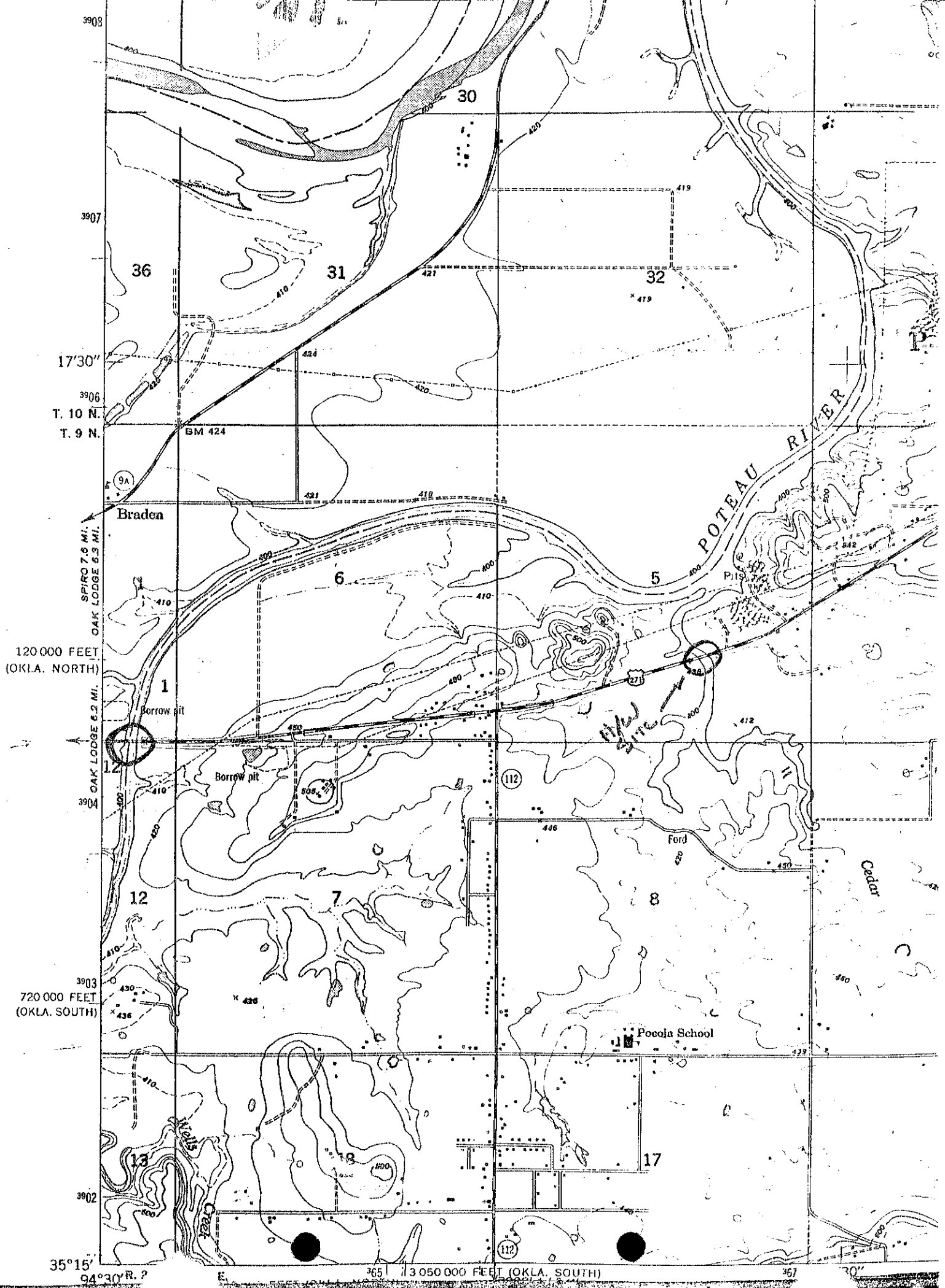

3908

3907

17°30"

3906

T. 10 N.

T. 9 N.

Braden

SPIRO 7.6 MI.  
OAK LODGE 6.2 MI.

120 000 FEET  
(OKLA. NORTH)

OAK LODGE 6.2 MI.

3904

720 000 FEET  
(OKLA. SOUTH)

3903

3902

35°15'

94°30' R. 2

30

36

31

32

6

5

1

12

7

8

Pocota School

17

Cedar

130 500 FEET (OKLA. SOUTH)