

SURVEY DIVISION	
✓ GHS	MAY 28 1968
✓ WWV	6-17-68
✓ WNM	6-17-68
✓ GWP	
✓ OCC	6-20-68
GER	
SDD	
RDA	
HFJ	
GSS	

RECEIVED
Survey Division
Form No. 16
MAY 27 1968
Rev. Sept. 10, 1961
SURVEY DIVISION

STATE OF OKLAHOMA
DEPARTMENT OF HIGHWAYS
SURVEY DIVISION

FLOOD INFORMATION FORM

To be used in obtaining and transmitting flood water elevations for Survey Division office record files. This information to be obtained by all Chiefs of Party or others in their vicinity in times of unusual high water, or at any time available from a reliable source. The elevations can be recorded by level reading, by measurement from bridge floor, in relation to a house, above roadbed or any other dependable, clear manner that fits the situation, the highest order possible to be used. Separate report to be made on each crossing or place obtained.

County DeFlore ✓ Date highwater occurred May 13, 1968

Highway number SH 31 Name of stream Wolf Creek

Direction and distance from nearest town, village or store 4.2 miles west of Bokoshe, Okla. on SH 31.

Section, Township and Range Sec. 15, T8N, R23E.

Description of Location Highwater is 9.2 below bridge floor.

Elevation _____ Source of levels _____

Method obtained Tape Measurement Date obtained May 15, 1968

Did it appear to be normal medium extreme do not know

Was highwater mark obtained from actual water, drift, local resident, U. S. Engineers, etc.? Actual water ✓

Explanatory Remarks _____

Location to be shown on back of this sheet as a check.

Field Note: To be sent to Survey Engineer

RAY N. SBBLEY *By JDM*
~~CHIEF OF PARTY~~
Location Engineer
May 21, 1967
Date

LOCATION NO. 18

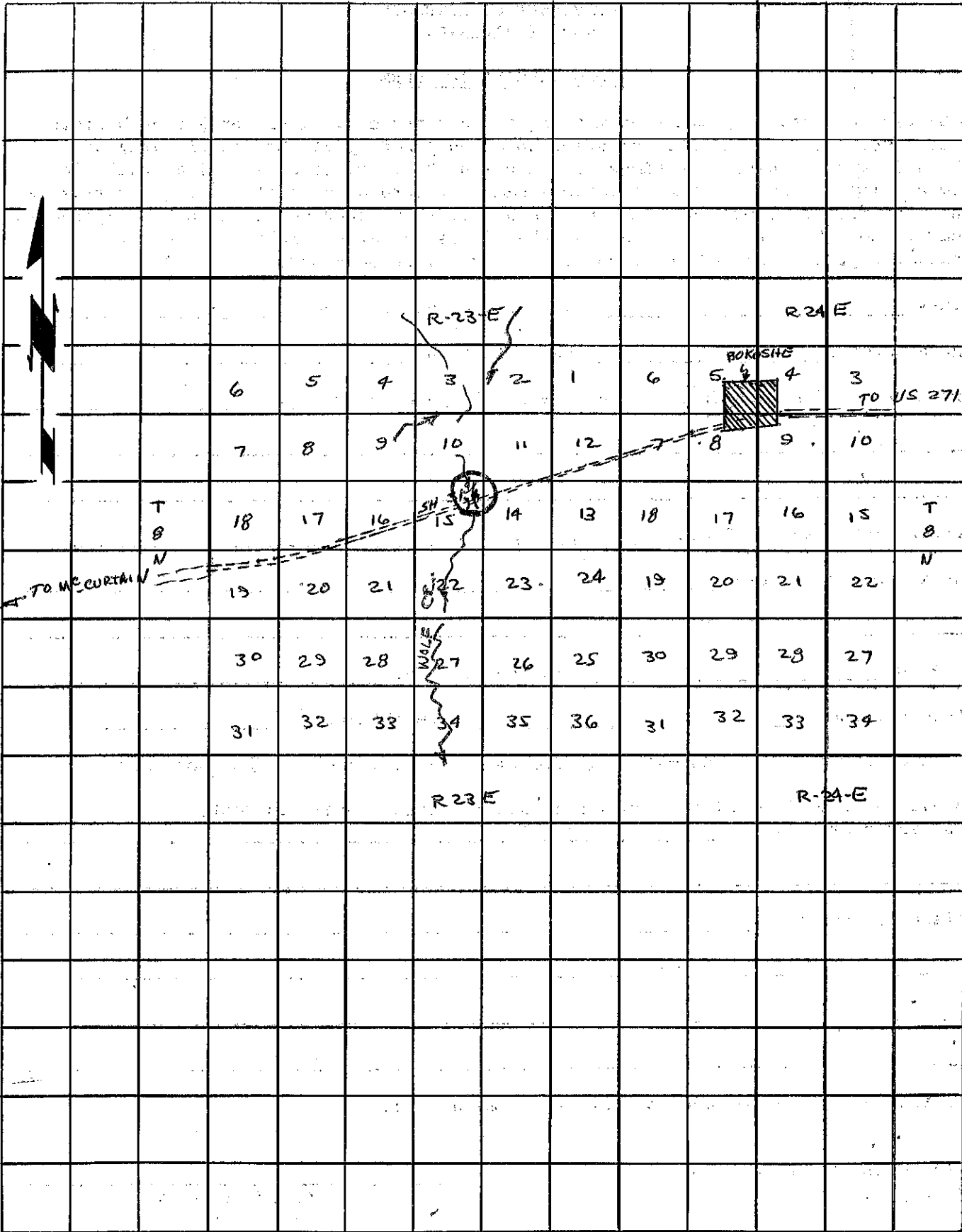

R-23 E

R-24 E

BOKOSHE

6 5 4 3 2 1 6 5 4 3

TO US 271

7 8 9 10 11 12 7 8 9 10

T
8
N

18 17 16 15 14 13 18 17 16 15

T
8
N

TO W. CURTAIN

19 20 21 22 23 24 19 20 21 22

30 29 28 27 26 25 30 29 28 27

31 32 33 34 35 36 31 32 33 34

R-23 E

R-24 E