



OKLAHOMA DEPARTMENT OF TRANSPORTATION
SURVEY DIVISION

FLOOD INFORMATION FORM

| | |
|--|--|
| Division #: | 1 <input type="checkbox"/> 2 X <input checked="" type="checkbox"/> 3 <input type="checkbox"/> 4 <input type="checkbox"/> 5 <input type="checkbox"/> 6 <input type="checkbox"/> 7 <input type="checkbox"/> 8 <input type="checkbox"/> |
| County: | Latimer |
| Date Highwater occurred: | 5/11/2015 |
| Highway Number: | SH 82 |
| Name of Stream: | Unknown |
| Direction and distance from nearest town, or highway junction | 0.6 miles south of Jct. of SH 82 & US 270 in Red Oak |
| Section, Township, Range: | Sec. 3, T-5-N,R-21-E |
| Description of Location: | NW/4 Sec. 3 |
| Highwater Elevation: | 582.9 |
| Level Datum & Source: | GPS OPUS Solution NAVD88 |
| Method used: | Leveled from GPS |
| Date Elevation Obtained: | 5/14 /2015 |
| Apparent Magnitude: | Normal <input type="checkbox"/> Medium <input type="checkbox"/> Extreme <input type="checkbox"/> Don't Know X <input checked="" type="checkbox"/> |
| Was Highwater Mark obtained from actual water, drift, local resident, or other source? | Highwater Elevation obtained from Latimer County Maintenance Personnel who observed highwater. |
| Explanatory Remarks: | |

Note: Show Vicinity Map on back of form

Name (signature) Keith Major
Name (Printed) Keith Major
Date:

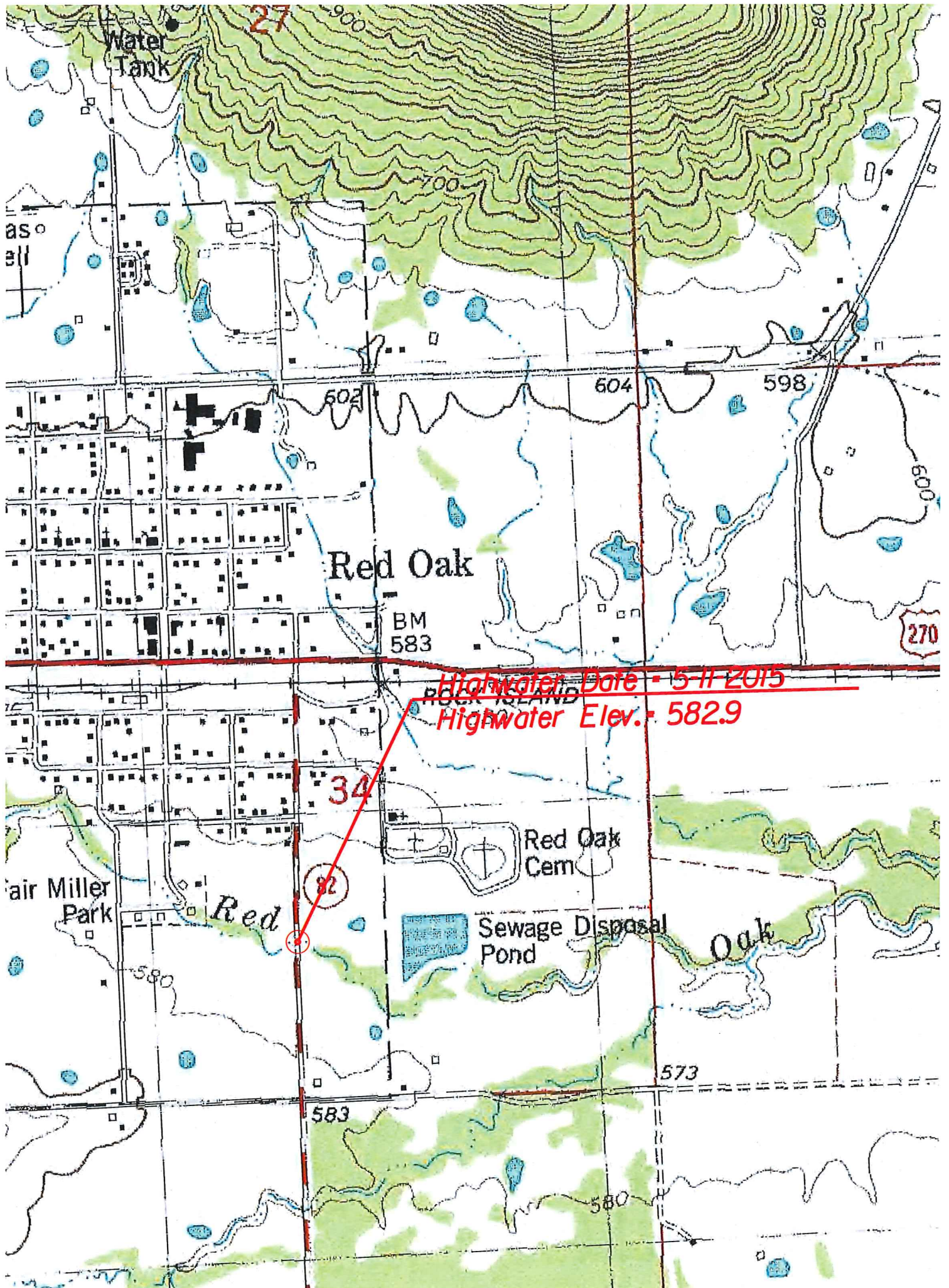

Water Tank

27

as
ell

Red Oak

BM
583

270

Highwater Date - 5-11-2015

Highwater Elev. - 582.9

34

Fair Miller
Park

Red

Red Oak
Cem

Sewage Disposal
Pond

Oak

580

573

583

580