

STATE OF OKLAHOMA
DEPARTMENT OF HIGHWAYS
SURVEY DIVISION

FLOOD INFORMATION FORM

To be used in obtaining and transmitting flood water elevations for Survey Division office record files. This information to be obtained by all Chiefs of Party or others in their vicinity in times of unusual high water, or at any time available from a reliable source. The elevations can be recorded by level reading, by measurement from bridge floor, in relation to a house, above roadbed or any other dependable, clear manner that fits the situation, the highest order possible to be used. Separate report to be made on each crossing or place obtained.

County Latimer Date highwater occurred April 24, 1966

Highway number US-270 Name of stream Gaines Creek

Direction and distance from nearest town, village or store 7 1/2 miles west of Wilburton on US-270

Section, Township and Range Sec. ¹⁹ 19, T5N, ~~R18E~~ R18E

Description of Location 7 1/2 miles west of Wilburton on US-270

Elevation 7.4 feet lower than bridge Source of levels floor.

Method obtained "Wye" level- 7.4 ft below Date obtained April 25, 1966
bridge floor. (drift on fence)

Did it appear to be normal medium extreme do not know

Was highwater mark obtained from actual water, drift, local resident, U. S. Engineers, etc.? drift on fence

Explanatory Remarks _____

Location to be shown on back of this sheet as a check.

RECEIVED	
SURVEY DIVISION	
CHS	
WWV	
WNM	5/2/66
GWP	
GER	
SDD	
HFJ	
DP	
CB	

Field Note: To be sent to
Survey Engineer

RECEIVED
MAY 2 1966
SURVEY DIVISION

Ray N. Seeley
Chief of Party
By: EM. Brown
April 25, 1966
Date

LOCATION NO. 1

RECORDED COPY
OF THE
1897

R18E

R19E

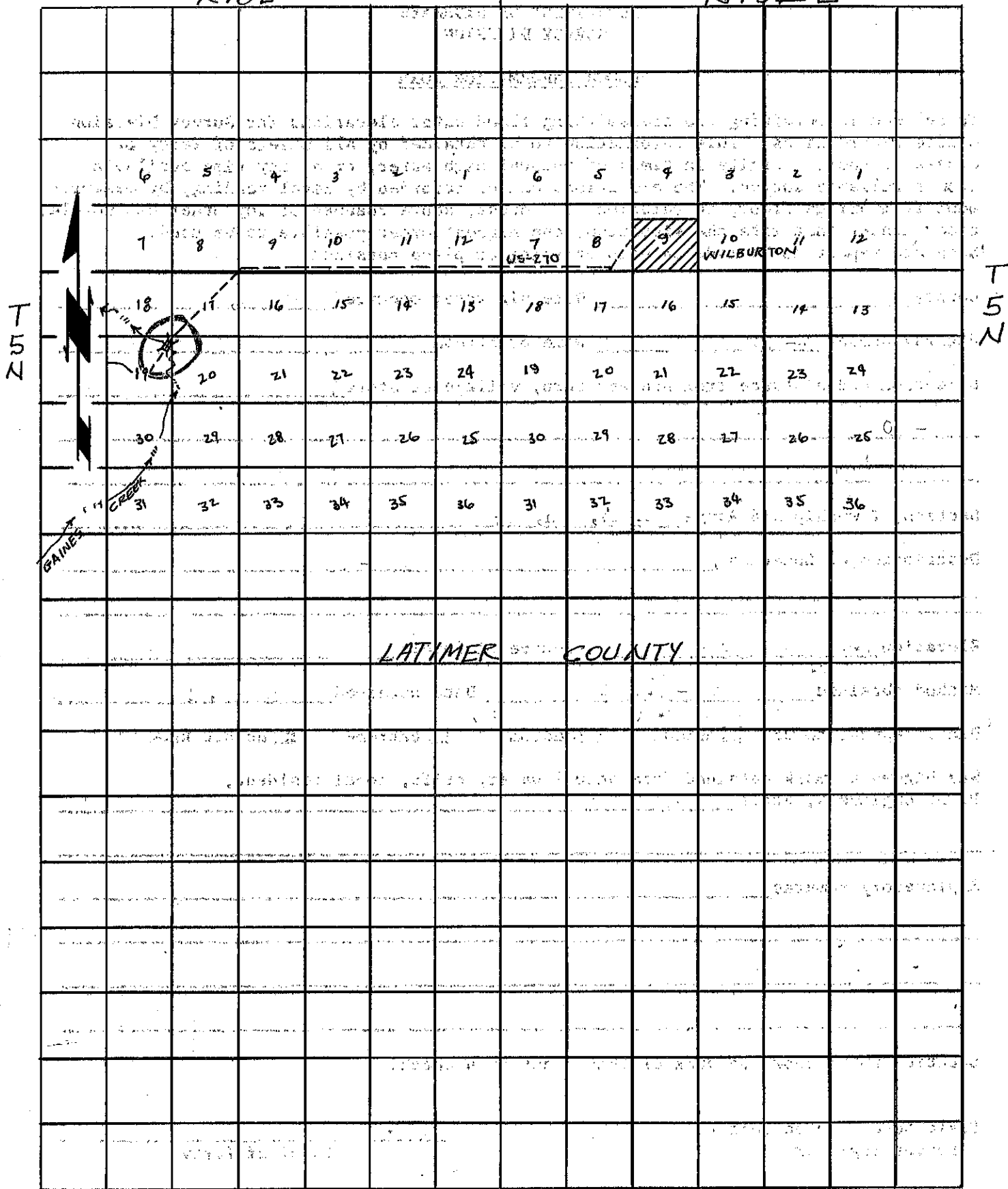

R18E

R19E