

STATE OF OKLAHOMA  
DEPARTMENT OF HIGHWAYS  
PLANS AND SURVEY DEPARTMENT

FLOOD INFORMATION FORM

To be used in obtaining and transmitting flood water elevations for Plans & Survey office record files. This information to be obtained by all Chiefs of Party in their vicinity in times of unusual high water, or at any time available from a reliable source. The elevations can be recorded by level reading, by measurement from bridge floor, in relation to a house, above roadbed or any other dependable, clear manner that fits the situation, the highest order possible to be used. Separate report to be made on each crossing or place obtained.

County LATIMER Date highwater occurred APRIL 29, 1953

Highway number U.S. 270 Name of stream FOURCHE MALINE

Direction and distance from nearest town, village or store \_\_\_\_\_

APPROX. 3.0 MILES EAST WILBURTON, OKLAHOMA

Section, Township and Range SECTION 12, T5N, R9E

Description of Location AT BRIDGE ON FOURCHE MALINE CREEK

Method obtained USED 6 FT FOLDING RULE - MEASURED FROM FLOOR BR. TO DRIFT,  
4.5 BELOW TOP FLOOR PRESENT BRIDGE

Elevation \_\_\_\_\_ Source of levels \_\_\_\_\_

Was highwater mark obtained from actual water, drift, local resident,  
U. S. Engineers, etc? DRIFT

Explanatory Remarks THIS IS NOT THE EXTREME HIGH WATER - BUT WAS  
A HIGH WATER MARK LEFT BY RECENT HEAVY RAINS.

Location to be shown on back of this sheet as a check.

Field Note: To be sent to Engr.  
of Plans & Survey (1 copy).  
Office Note: To be filed in Flood  
Information by Counties.

Nathan C. Ward  
Chief of Party

May 15th, 1953  
Date

# RISE

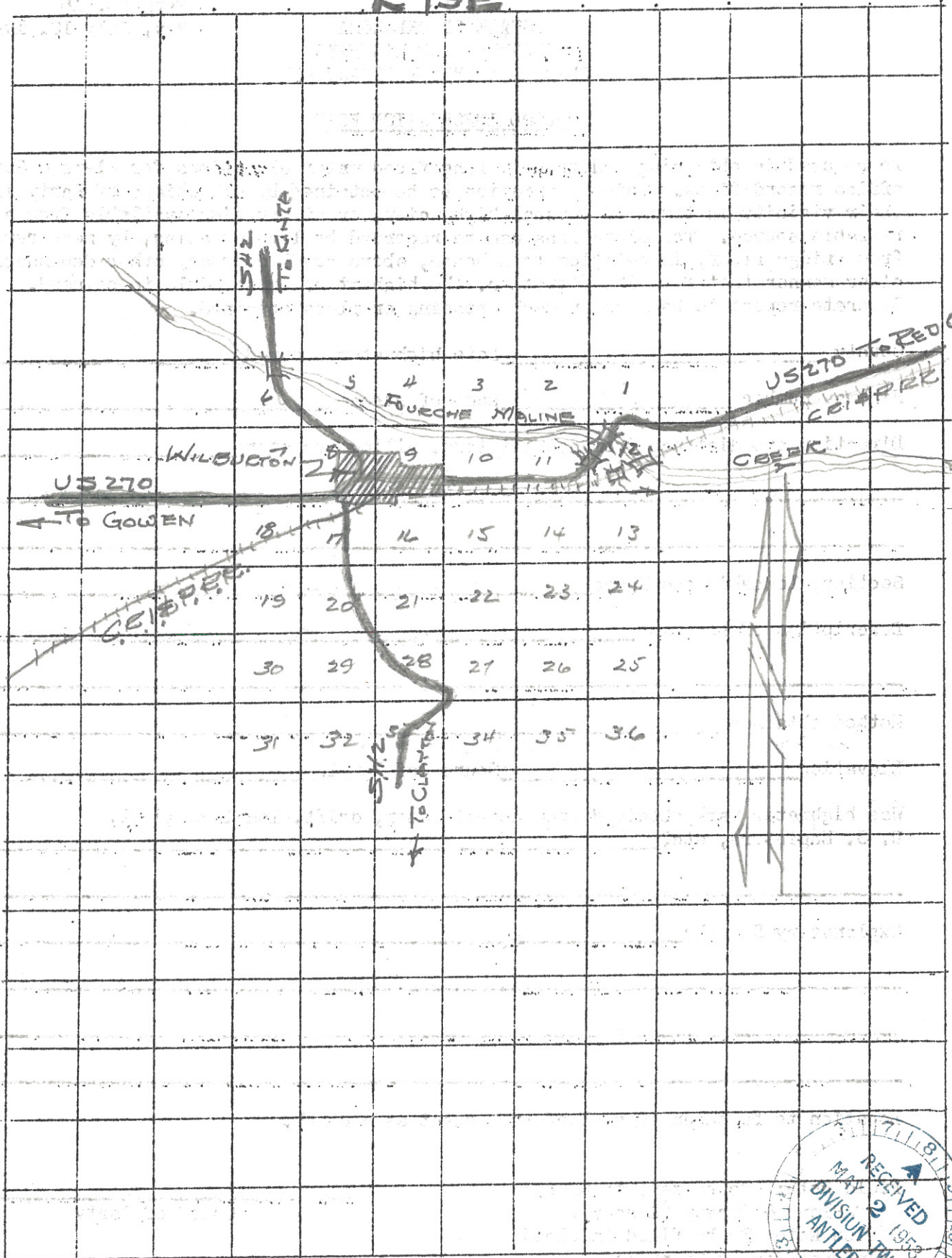

T 5 N

