

STATE OF OKLAHOMA
DEPARTMENT OF HIGHWAYS
SURVEY DIVISION

Form No. 16
Rev. Dec. 2, 1974

FLOOD INFORMATION FORM

To be used in obtaining and transmitting flood water elevations for Survey Division office record files. This information to be obtained by all Chiefs of Party or others in their vicinity in times of unusual high water, or at any time available from a reliable source. The elevations can be recorded by level reading, by measurement from bridge floor, in relation to a house, above roadbed or any other dependable, clear manner that fits the situation, the highest order possible to be used. Separate report to be made on each crossing or place obtained.

County KIOWA Date highwater occurred OCTOBER 2, 1986

Highway number S.H. 54 Name of stream DRAIN

Direction and distance from nearest town, village or store 1.4 MILES SOUTH OF GOTEBO,
OKLAHOMA.

Section, Township and Range BETWEEN SECTIONS 26 & 27, T-7-N, R-16-W

Description of Location 3.1' BELOW BRIDGE SEAT AT NORTH END OF BRIDGE.

Elevation 1387.7 Source of levels S.A.P. NO. 1075(4) S.H. 54 PLANS

Method obtained HAND LEVEL Date obtained OCTOBER 6, 1986

Did it appear to be normal medium extreme do not know

Was highwater mark obtained from actual water, drift, local resident,
U. S. Engineers, etc.? DRIFT AND WATER MARKS.

Explanatory Remarks MEDIUM HIGHWATER OCCURRED AFTER 10" RAINS OVER 3 DAY PERIOD.

Location to be shown on back of this sheet as a check.

Field Note: To be sent to
Survey Engineer

Bruce A. Laffey
TRANS. SPECIALIST 11-8

OCTOBER 8, 1986

Date

LOCATION No. 12

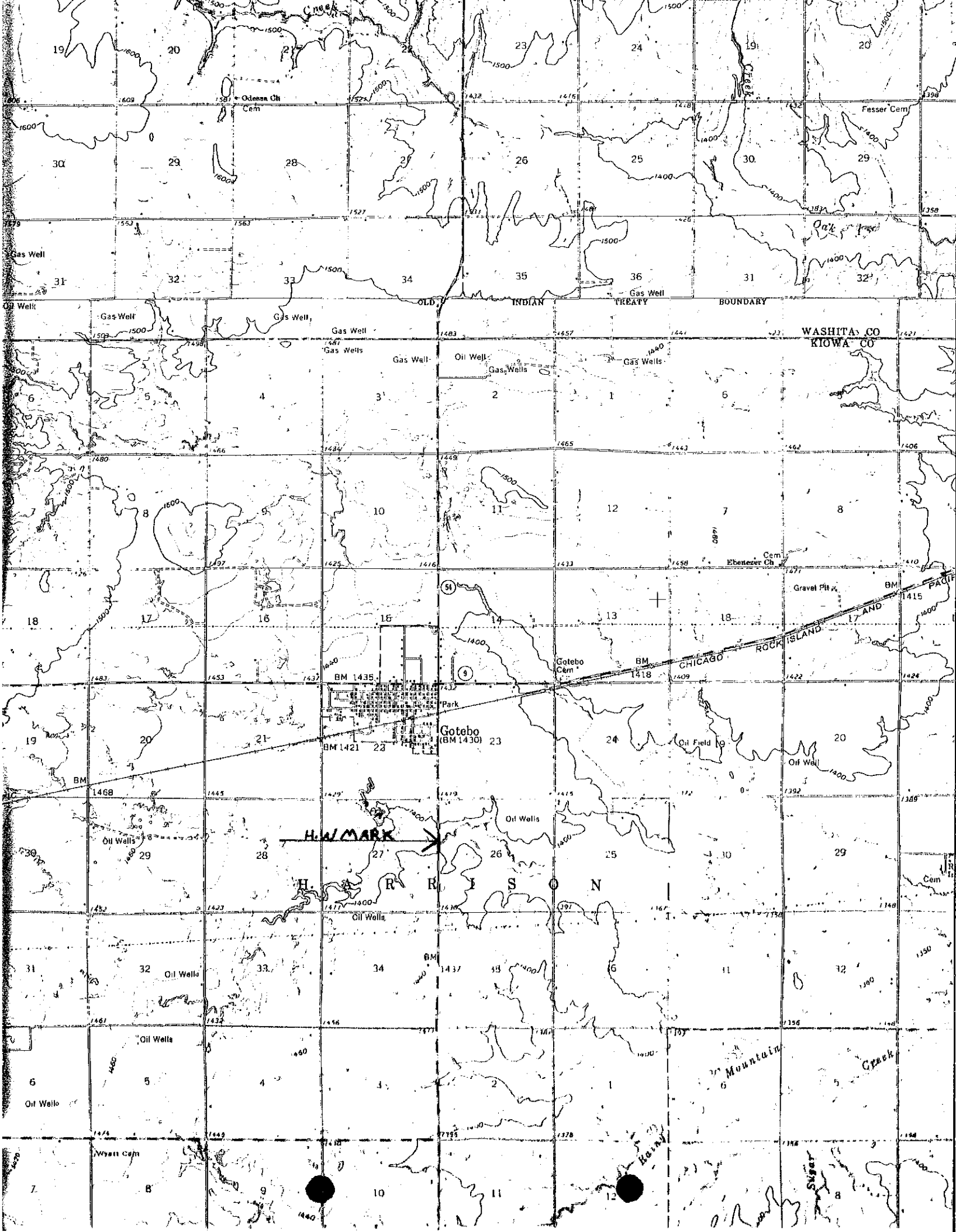

WASHINGTON CO
KIOWA CO

OLD INDIAN TREATY BOUNDARY

H.W. MARK

Gotebo
(BM 1430)

CHICAGO
ROCK ISLAND

HARRISON

Mountain
Creek

Sugar
Creek

