

STATE OF OKLAHOMA
DEPARTMENT OF HIGHWAYS
SURVEY DIVISION

FLOOD INFORMATION FORM

To be used in obtaining and transmitting flood water elevations for Survey Division office record files. This information to be obtained by all Chiefs of Party or others in their vicinity in times of unusual high water, or at any time available from a reliable source. The elevations can be recorded by level reading, by measurement from bridge floor, in relation to a house, above roadbed or any other dependable, clear manner that fits the situation, the highest order possible to be used. Separate report to be made on each crossing or place obtained.

County Kiowa Date highwater occurred 9/17/65

Highway number S.H. 115 Name of stream Washita River

Direction and distance from nearest town, village or store 3/4 mile north of Mt. View
on S.H. 115

Section, Township and Range Section 2, T7N R15W

Description of Location Bridge over Washita River on S.H. 115, 3/4 mile north of Mt. View.

Elevation 1324.8 Source of levels USC&GS - FAS # S-324(8)(9)S plans

Method obtained With wye level & Philadelphia rod Date obtained 9/29/65

Did it appear to be normal medium extreme do not know

Was highwater mark obtained from actual water, drift, local resident, U. S. Engineers, etc.? Taken from drift at east end of bridge

Explanatory Remarks This This information was obtained by A. W. Ziegelgruber and B. D. Roden. Highwater was caused from a reported 8 to 12 inch rain in approx. 12 hours.

Location to be shown on back of this sheet as a check.

Field Note: To be sent to
Survey Engineer

A. W. Ziegelgruber
~~Chief of Party~~ Chief of Party
~~Location Engineer~~
December 20, 1965
Date

Mc

Location No. 19

R15 W

R14 W

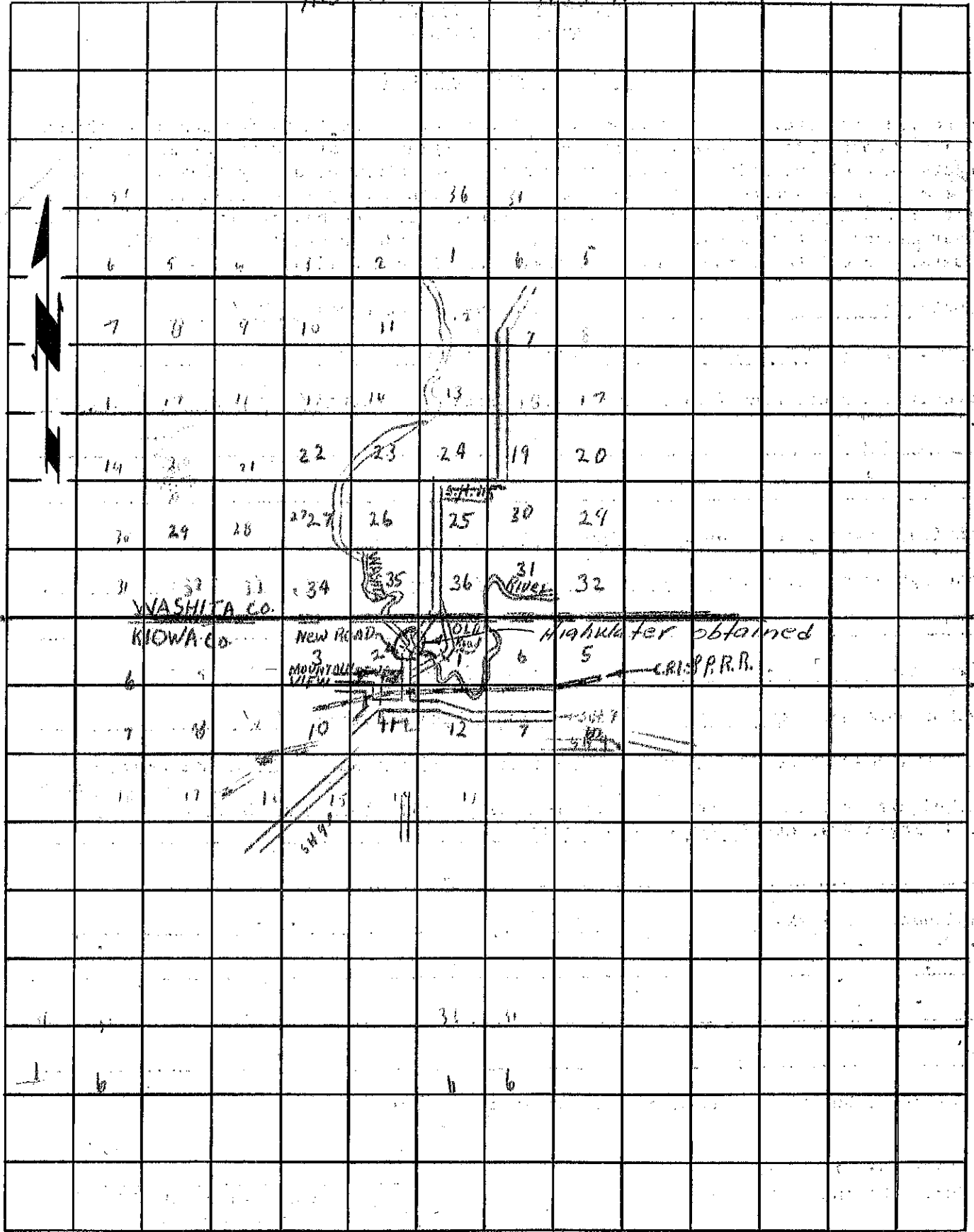

R15 W

R14 W