

Survey Division  
Form No. 16  
Rev. Sept. 10, 1961

STATE OF OKLAHOMA  
DEPARTMENT OF HIGHWAYS  
SURVEY DIVISION

FLOOD INFORMATION FORM

To be used in obtaining and transmitting flood water elevations for Survey Division office record files. This information to be obtained by all Chiefs of Party or others in their vicinity in times of unusual high water, or at any time available from a reliable source. The elevations can be recorded by level reading, by measurement from bridge floor, in relation to a house, above roadbed or any other dependable, clear manner that fits the situation, the highest order possible to be used. Separate report to be made on each crossing or place obtained.

County KIOWA Date highwater occurred 10-20-83

Highway number US 183 Name of stream WEST OTTER CREEK

Direction and distance from nearest town, village or store APPROX. 1.5 MILES NORTH OF JCT. US 183 & SH 19 AT ROOSEVELT

Section, Township and Range SEC. 30, T5N, R17W

Description of Location AT CONC. CULVT. APPROX 500 FT. SOUTH OF WEST OTTER CREEK BRIDGE

Elevation 1470.6 Source of levels USC&GS NRH 247 B PLANS

Method obtained Y-LEVEL Date obtained 10-26-83

Did it appear to be  normal  medium  extreme  do not know

Was highwater mark obtained from actual water, drift, local resident, U. S. Engineers, etc.? ACTUAL WATER MARK

Explanatory Remarks \_\_\_\_\_

Location to be shown on back of this sheet as a check.

Field Note: To be sent to  
Survey Engineer

Bobby Earl Goodland  
Chief of Party

Copy to Bridge 12-13-83  
A2

NOV. 17, 1983  
Date

LOCATION No. 26

WEST OTTER  
CREEK.

EW 149

EW 149

COO  
EW 155

COO  
EW 155

JACKSON

COMANCHE

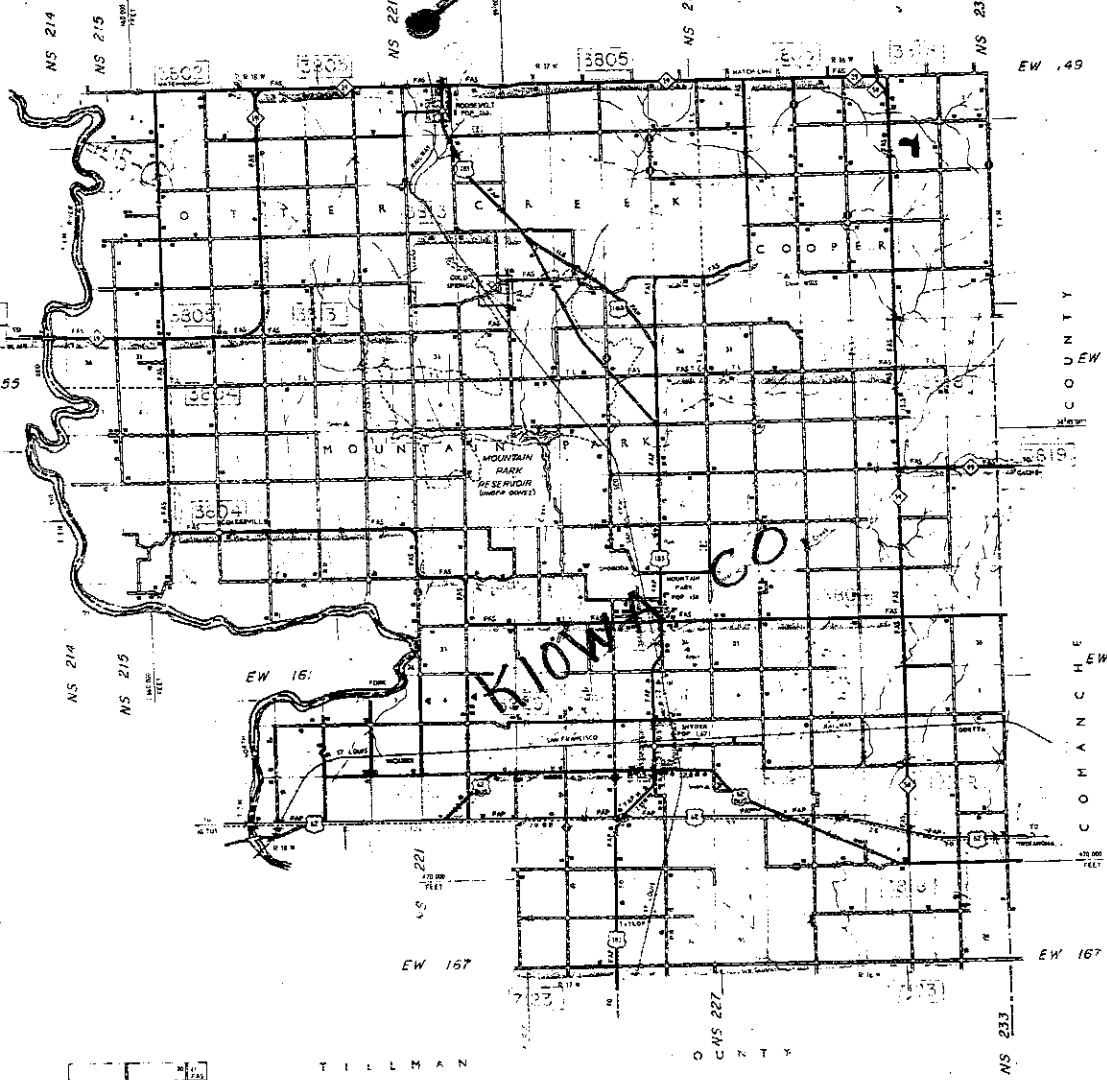

BLOUNT CO



TILLMAN

OKLAHOMA

NS 233

EW 167