

**OKLAHOMA DEPARTMENT OF TRANSPORTATION  
SURVEY DIVISION**

**FLOOD INFORMATION FORM**

<b>Division #:</b>	1 <input type="checkbox"/> 2 <input type="checkbox"/> 3 <input type="checkbox"/> 4 <input type="checkbox"/> 5 <input checked="" type="checkbox"/> 6 <input type="checkbox"/> 7 <input type="checkbox"/> 8 <input type="checkbox"/>
<b>County:</b>	Kiowa
<b>Date Highwater occurred:</b>	8/18/2007
<b>Highway Number:</b>	S.H. 115
<b>Name of Stream:</b>	
<b>Direction and distance from nearest town, or highway junction</b>	2.95 miles South of Jct. SH9 & SH115 by Mountain View. Sta. 394+35.5 5x2 RCB
<b>Section, Township, Range:</b>	Between Sec. 25, T-7-N, R-15-W & Sec. 30, T-7-N, R-14-W
<b>Description of Location:</b>	1.3' above centerline at Str.
<b>Highwater Elevation:</b>	1387.81
<b>Level Datum &amp; Source:</b>	F.A.S.P. No. S-442(1)
<b>Method used:</b>	Level
<b>Date Elevation Obtained:</b>	8/27/2007
<b>Apparent Magnitude:</b>	Normal <input type="checkbox"/> Medium <input type="checkbox"/> Extreme <input checked="" type="checkbox"/> Don't Know <input type="checkbox"/>
<b>Was Highwater Mark obtained from actual water, drift, local resident, or other source?</b>	drift
<b>Explanatory Remarks:</b>	After 10" overnight rain.

Note: Show Vicinity Map on back of form

Name (signature) Daryl Williams  
 Name (Printed) Daryl Williams  
 Date: August 30, 2007

NS227

8

9

0

1

2

NS233

4

5

6

7

8

NS239

0

1

2

3

4

NS245

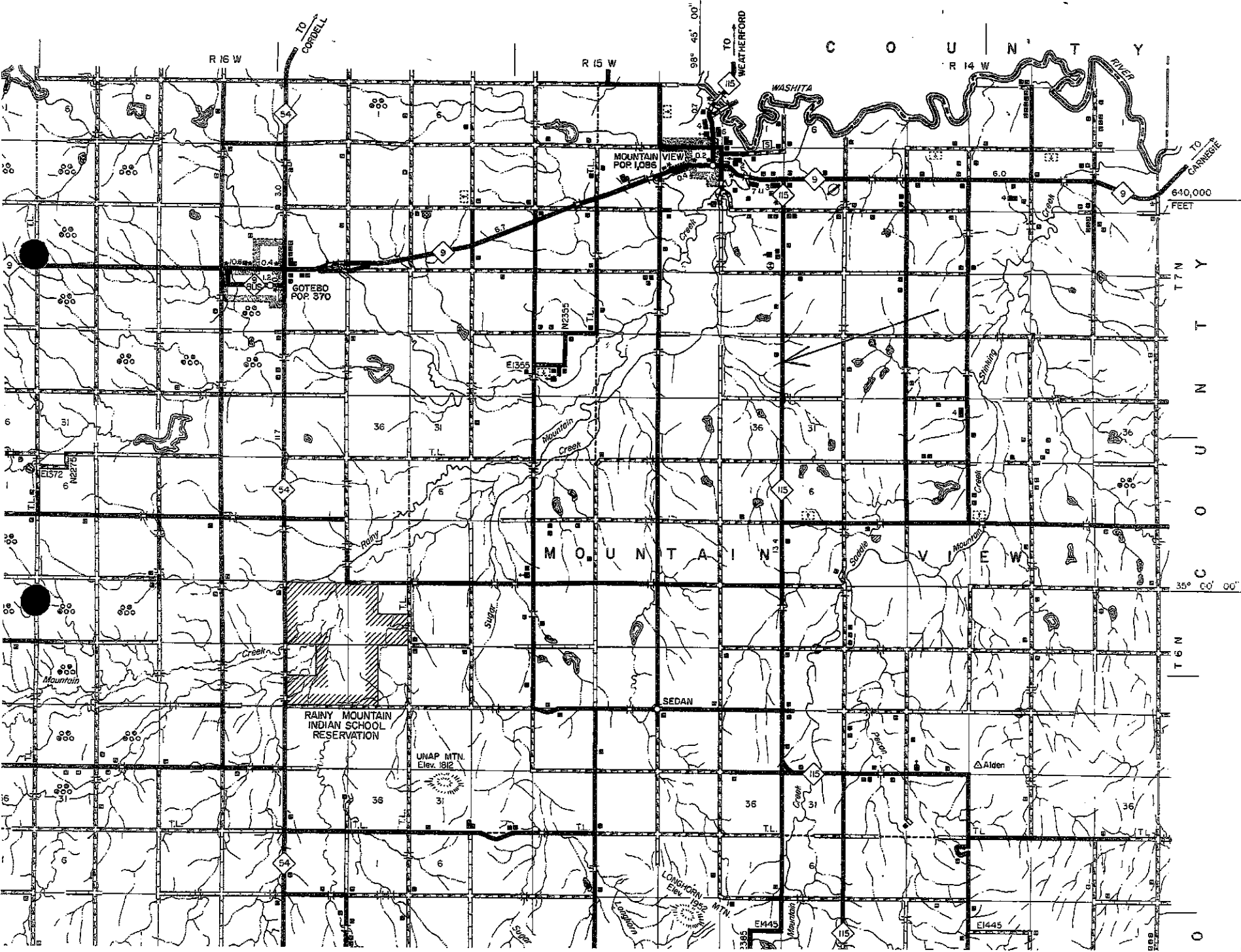

T7N  
T6N  
C O U N T Y

T6N

0