

STATE OF OKLAHOMA
DEPARTMENT OF HIGHWAYS
SURVEY DIVISION

FLOOD INFORMATION FORM

To be used in obtaining and transmitting flood water elevations for Survey Division office record files. This information to be obtained by all Chiefs of Party or others in their vicinity in times of unusual high water, or at any time available from a reliable source. The elevations can be recorded by level reading, by measurement from bridge floor, in relation to a house, above roadbed or any other dependable, clear manner that fits the situation, the highest order possible to be used. Separate report to be made on each crossing or place obtained.

County Kingfisher Date highwater occurred May 10, 1964

Highway number: SH 33 Name of stream Kingfisher Creek

Direction and distance from nearest town, village or store 4.0 miles
West along SH 33 from Kingfisher at the
Bridge over Kingfisher Creek

Section, Township and Range Section 13 T 16 N R 8 W

Description of Location Bridge over Kingfisher Creek.

Elevation _____ Source of levels 1.1 Below Br. Seat

Method obtained Measured with Ruler
from Br. Seat Date obtained 5-11-64

Did it appear to be normal medium extreme do not know

Was highwater mark obtained from actual water, drift, local resident, U. S. Engineers, etc.?

Well Defined Silt Marks.

Explanatory Remarks Obtained by W. D. Laughlin and
Gaines # Stout on May 11, 1964 from
Silt marks

Location to be shown on back of this sheet as a check.

Field Note: To be sent to
Survey Engineer

W. D. Laughlin
Chief of Party
5-11-64
Date

Location No. 1

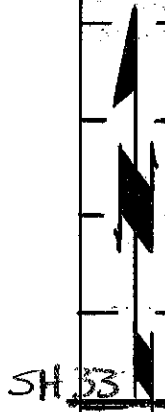

SH 33

SH 33

T
16
X

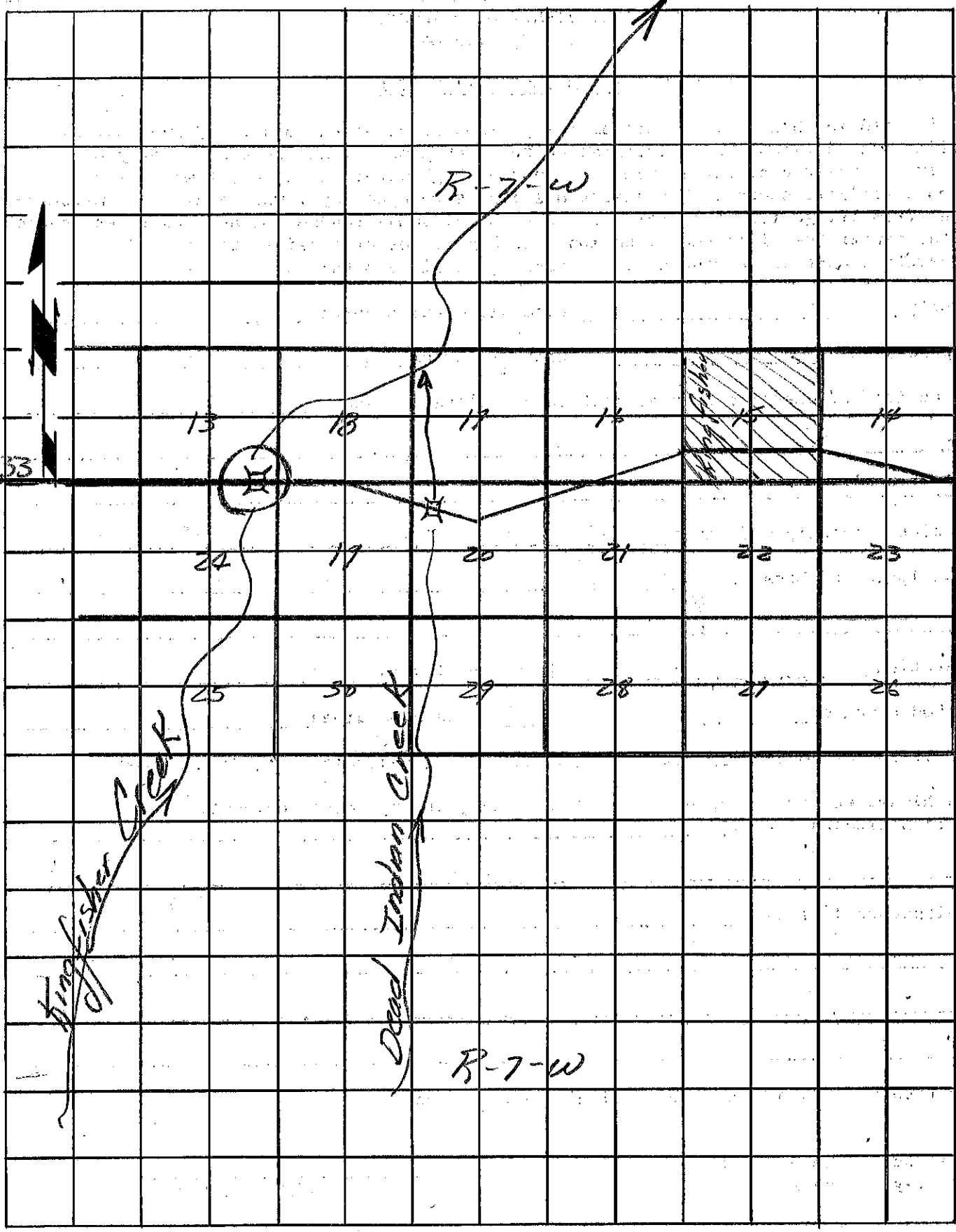

R-7-W

R-7-W

Kingfisher Creek

Dead Indian Creek

13

18

19

14

14

24

19

20

21

22

23

25

20

29

28

27

26