

H.W. INFO. IN RED OBTAINED BY VAUGHAN & CURNITT
9/14/61

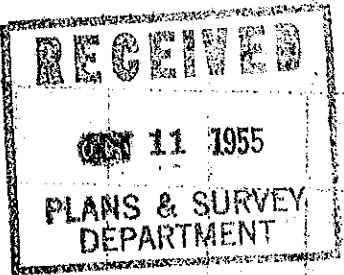

Plans & Survey Dept.
Form No. 16
Rev. July 10, 1947

STATE OF OKLAHOMA
DEPARTMENT OF HIGHWAYS
PLANS AND SURVEY DEPARTMENT

FLOOD INFORMATION FORM

To be used in obtaining and transmitting flood water elevations for Plans & Survey office record files. This information to be obtained by all Chiefs of Party in their vicinity in times of unusual high water, or at any time available from a reliable source. The elevations can be recorded by level reading, by measurement from bridge floor, in relation to a house, above roadbed or any other dependable, clear manner that fits the situation, the highest order possible to be used. Separate report to be made on each crossing or place obtained.

County Kingfisher Date highwater occurred SEPT. 13, 1961
OCT. 4, 1955

Highway number SH 33 Name of stream Kingfisher Creek

Direction and distance from nearest town, village or store 4.0 miles
West along SH. 33 From Kingfisher at the
Bridge over Kingfisher Creek

Section, Township and Range SECTION 13 T 16 N R 8 W

Description of Location H.W. 9-13-61 2.2 Below Br. Floor
SEPT. 13, 1961 by Curnitt + Vaughan 9/14/61 Silt Marks on Br.

Method obtained LEVEL

Elevation OCT. 4, 1961 3.6 FT Below Floor
Source of levels OF BRIDGE.

Was highwater mark obtained from actual water, drift, local resident, U. S. Engineers, etc? DRIFT & SILT.

WELL DEFINED SILT MARKS.

Explanatory Remarks obtained by W.N. McLaughlin on
Oct 10, from SILT & DRIFT.

Location to be shown on back of this sheet as a check.

Field Note: To be sent to Engr.
of Plans & Survey (1 copy).
Office Note: To be filed in Flood
Information by Counties.

W.N. McLaughlin
Chief of Party
10-10-55
Date

Location No. 1

SEPT. 13, 1961. H.W. 2.2' BELOW BRIDGE FLOOR
OCT. 4, 1961. H.W. 3.6' BELOW BRIDGE FLOOR.

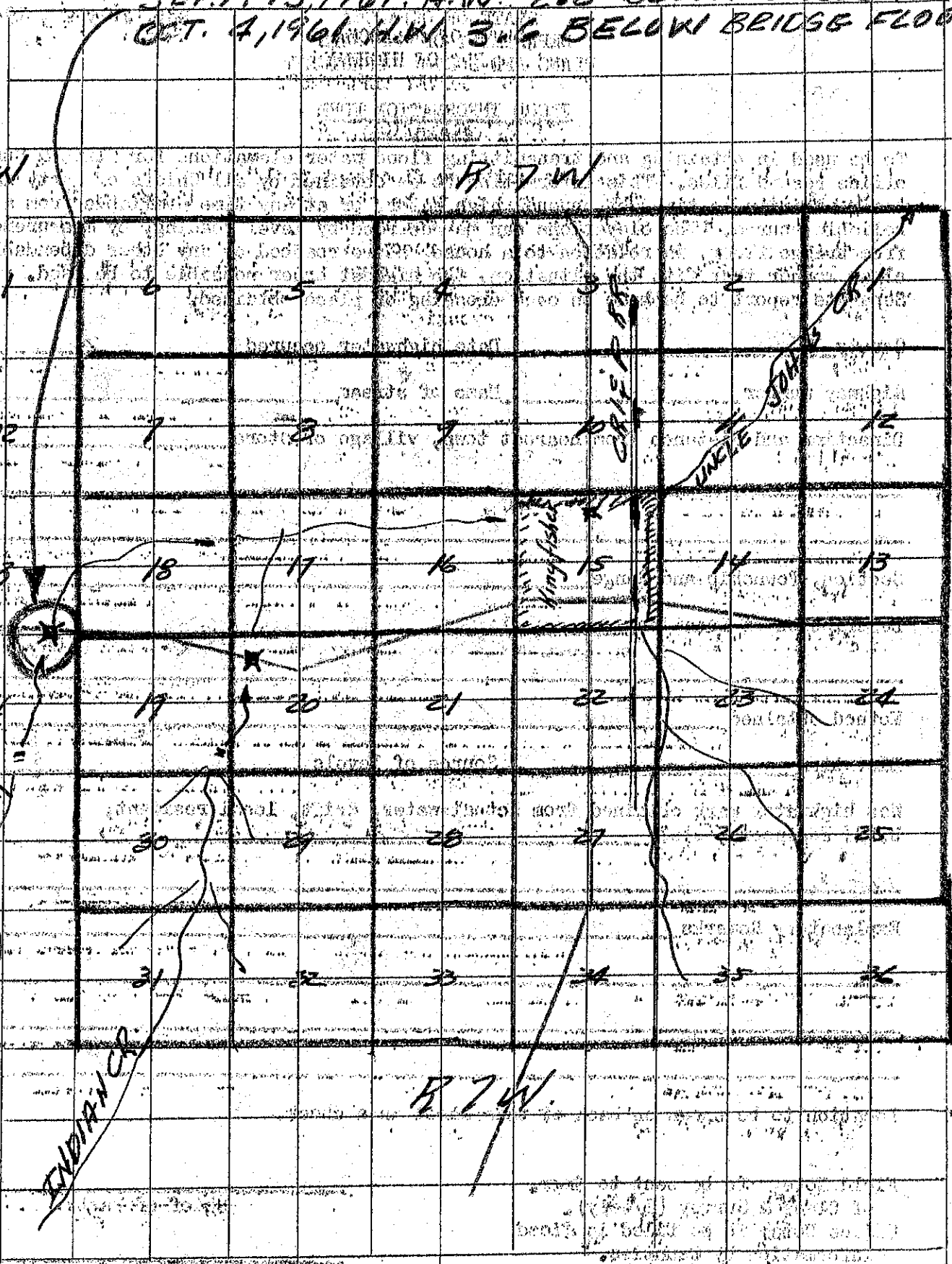

RBW

R7W

T
15
N

T
15
N

KINGFISHER CR.

INDIAN CR.

R7W

CHIEF P. ST.

UNCLE JOHN'S CR.

KINGFISHER CR.