

Plans & Survey Dept.
Form No. 16
Rev. July 10, 1947

STATE OF OKLAHOMA
DEPARTMENT OF HIGHWAYS
PLANS AND SURVEY DEPARTMENT

FLOOD INFORMATION FORM

To be used in obtaining and transmitting flood water elevations for Plans & Survey office record files. This information to be obtained by all Chiefs of Party in their vicinity in times of unusual high water, or at any time available from a reliable source. The elevations can be recorded by level reading, by measurement from bridge floor, in relation to a house, above roadbed or any other dependable, clear manner that fits the situation, the highest order possible to be used. Separate report to be made on each crossing or place obtained.

County Kingfisher Date highwater occurred OCT 4 1955

Highway number COUNTY ROAD Name of stream Kingfisher CREEK

Direction and distance from nearest town, village or store West side of Kingfisher on County Road between sec. 15^E16-T16N R7W.

Section, Township and Range Sec. 15^E16 T16N R7W.

Description of Location _____

Method obtained V-LEVEL

Elevation 1042.06 Source of levels USCEES

Was highwater mark obtained from actual water, drift, local resident, U. S. Engineers, etc? _____

Explanatory Remarks obtained by G.H. Stout & W.N. McLaughlin
FROM DRIFT ON OCT 4, 1955

Location to be shown on back of this sheet as a check.

Field Note: To be sent to Engr. of Plans & Survey (1 copy).
Office Note: To be filed in Flood Information by Counties.

W.N. McLaughlin
Chief of Party
10-10-55
Date

LOCATION NO. 6

Handwritten notes at the top of the page, including "MAY 1951" and "MAY 1951" written twice.

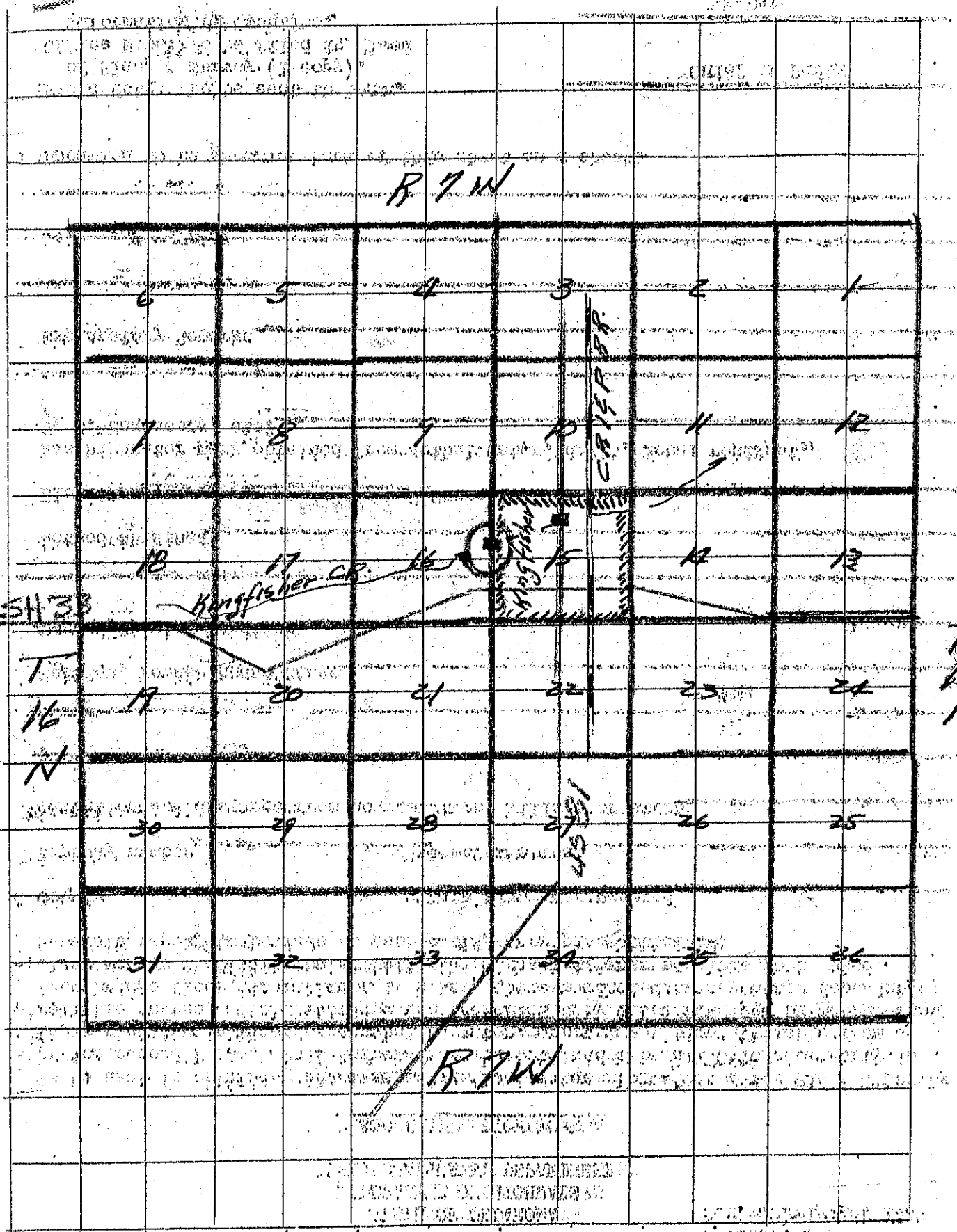

Small handwritten notes at the bottom right of the page.