

STATE OF OKLAHOMA  
DEPARTMENT OF HIGHWAYS  
PLANS & SURVEYS DEPARTMENT

Plans & Survey Dept.  
Form No. 16  
Rev. July 10, 1947

FLOOD INFORMATION FORM

To be used in obtaining and transmitting flood water elevations for Plans & Survey office record files. This information to be obtained by all Chiefs of Party in their vicinity in times of unusual high water, oratory time available from a reliable source. The elevations can be recorded by level reading, by measurement from bridge floor, in relation to a house, above roadbed or any other dependable, clear manner that fits the situation, the highest order possible to be used. Separate report to be made on each crossing or place obtained.

County Kingfisher Date highwater occurred November 18, 1953

Highway number US 81 Name of stream Kingfisher Creek

Direction and distance from nearest town, village or store \_\_\_\_\_

North City Limits of Kingfisher on US 81

Section, Township and Range Section 15 T 16 N R - 7 W

Description of Location At US 81 Bridge on Main street in the City of Kingfisher

at the north city limits

Method obtained y- Level

Elevation 1036.85 Source of levels US O&GS

Was highwater mark obtained from actual water, drift, local resident, U. S.

Engineers, etc: XXXX Water line on Piers of New Bridge

Explanatory Remarks \_\_\_\_\_

RECEIVED

DEC 1 1953

PLANS & SURVEY  
DEPARTMENT

Location to be shown on back of this sheet as a check.

Field Note: To be sent to Engr.  
of Plans & Surveys (1 copy).  
Office note: To be filed in Flood  
information by Counties.

W.N. McLaughlin  
W.N. McLaughlin  
Chief of Party

Date \_\_\_\_\_

Location No. 6

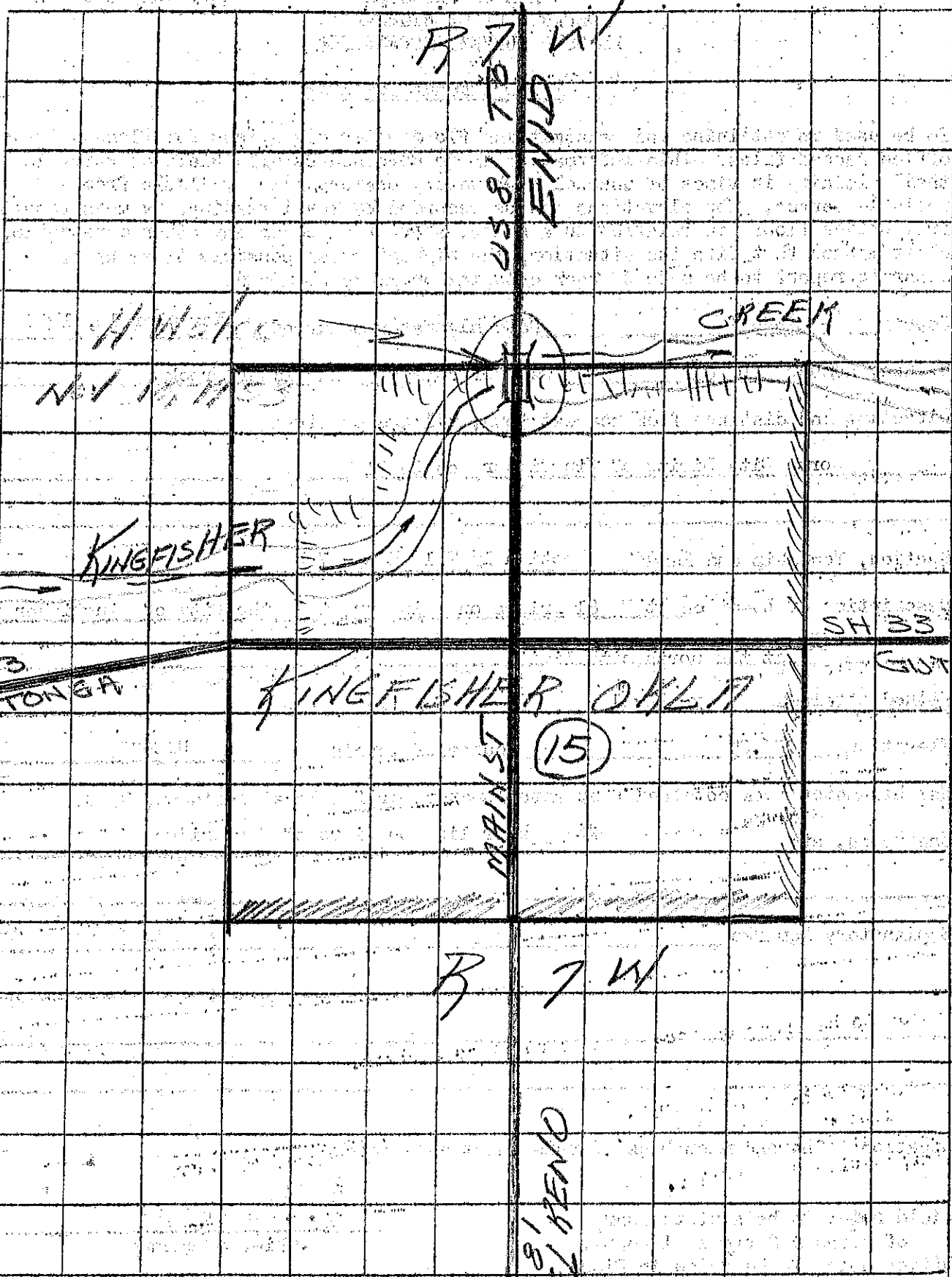

R 7 W  
US 81 TO EL BEND

H. W. L.  
NEW W. L.

CREEK

KINGFISHER

SH 33 TO GUTHRIE

SH 33 TO WATONGA

KINGFISHER OLD

(15)

MAIN ST

T 16 N

T 16 N

R 7 W

US 81 TO EL BEND