

STATE OF OKLAHOMA
DEPARTMENT OF HIGHWAYS
SURVEY DIVISION

FLOOD INFORMATION FORM

To be used in obtaining and transmitting flood water elevations for Survey Division office record files. This information to be obtained by all Chiefs of Party or others in their vicinity in times of unusual high water, or at any time available from a reliable source. The elevations can be recorded by level reading, by measurement from bridge floor, in relation to a house, above roadbed or any other dependable, clear manner that fits the situation, the highest order possible to be used. Separate report to be made on each crossing or place obtained.

County KINGFISHER Date highwater occurred MAY 17, 1982

Highway number S.H. 33 Name of stream _____

Direction and distance from nearest town, village or store AT INTERSECTION OF
(S.H. 33)
10TH ST. & BROADWAY AVE. IN KINGFISHER, OKLA.

Section, Township and Range SEC. 15, T-16-N, R-7-W

Description of Location 5.4 FEET ABOVE STREET INTERSECTION

Elevation 1046.2 Source of levels F.A.P. NO. 276 SEC. "B"

S.H. 33 PLANS
Method obtained ENGR'S. LEVEL & LEVEL ROD Date obtained MAY 20, 1982

Did it appear to be normal medium extreme do not know

Was highwater mark obtained from actual water, drift, local resident,
U. S. Engineers, etc.? WATER MARKS ON BUSINESS BUILDINGS & HOUSES

Explanatory Remarks 4.5 INCHES OF RAIN FELL ON SUNDAY MAY 16, 1982 ON TOP
OF 3 TO 4 INCHES WHICH FELL EARLIER CAUSING FLOODING ON S.H. 33 AND
EVACUATION OF 400-600 PERSONS.

Location to be shown on back of this sheet as a check.

Field Note: To be sent to
Survey Engineer

Quincy Walker
TRANSPORTATION ENGINEER III
MAY 24, 1982
Date

Location No. 6

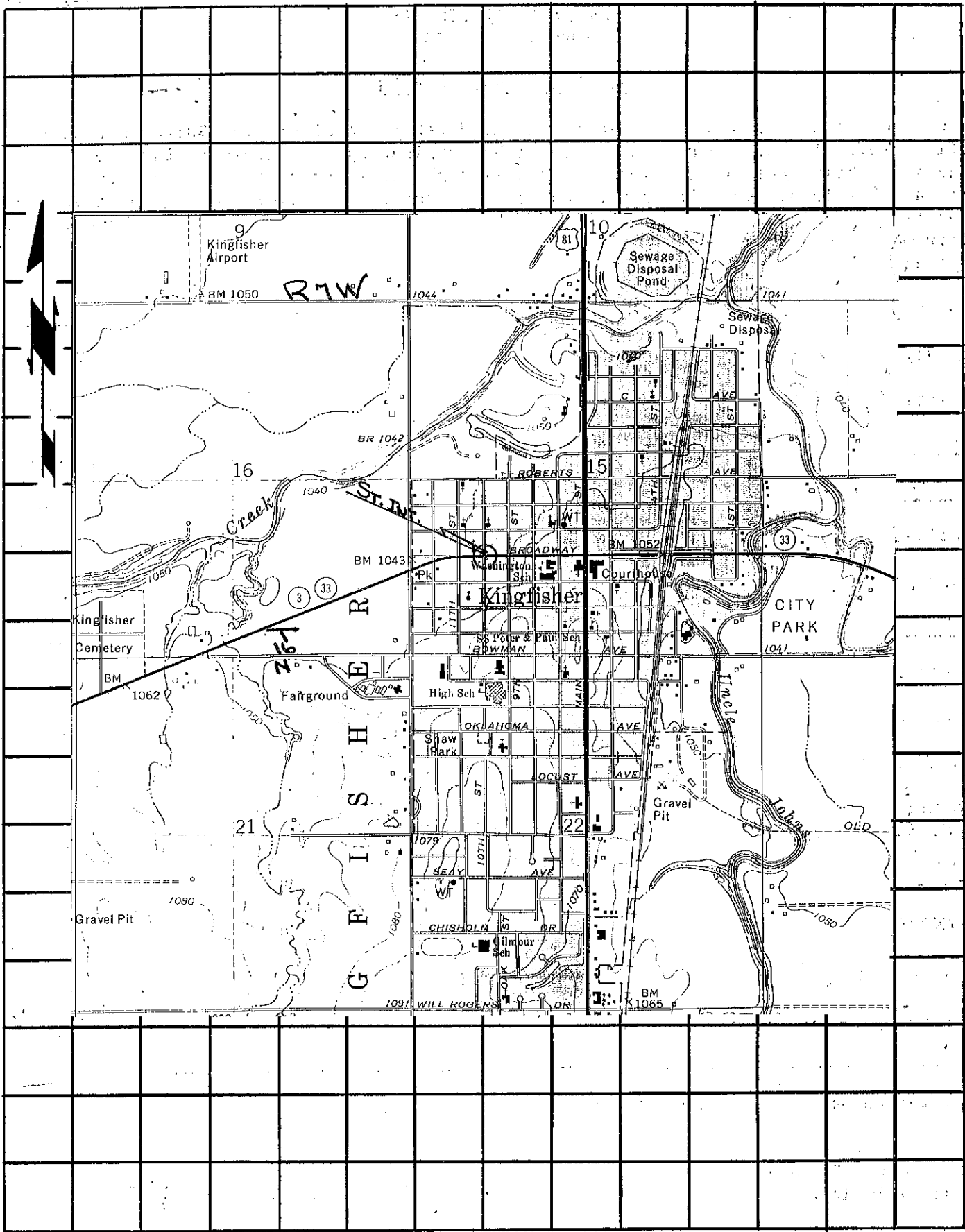

Kingfisher Airport

BM 1050

R1W

1044

10

Sewage Disposal Pond

Sewage Disposal

1041

16

Creek

ST. JAMES

BR 1042

15

ROBERTS

BM 1043

BM 1052

PK

Washington Sch

Courthouse

Kingfisher Cemetery

BM

1062

Fairground

33

Z6A

3

33

High Sch

SS Peter & Paul Sch

BOWMAN

CITY PARK

1041

21

H

S

I

D

Shaw Park

OKLAHOMA

LOUST

1079

BEAY

10TH

CHISHOLM

1091

WILL ROGERS

22

Gravel Pit

1050

Gravel Pit

1090

1080

1020

1020

BM

1065

1050