

STATE OF OKLAHOMA
DEPARTMENT OF HIGHWAYS
SURVEY DIVISION

FLOOD INFORMATION FORM

To be used in obtaining and transmitting flood water elevations for Survey Division office record files. This information to be obtained by all Chiefs of Party or others in their vicinity in times of unusual high water, or at any time available from a reliable source. The elevations can be recorded by level reading, by measurement from bridge floor, in relation to a house, above roadbed or any other dependable, clear manner that fits the situation, the highest order possible to be used. Separate report to be made on each crossing or place obtained.

County KAY Date highwater occurred SEPT. 13, 1961 & SEPT. 21 OR 23, 1961
Highway number US 77 Name of stream ROCKY FORD CREEK
Direction and distance from nearest town, village or store APPROX 2.5 MILES SOUTH OF OKLAHOMA - KANSAS STATE LINE NORTH OF NEWKIRK

Section, Township and Range SEC. 25 T 29 N R 2 E

Description of Location AT ROCKY FORD CREEK BRIDGE ON PRESENT US 77

Elevation SEPT. 13, 1961 ELEV. 1116.1
SEPT. 21 OR 23, 1961 ELEV. 1116.0 Name of levels U.S.C.&G.S. SWO. 2207 (1)

Method obtained Y LEVEL & B.M. ON R.R. BR. Date obtained SEPT. 18, 1961 & SEPT. 26, 1961

Did it appear to be normal medium extreme do not know

Was highwater mark obtained from actual water, drift, local resident, U. S. Engineers, etc.? WELL DEFINED SILT MARKS ON RD. FILL AND DRIFT IN TREES AND FENCE ON WEST SIDE RD. (ABOVE FOR FLOOD OF SEPT. 13,) SEPT. 21. OR 23. WELL DEFINED SILT MARKS ON WEST SIDE ROAD FILL. DISTINGUISHED FROM SEPT. 13, DRIFT BECAUSE SLOPES WERE RECENTLY MOWN AND SILT MARKS VERY PLAIN.

Explanatory Remarks DON STEWARD OF THE MAINT DIV. (FROM PONCA CITY) STATED THAT THE FLOOD OF SEPT. 13TH WAS THE HIGHEST OF HIS KNOWLEDGE. COULD NOT CONTACT THIS MAN TO CONFIRM INFORMATION OF SEPT. 21, 23, 1961.

Location to be shown on back of this sheet as a check.

Field Note: To be sent to
Survey Engineer

Dean C. Lammitt
~~Chief of Party~~
SEPT. 28 1961
Date

10/4/61 COPY TO H. SULLOWAN
H. COLEB.

Location No. 2A

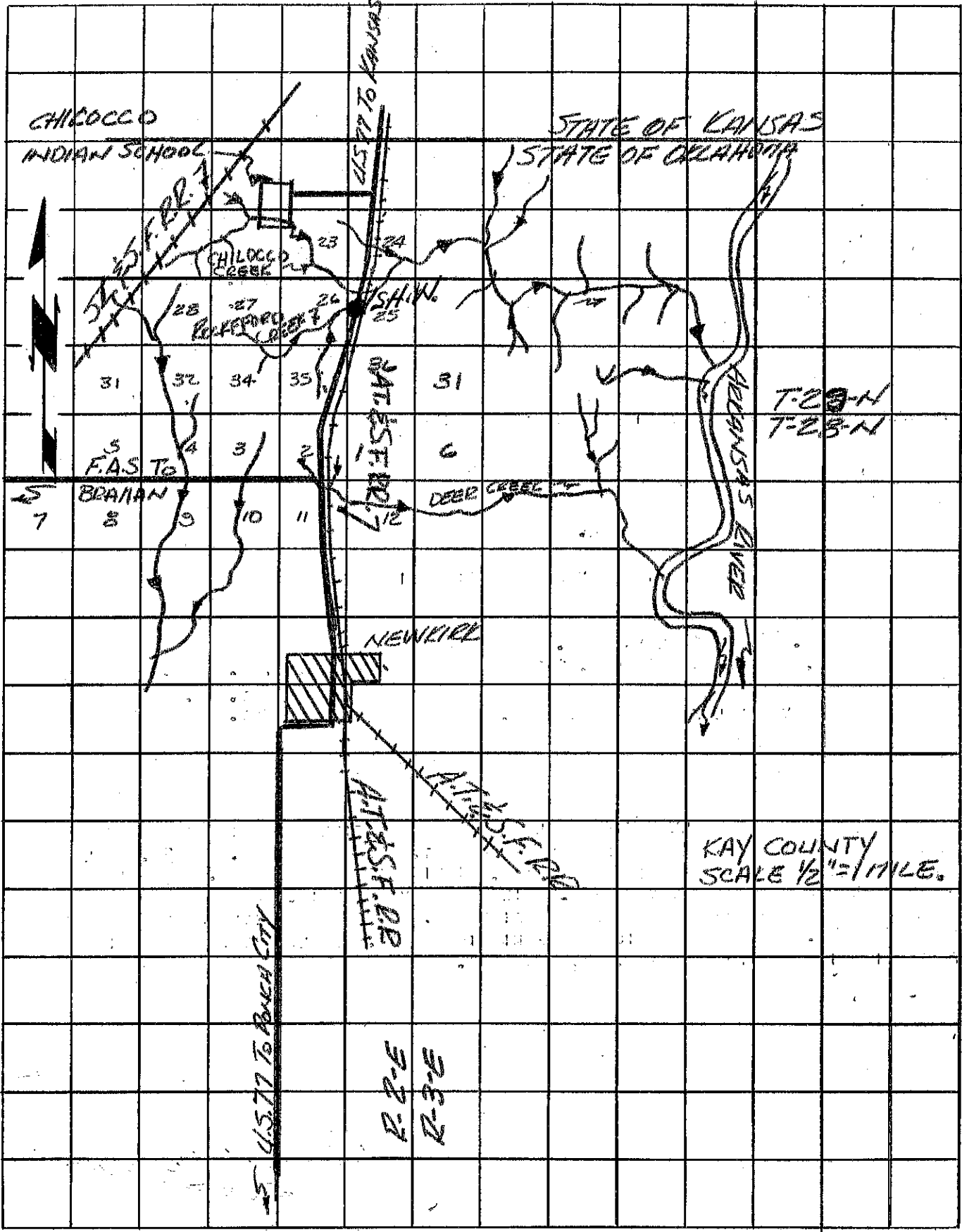

CHICOCCO
INDIAN SCHOOL

STATE OF KANSAS
STATE OF OKLAHOMA

CHICOCCO
CREEK

REDFORD
CREEK

U.S. 77
TO
NEWKIRK

FAST TO
BRAMAN

DEER CREEK

T-23-N
T-28-N

NEWKIRK

U.S. 77
TO
BRAMAN CITY

KAY COUNTY
SCALE 1/2" = 1 MILE.

R-2-E
R-3-E

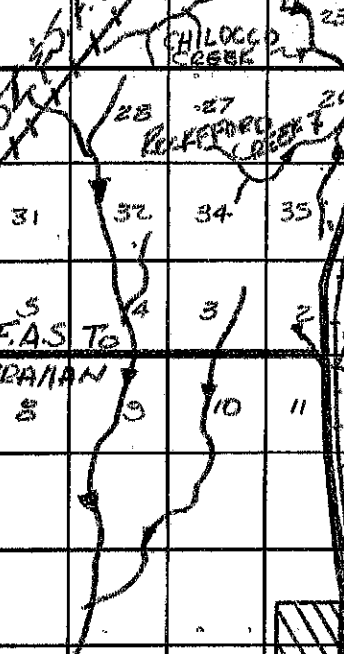

SHIN.

31

6

31

32

34

35

7

8

9

10

11

12

U.S. 77 TO BRAMAN CITY

U.S. 77
TO
BRAMAN CITY