

RECEIVED

JUN 7 1993

SURVEY DIVISION

STATE OF OKLAHOMA
DEPARTMENT OF HIGHWAYS
SURVEY DIVISION

Survey Division
Form No. 16
Rev. Sept. 10, 1961

FLOOD INFORMATION FORM

To be used in obtaining and transmitting flood water elevations for Survey Division office record files. This information to be obtained by all Chiefs of Party or others in their vicinity in times of unusual high water, or at any time available from a reliable source. The elevations can be recorded by level reading, by measurement from bridge floor, in relation to a house, above roadbed or any other dependable, clear manner that fits the situation, the highest order possible to be used. Separate report to be made on each crossing or place obtained.

County KAY-OSAGE Date highwater occurred 5-16-93

Highway number U.S. 60 Name of stream ARKANSAS RIVER

Direction and distance from nearest town, village or store SE EDGE OF
POMCACITY

Section, Township and Range SEC. 35, T 26 N - R 2 E

Description of Location BRIDGE ON U.S. 60 AT COUNTY LINE

Elevation _____ Source of levels _____

Method obtained ENGR. LEVEL & ROD Date obtained 5-24-93

Did it appear to be normal medium extreme do not know

Was highwater mark obtained from actual water, drift, local resident, U. S. Engineers, etc.? DRIFT

Explanatory Remarks HIGHWATER - 10' BELOW SE. BRIDGE SEAT

Location to be shown on back of this sheet as a check.

Field Note: To be sent to
Survey Engineer

Ronald D. Levin
Chief of Party

5-25-93
Date

Copy to Bridge 6-8-93

LOCATION No. 3

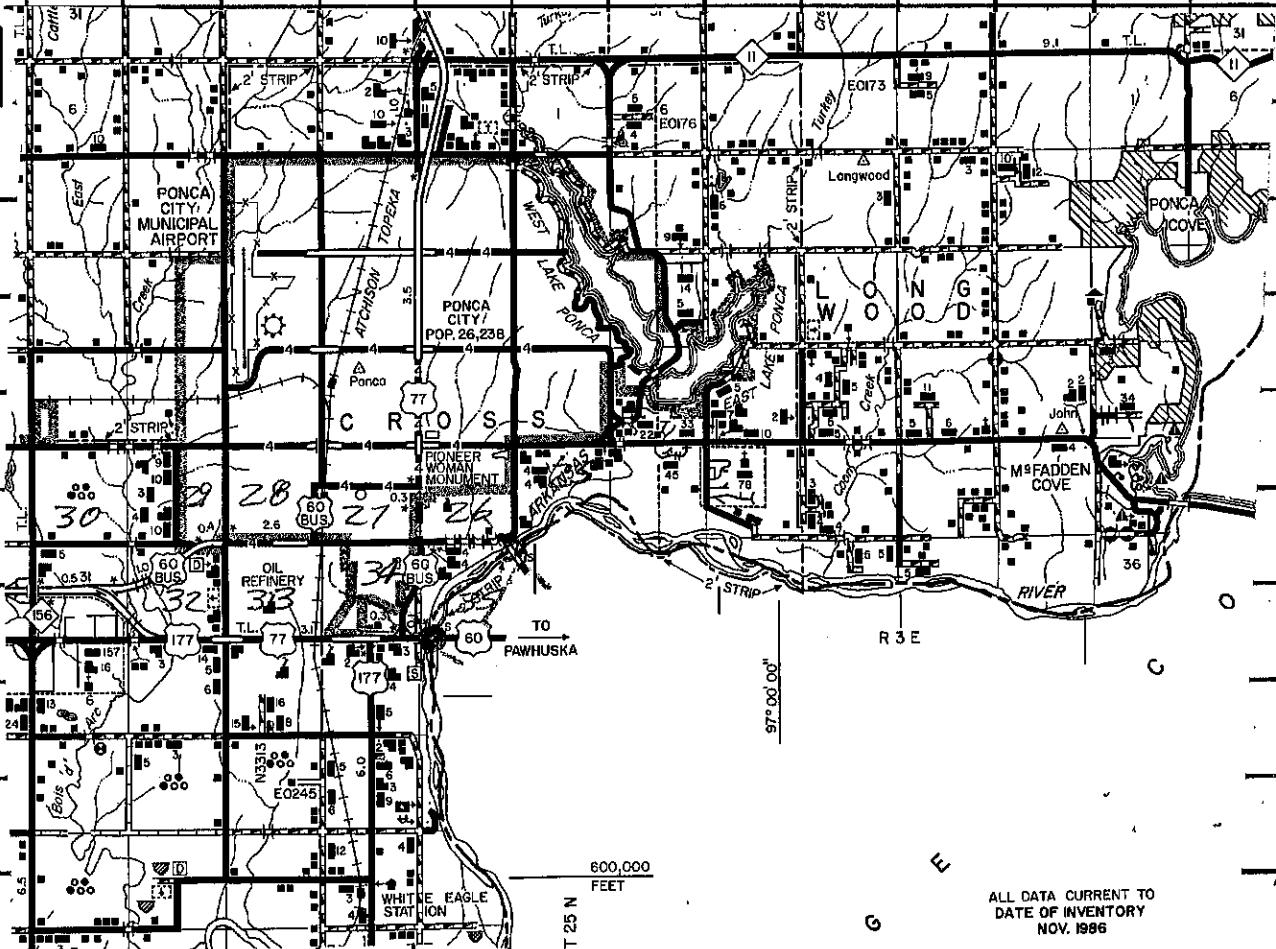
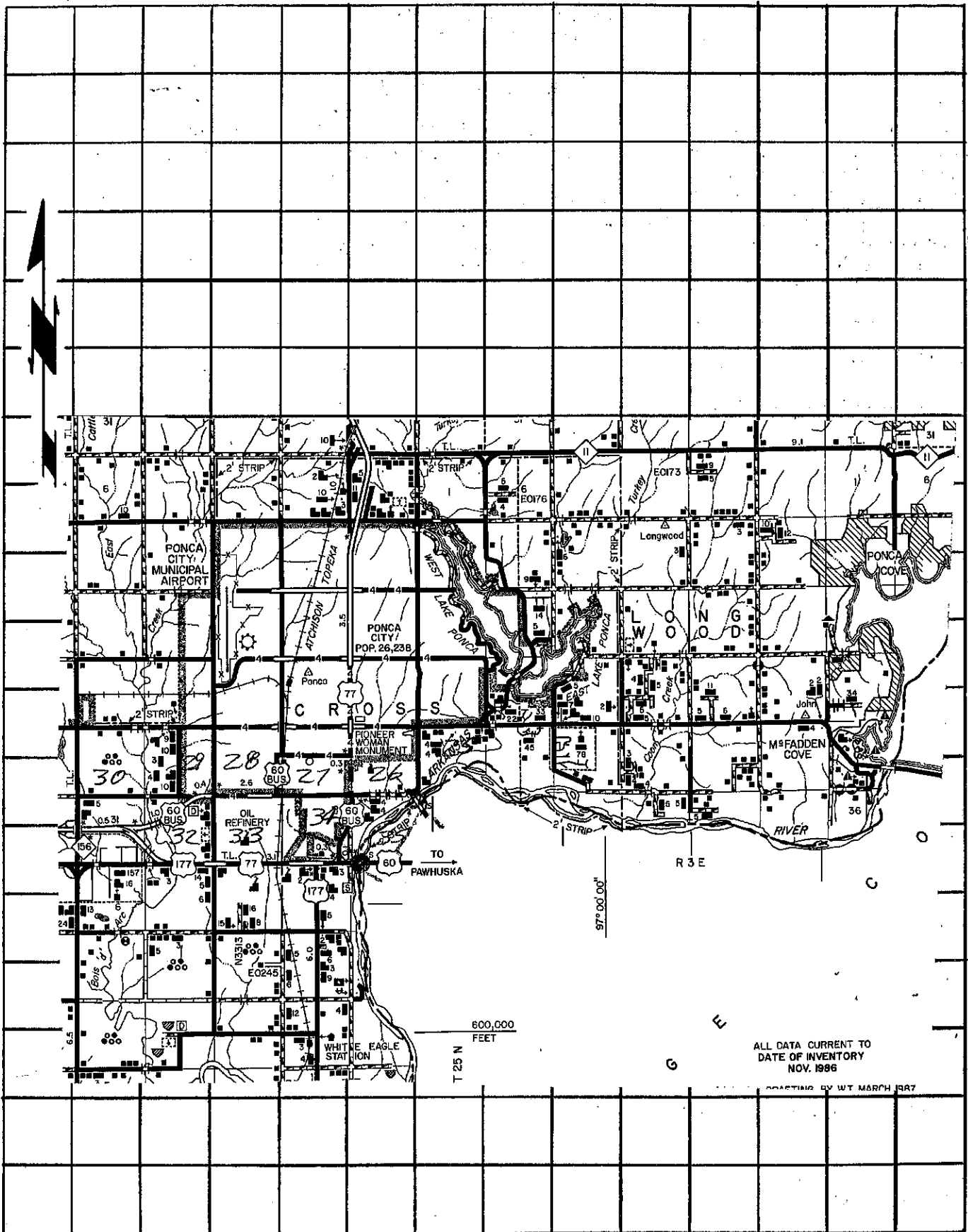

ALL DATA CURRENT TO
DATE OF INVENTORY
NOV. 1986

DRAWN BY WT MARCH 1987