

Plans & Survey Dept.
Form No. 16
Rev. July 10, 1947

STATE OF OKLAHOMA
DEPARTMENT OF HIGHWAYS
PLANS AND SURVEY DEPARTMENT

FLOOD INFORMATION FORM

To be used in obtaining and transmitting flood water elevations for Plans & Survey office record files. This information to be obtained by all Chiefs of Party in their vicinity in times of unusual high water, or at any time available from a reliable source. The elevations can be recorded by level reading, by measurement from bridge floor, in relation to a house, above roadbed or any other dependable, clear manner that fits the situation, the highest order possible to be used. Separate report to be made on each crossing or place obtained.

County KAY COUNTY Date highwater occurred November 18, 1964
Highway number RR US 177 Name of stream None
And Fountain Road
Direction and distance from nearest town, village or store 2.0 miles South
Tonkawa Oklahoma.

Section, Township and Range At. 1/4 Section Between Section 9 & 16, T-25-N, R-3-W.
Description of Location At Intersection of US 177 and Fountain Road 2.0 miles
South of Tonkawa Oklahoma.

Method obtained Y-Level

Elevation 949.56 ~~PAYIXPAYIX~~ Source of levels FAP-887 (3)CS
BM- 60D. nain in Mulberry 61 ft. rt. sta. 121/46 of FAP-887(3)-C. Plans.

Was highwater mark obtained from actual water, drift, local resident,
U. S. Engineers, etc? Observation of actual highwater by me at location on

November 17, 1964. At Sta. 127/15 of SAP 887(3)-CS As. built plans. Highwater
was over Fountain Road from Sta. 127/12 TO Sta. 129/91.7. And over present US 177
Explanatory Remarks Back water from EKI Salt Fork of Arkansas River, was over
present US 177 from 300 ft. North of intersection of US 177 and Fountain Road
to a point 10 ft. North ~~300 ft. North~~ center section 16, T- 25-N, R-1-W.

SET BM- (X) on SE corner of West headwall of culvert side drain Lt. Sta. 129/91.7
Or cross drain on US 177 approx. Sta. 130/66 of Control Section 36-12 plans.
Elevation- 947.90 Ft.

Location to be shown on back of this sheet as a check.

Field Note: To be sent to Engr.
of Plans & Survey (1 copy).
Office Note: To be filed in Flood
Information by Counties.

Chas. A. Willis
Chief of Party
Dec. 12, 1964
Date

LOCATION NO. 5B

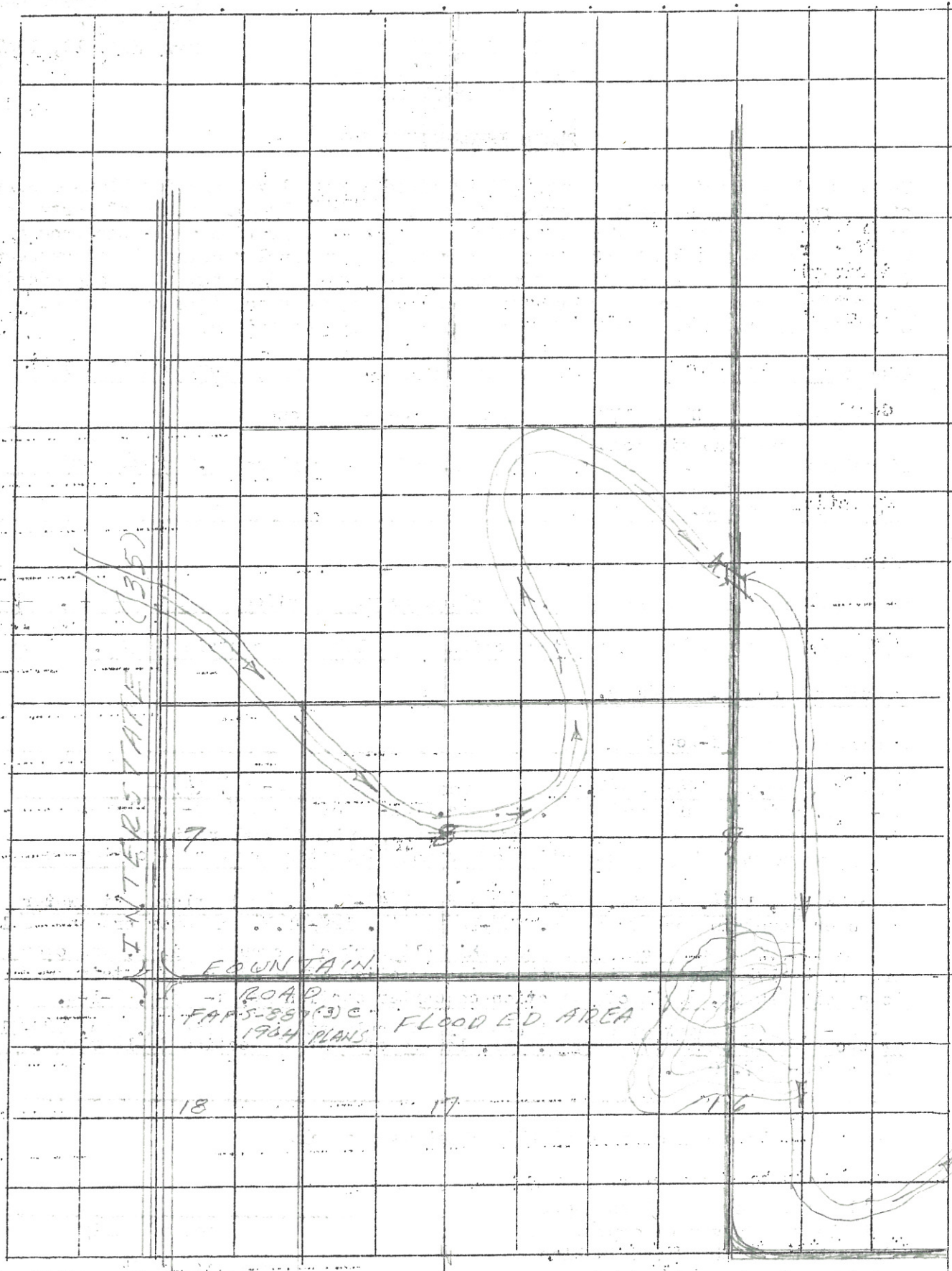

INTERSTATE (35)

FOUNTAIN

ROAD
FAPS-887(3)C
1964 PLANS

FLOODED AREA

18

17

16

7