

Survey Division
Form No. 16
Rev. Sept. 10, 1961

STATE OF OKLAHOMA
DEPARTMENT OF HIGHWAYS
SURVEY DIVISION

FLOOD INFORMATION FORM

To be used in obtaining and transmitting flood water elevations for Survey Division office record files. This information to be obtained by all Chiefs of Party or others in their vicinity in times of unusual high water, or at any time available from a reliable source. The elevations can be recorded by level reading, by measurement from bridge floor, in relation to a house, above roadbed or any other dependable, clear manner that fits the situation, the highest order possible to be used. Separate report to be made on each crossing or place obtained.

County KAY Date highwater occurred MARCH 11, 1973

Highway number US-77 Name of stream SALT FORK ARKANSAS RIVER

Direction and distance from nearest town, village or store 1.5 MILES SOUTH OF TONKAWA

Section, Township and Range SECTION 9&16, T-25-N, R-1-W.

Description of Location AT JCT. OF US 77 AND FOUNTAIN ROAD (EW-25) SEC. LINE.

Elevation 951.33 Source of levels FASP NO. S-887 (1) CS. PLANS USC&GS DATUM

Method obtained WYE LEVEL AND ENGINEERING ROD Date obtained JUNE 11, 1973

Did it appear to be normal medium extreme do not know

Was highwater mark obtained from actual water, drift, local resident, U. S. Engineers, etc.? ACTUAL HIGHWATER AND DRIFT MARKS.

Explanatory Remarks THE SALK FORK OF THE ARKANSAS RIVER BACKED UP CUT ROAD DITCH AND FLOODED THIS AREA, US 77 TO THE SOUTH OF JCT. WAS UNDER WATER APPROX. 1/2 MILE, TO THE WEST FOUNTAIN ROAD WAS UNDER WATER APPROX. 418 FT. TO THE NORTH US 77 WAS UNDER WATER FOR APPROX. 3800 FT. APPROX. 3.5 FT. OF WATER IN INTERSECTION FOR APPROX. 1-DAY CLOSURE OF ROADS.

Location to be shown on back of this sheet as a check.

Field Note: To be sent to
Survey Engineer

Oda Roy Sib
~~CHIEF OF PARTY~~
ACT. LOC. ENGR.
JUNE 11, 1973
Date

Location No. 5B

RECORDED
 1973

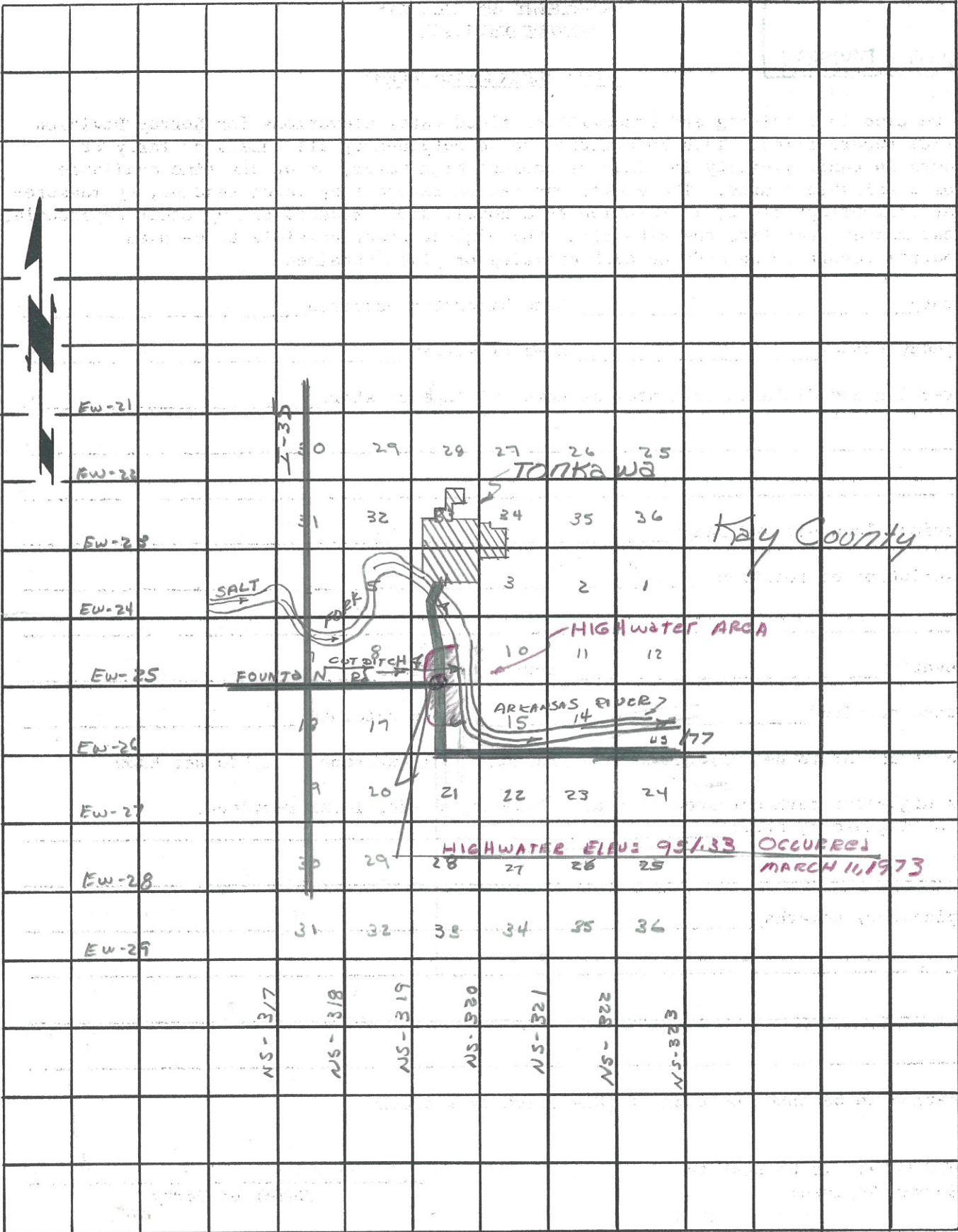

R-1-w