

STATE OF OKLAHOMA
DEPARTMENT OF HIGHWAYS
SURVEY DIVISION

FLOOD INFORMATION FORM

To be used in obtaining and transmitting flood water elevations for Survey Division office record files. This information to be obtained by all Chiefs of Party or others in their vicinity in times of unusual high water, or at any time available from a reliable source. The elevations can be recorded by level reading, by measurement from bridge floor, in relation to a house, above roadbed or any other dependable, clear manner that fits the situation, the highest order possible to be used. Separate report to be made on each crossing or place obtained.

County KAY Date highwater occurred SEPT. 13, 1961 & SEPT. 21, 1961
Highway number US 60 Name of stream BOIS D'ARC CREEK
Direction and distance from nearest town, village or store APPROX. 1.5 MI. EAST OF Jct. US 77 & US 60 WEST OF PONCA CITY

Section, Township and Range ON E. & W. SEC. LINE BETWEEN SECTIONS 32 & 5 R 2 E TOWNSHIP LINE BETWEEN T 25 N & T 26 N
Description of Location AT BOIS D'ARC CREEK BRIDGE ON US 60

SOUTH. SIDE OF BR. ELEV. 945.5
Elevation N. SIDE OF BR. ELEV. 948.0 Source of levels U.S.C&G.S. SWO 2323 (1)

Method obtained Y LEVEL & BM. ON BRIDGE Date obtained SEPT. 18? 26, 1961

Did it appear to be normal medium extreme do not know

Was highwater mark obtained from actual water, drift, local resident, U. S. Engineers, etc.? SOUTH SIDE OF BRIDGE WAS FURNISHED BY ELMER ZEMP WHO IS LEASEE OF KNOX SER STA. RT. OF STA. 503 . WATER REACHED N.W. COR OF CAR PORT AT RES SOUTH OF STATION. NORTH SIDE OF BR. SILT MARK ON INSIDE OF WINDOW AND WALL PAPER & MARK ON FRM GAR. E. OF HOUSE. SEE SWO 2323 (1) LEVEL BOOK NO. 3 SECTION NO. 2 FOR FURTHER NOTE. "LINE A".
Explanatory Remarks

THIS HIGHWATER CAUSED BY HURRICANE CARLA. THERE WAS NO DOUBT AS TO THE ACCURACY OF ANY OF THE WATER MARKS USED. MR. ZEMP STATED THAT THIS WAS THE HIGHEST WATER TO HIS KNOWLEDGE AND STATED THAT SEVERAL OF HIS CUSTOMERS MADE THE SAME REMARK. WATER STARTED OUT OF BANKS ABOUT 7AM AND REACHED MAXIMUM AT 10 AM.
THIS HIGHWATER TO BE CONSIDERED EXTREME.

INFO OBTAINED BY P.O. CARTMILL & O.C. CURNUTT.

Location to be shown on back of this sheet as a check.

Field Note: To be sent to
Survey Engineer

Dean C. Curnutt
Chief of Party

*10/4/61 COPIES TO McCULLOUGH
McCABE*

9/28/61

Date

*NOTE HIGHWATER OF SEPT. 21, 1961
ELEV. 943.0*

Location No. 6

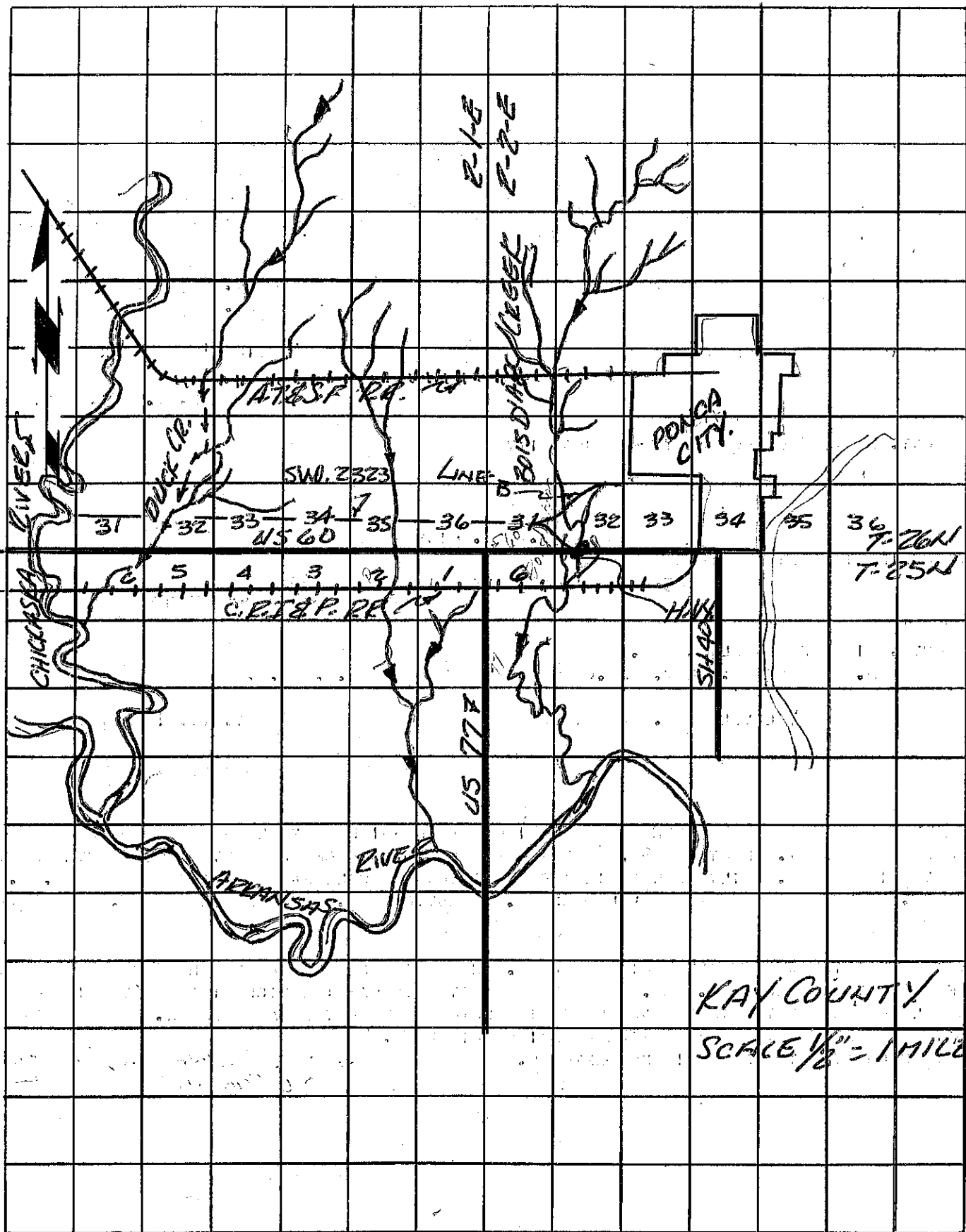

KAY COUNTY
 SCALE 1/8" = 1 MILE.