



OKLAHOMA DEPARTMENT OF TRANSPORTATION
SURVEY DIVISION

FLOOD INFORMATION FORM

Division #:	1 <input type="checkbox"/> 2 <input type="checkbox"/> 3 <input type="checkbox"/> 4 X 5 <input type="checkbox"/> 6 <input type="checkbox"/> 7 <input type="checkbox"/> 8 <input type="checkbox"/>
County:	Kay
Date Highwater occurred:	07/01/2007
Highway Number:	S.H. 156
Name of Stream:	Salt Fork river
Direction and distance from nearest town, or highway junction	3 miles north of Marland on S.H.156
Section, Township, Range:	Sec. 25, T-25-N R-1-E/ Sec. 30, T-25-N R-2-E
Description of Location:	101 Ranch on S.H.156
Highwater Elevation:	929.77
Level Datum & Source:	NAVD 88 SWO4253(1) BM10
Method used:	Digital Level
Date Elevation Obtained:	07/03/2007
Apparent Magnitude:	Normal <input type="checkbox"/> Medium <input type="checkbox"/> Extreme X Don't Know <input type="checkbox"/>
Was Highwater Mark obtained from actual water, drift, local resident, or other source?	Drift line
Explanatory Remarks:	After many days of rain

Note: Show Vicinity Map on back of form

Name (signature) *Ron D. Seim*

Name (Printed) Ron D. Seim

Date: 7-24-07

Survey Division
Form No. 16
Revised: 5/09/2007

Location No. 7

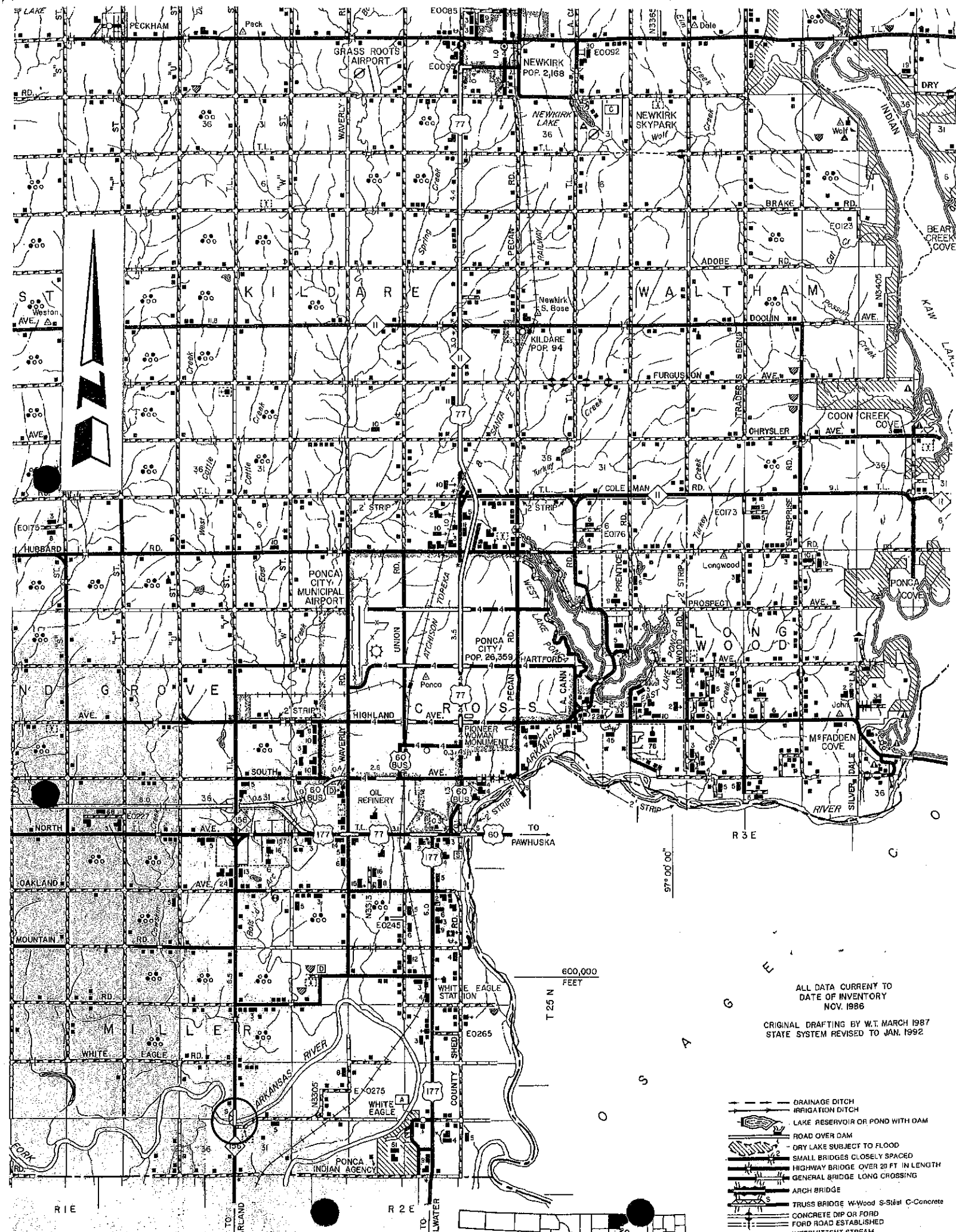

600,000 FEET

T 25 N

97° 00' 00"

R 3 E

ALL DATA CURRENTY TO DATE OF INVENTORY NOV. 1986
 ORIGINAL DRAFTING BY W.T. MARCH 1987
 STATE SYSTEM REVISED TO JAN. 1992

- DRAINAGE DITCH
- IRRIGATION DITCH
- LAKE RESERVOIR OR POND WITH DAM
- ROAD OVER DAM
- DRY LAKE SUBJECT TO FLOOD
- SMALL BRIDGES CLOSELY SPACED
- HIGHWAY BRIDGE OVER 20 FT IN LENGTH
- GENERAL BRIDGE LONG CROSSING
- ARCH BRIDGE
- TRUSS BRIDGE W-Wood S-Steel C-Concrete
- CONCRETE DIP OR FORD
- FORD ROAD ESTABLISHED
- INTERMITTENT STREAM