

STATE OF OKLAHOMA
DEPARTMENT OF HIGHWAYS
PLANS AND SURVEY DEPARTMENT

FLOOD INFORMATION FORM

To be used in obtaining and transmitting flood water elevations for Plans & Survey office record files. This information to be obtained by all Chiefs of Party in their vicinity in times of unusual high water, or at any time available from a reliable source. The elevations can be recorded by level reading, by measurement from bridge floor, in relation to a house, above roadbed or any other dependable, clear manner that fits the situation, the highest order possible to be used. Separate report to be made on each crossing or place obtained.

County Kay Date highwater occurred November 18, 1964

Highway number US 60 Name of stream Duck Creek

Direction and distance from nearest town, village or store 4.5 miles

East of Tonkawa on US 60.

Section, Township and Range At. sec. cor. common to Sec. 5, 6, 31, & 32, T-25-26-N

R-1-E

Description of Location At duck Creek bridge on US 60 4.5 miles East of

Tonkawa Oklahoma. Sta. 159/37.7 Of SAP 111-B, 1925 Plans.

Method obtained Y-Level

Elevation 959.1 Ft. Source of levels S.W.O. 2597(1) USC & GS Taken

From S.W.O. 2323(1) F283(4)(5)

Was highwater mark obtained from actual water, drift, local resident, U. S. Engineers, etc? From Water marks on center line of highway 300 ft. West of bridge and 225 ft. East of bridge, and on fill North side of highway at bridge.

(Highwater Elevation At Chickaskia River= 957.81 Ft.)

Explanatory Remarks Highwater was over present US 60 from Approx. 600 ft. East of

300

East end of Chickaskia River bridge, East to approx. 250 ft. West of Duck Creek

bridge. also over highway from approx. 200 ft East of Duck Bridge East for 500 Ft.

Location to be shown on back of this sheet as a check.

Field Note: To be sent to Engr. of Plans & Survey (1 copy).

Office Note: To be filed in Flood Information by Counties.

Clay L. Harris
Chief of Party

December 15, 1964

Date

LOCATION NO. 9

R-1-E

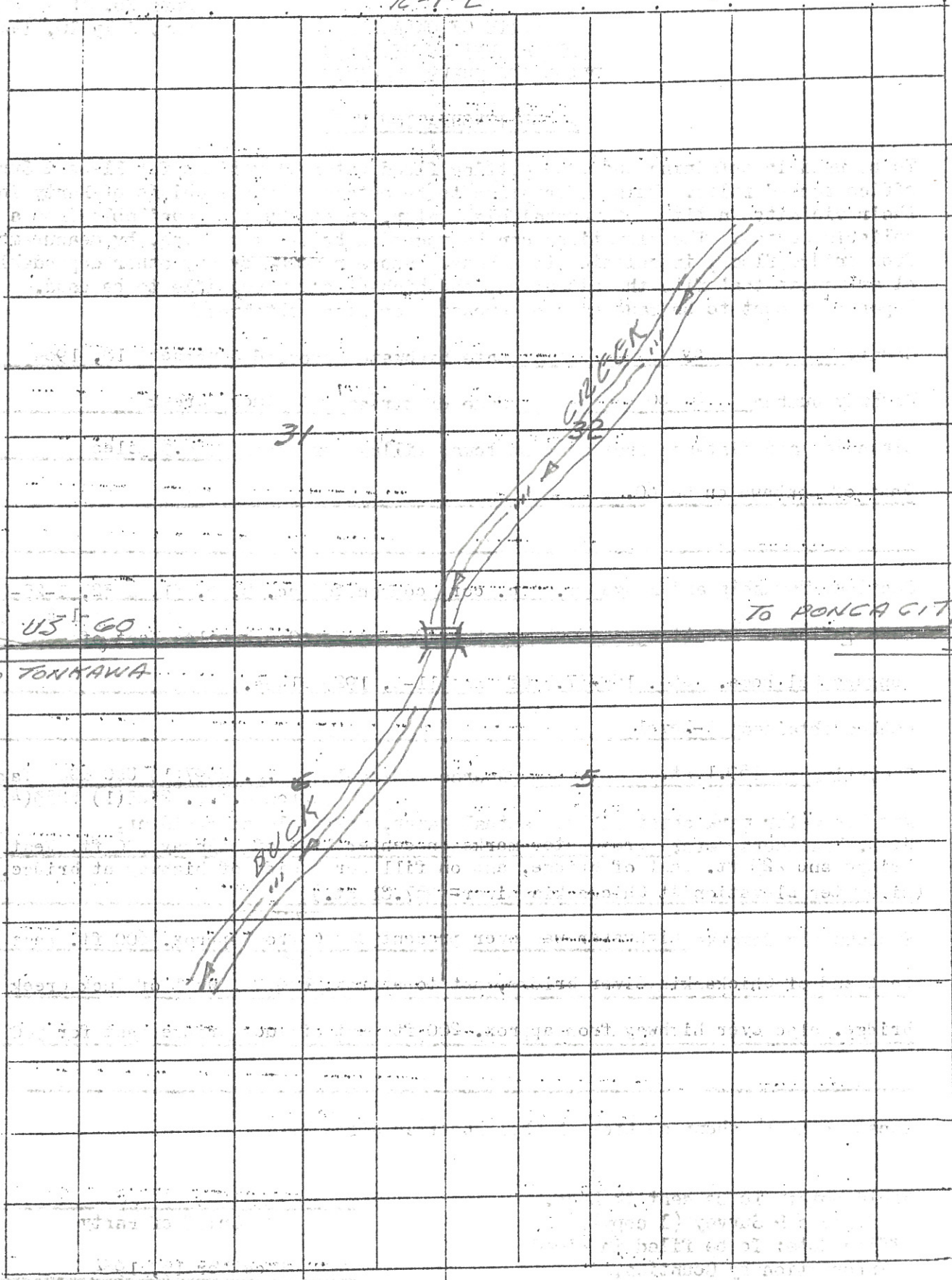

31

CREEK

32

US 60

TO PONCA CITY

TO TONKAWA

BUCK

T
26
N

T
25
N