

Survey Division
Form No. 16
Rev. Sept. 10, 1961

STATE OF OKLAHOMA
DEPARTMENT OF HIGHWAYS
SURVEY DIVISION

FLOOD INFORMATION FORM

To be used in obtaining and transmitting flood water elevations for Survey Division office record files. This information to be obtained by all Chiefs of Party or others in their vicinity in times of unusual high water, or at any time available from a reliable source. The elevations can be recorded by level reading, by measurement from bridge floor, in relation to a house, above roadbed or any other dependable, clear manner that fits the situation, the highest order possible to be used. Separate report to be made on each crossing or place obtained.

County KAY Date highwater occurred OCT 11, 1973

Highway number US 60 Name of stream CHICKASKIA RIVER

Direction and distance from nearest town, village or store 2 MI. E. OF
TONKAWA

Section, Township and Range SEC 1, T25N-R1W

Description of Location WEST END OF RIVER BRIDGE

9.4' BELOW BRIDGE FLOOR

Elevation _____ Source of levels _____

Method obtained STEEL TAPE Date obtained OCT 16, 1973

Did it appear to be normal medium extreme do not know

Was highwater mark obtained from actual water, drift, local resident, U. S. Engineers, etc.? WATER MARK ON BRIDGE PIER

Explanatory Remarks THIS WATER WAS APPROX. 3' DEEP OVER HWY E. OF BRIDGE

Location to be shown on back of this sheet as a check.

Field Note: To be sent to
Survey Engineer

Henry E. Diggins
Chief of Party

OCT 25, 1973
Date

Loc. No. 17

RIW

RIE

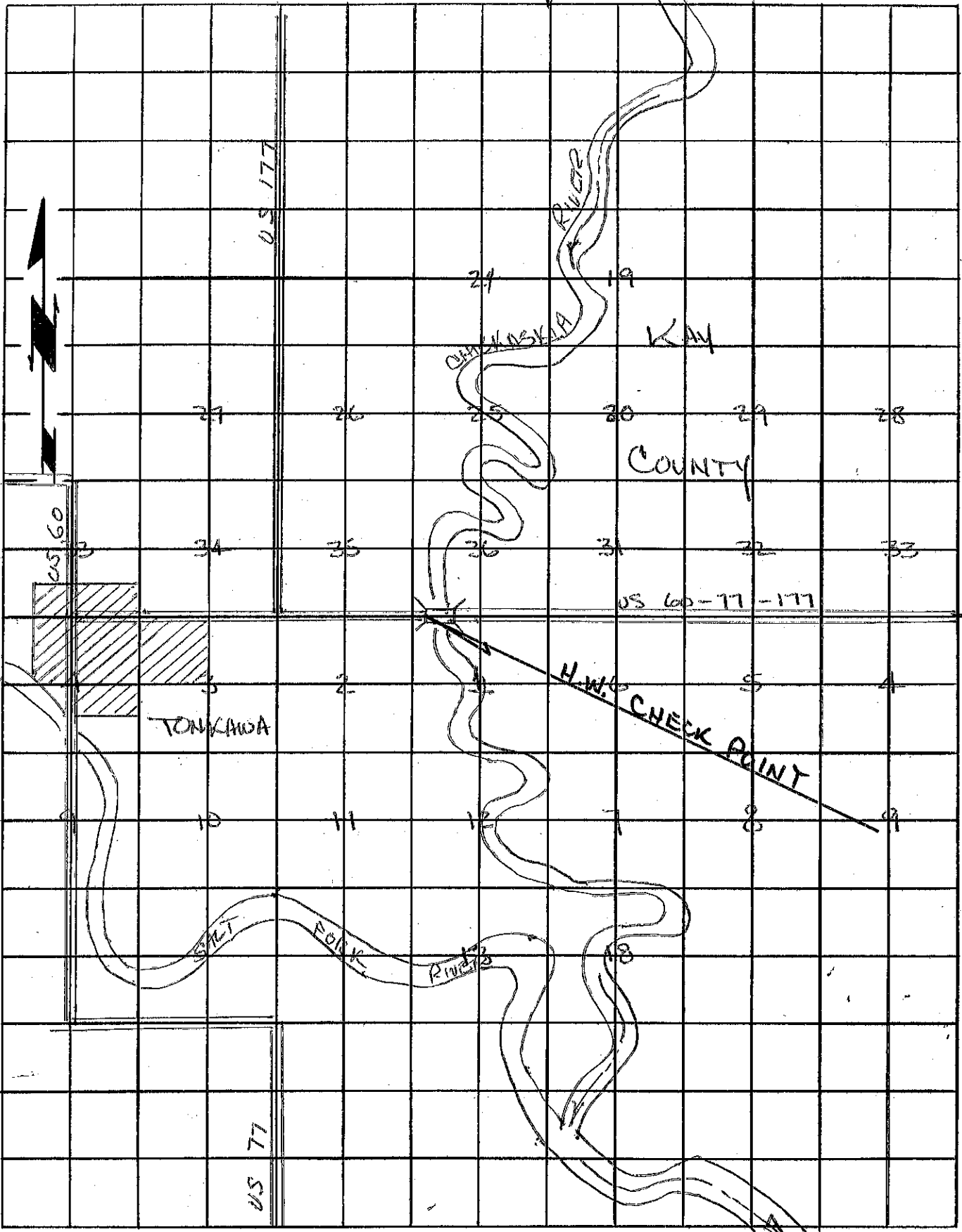

T
26
N

T
25
N