

RECEIVED  
NOV 13 1973  
SURVEY DIVISION

Survey Division  
Form No. 16  
Rev. Sept. 10, 1961

STATE OF OKLAHOMA  
DEPARTMENT OF HIGHWAYS  
SURVEY DIVISION

FLOOD INFORMATION FORM

To be used in obtaining and transmitting flood water elevations for Survey Division office record files. This information to be obtained by all Chiefs of Party or others in their vicinity in times of unusual high water, or at any time available from a reliable source. The elevations can be recorded by level reading, by measurement from bridge floor, in relation to a house, above roadbed or any other dependable, clear manner that fits the situation, the highest order possible to be used. Separate report to be made on each crossing or place obtained.

County KAN Date highwater occurred OCT 11, 1973

Highway number FAS 3604 Name of stream CHICKASKIA RIVER

Direction and distance from nearest town, village or store 3 MI. S. AND 3 MI. E. OF BLACKWELL

Section, Township and Range SEC 7, T 26 N - R 1 E

Description of Location WEST END OF RIVER BRIDGE  
7.2' BELOW BRIDGE FLOOR

Elevation \_\_\_\_\_ Source of levels \_\_\_\_\_

Method obtained STEEL TAPE Date obtained OCT 16, 1973

Did it appear to be  normal  medium  extreme  do not know

Was highwater mark obtained from actual water, drift, local resident, U. S. Engineers, etc.? WATER MARK ON BRIDGE ABUTMENT

Explanatory Remarks GOODSON BRIDGE BUILT IN 1962

Location to be shown on back of this sheet as a check.

Field Note: To be sent to  
Survey Engineer

Perry E. Diggins  
Chief of Party

OCT 25, 1973  
Date

Loc. No. 23

R1W

R1E

T  
27  
N

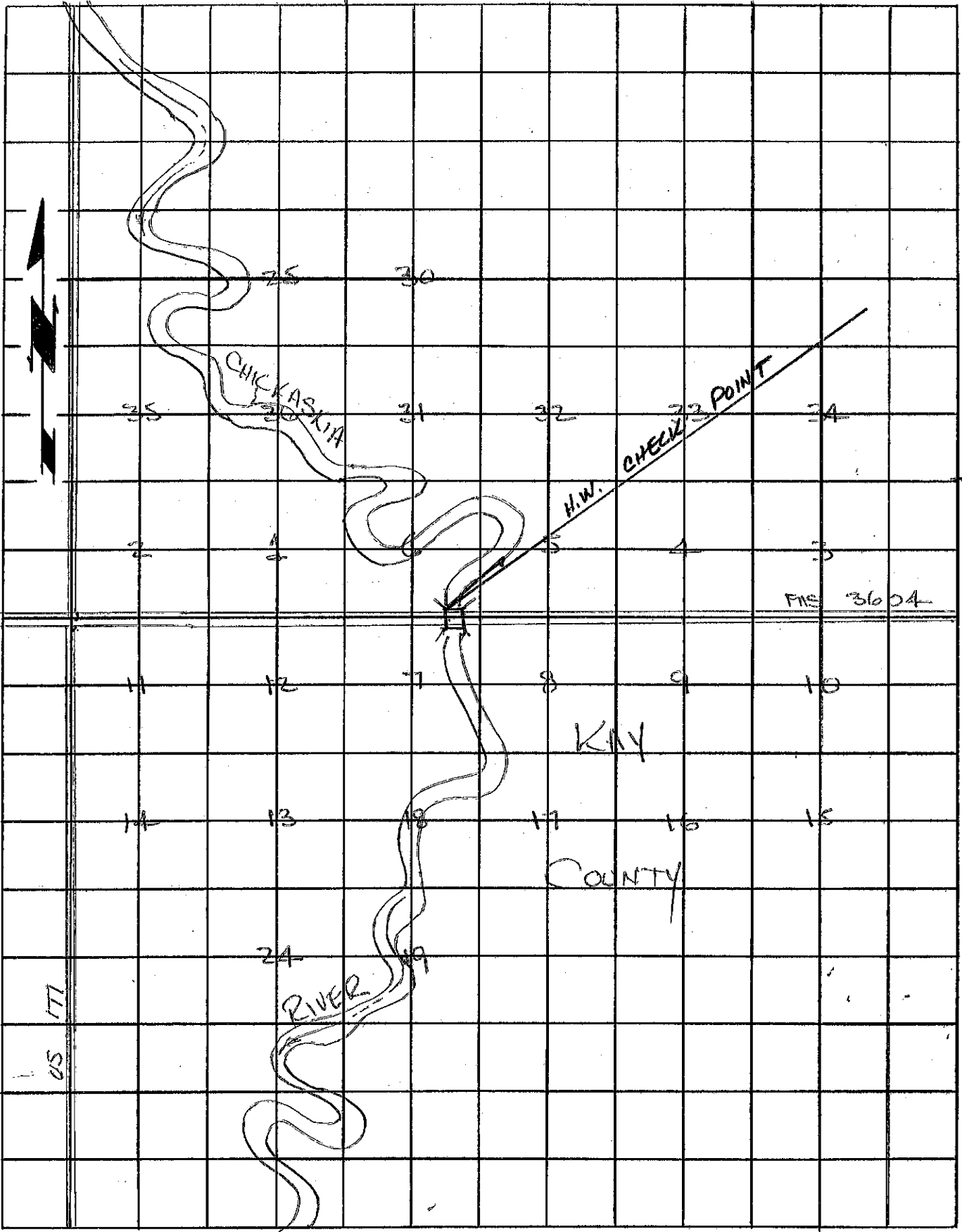

T  
26  
1