

STATE OF OKLAHOMA  
DEPARTMENT OF HIGHWAYS  
SURVEY DIVISION

FLOOD INFORMATION FORM

To be used in obtaining and transmitting flood water elevations for Survey Division office record files. This information to be obtained by all Chiefs of Party or others in their vicinity in times of unusual high water, or at any time available from a reliable source. The elevations can be recorded by level reading, by measurement from bridge floor, in relation to a house, above roadbed or any other dependable, clear manner that fits the situation, the highest order possible to be used. Separate report to be made on each crossing or place obtained.

County KAY Date highwater occurred OCT 11, 1973

Highway number FAS 3609 Name of stream DEER CREEK

Direction and distance from nearest town, village or store 3.5 MI. S. OF NARDIN

Section, Township and Range SEC. 8 T26 N-R2W

Description of Location CENTER OF CREEK BRIDGE  
5.4' OVER CONC. BRIDGE FLOOR

Elevation \_\_\_\_\_ Source of levels \_\_\_\_\_

Method obtained STEEL TAPE Date obtained OCT 16, 1973

Did it appear to be  normal  medium  extreme  do not know

Was highwater mark obtained from actual water, drift, local resident, U. S. Engineers, etc.? WATER MARK ON STEEL TRUSS SPAN

Explanatory Remarks THIS WATER OVER ROAD 1 MI. N. & S. OF BRIDGE

Location to be shown on back of this sheet as a check.

Field Note: To be sent to  
Survey Engineer

Jeray E. Diggins  
Chief of Party

OCT 25, 1973  
Date

Loc. No. 27

R 3 W

R 2 W

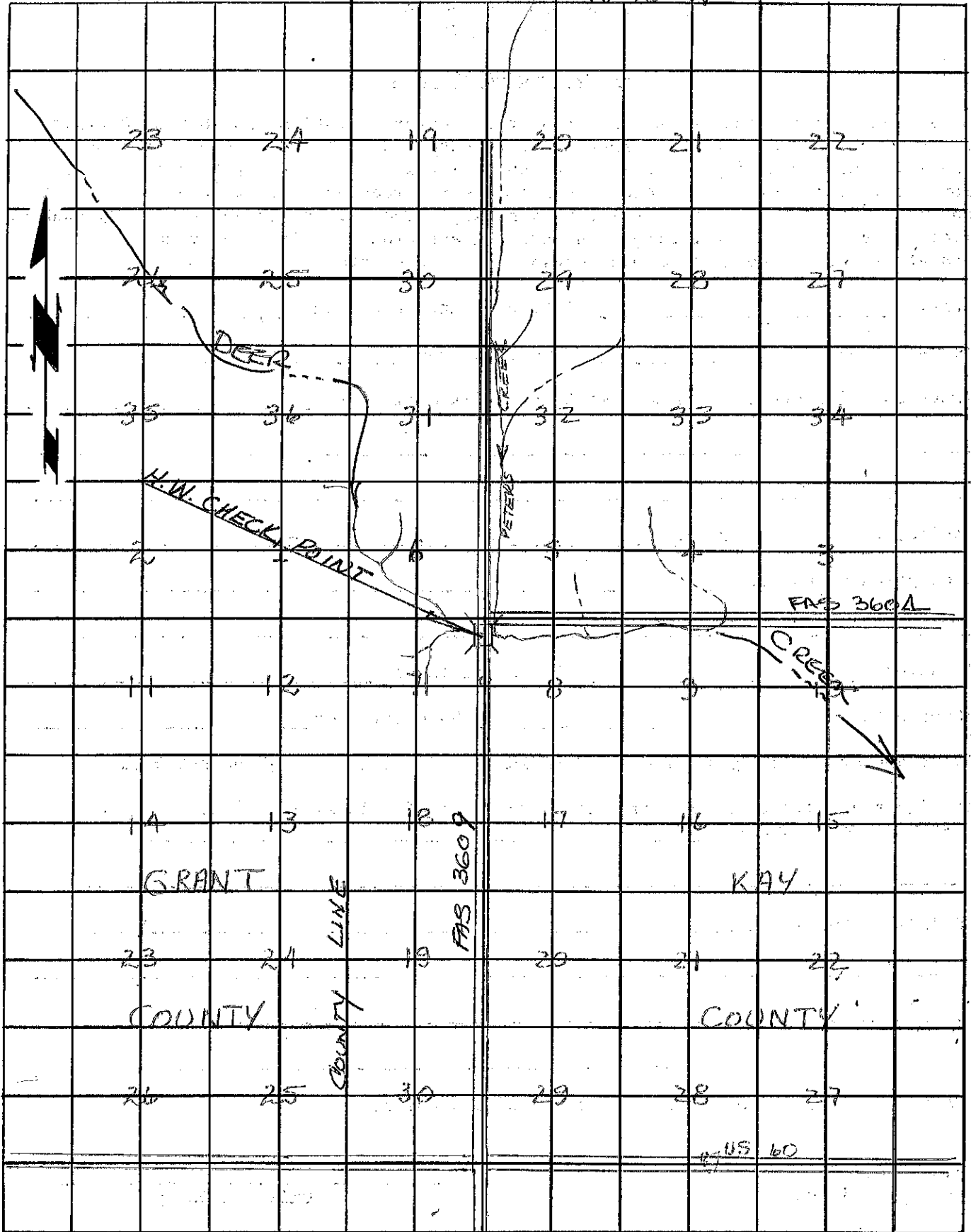

T 27 N

T 26 N