

STATE OF OKLAHOMA  
DEPARTMENT OF HIGHWAYS  
SURVEY DIVISION

FLOOD INFORMATION FORM

To be used in obtaining and transmitting flood water elevations for Survey Division office record files. This information to be obtained by all Chiefs of Party or others in their vicinity in times of unusual high water, or at any time available from a reliable source. The elevations can be recorded by level reading, by measurement from bridge floor, in relation to a house, above roadbed or any other dependable, clear manner that fits the situation, the highest order possible to be used. Separate report to be made on each crossing or place obtained.

County Kay Date highwater occurred Nov. 21, 1979

Highway number SH 11 Name of stream Spring Creek

Direction and distance from nearest town, village or store 1 mi. W. of US 77.

This is 2 mi. west of ~~Newkirk~~ Kildard.

Section, Township and Range Sec. 16, T27N-R2E

Description of Location Centerline of Asp. on centerline of bridge, 4.0' over this point. NOTE: 0.75' Over Oct. 1973 and Aug. 1979 mark on porch step on residence N.W.

Elevation .75' above SWO 3115(1) H.W. Source of levels \_\_\_\_\_

Method obtained Cloth Tape. Date obtained Nov. 21, 1979 by Mr. Hayes.  
Dec. 4, 1979 by me.

Did it appear to be  normal  medium  extreme  do not know

Was highwater mark obtained from actual water, drift, local resident, U. S. Engineers, etc.? Drift & Mud Line & Resident NW of Bridge.

Explanatory Remarks Mr. Hayes furnished this office a mark following Oct. 1973 flood.

He stated this was the highest the creek has ever gotten and he has lived in this homesite most of his life. He looks to be 75 yrs. old.

Location to be shown on back of this sheet as a check.

Field Note: To be sent to  
Survey Engineer

Leroy E. Higginbotham  
Chief of Party

Dec. 11, 1979

Date

*Location No. 31*

R2E

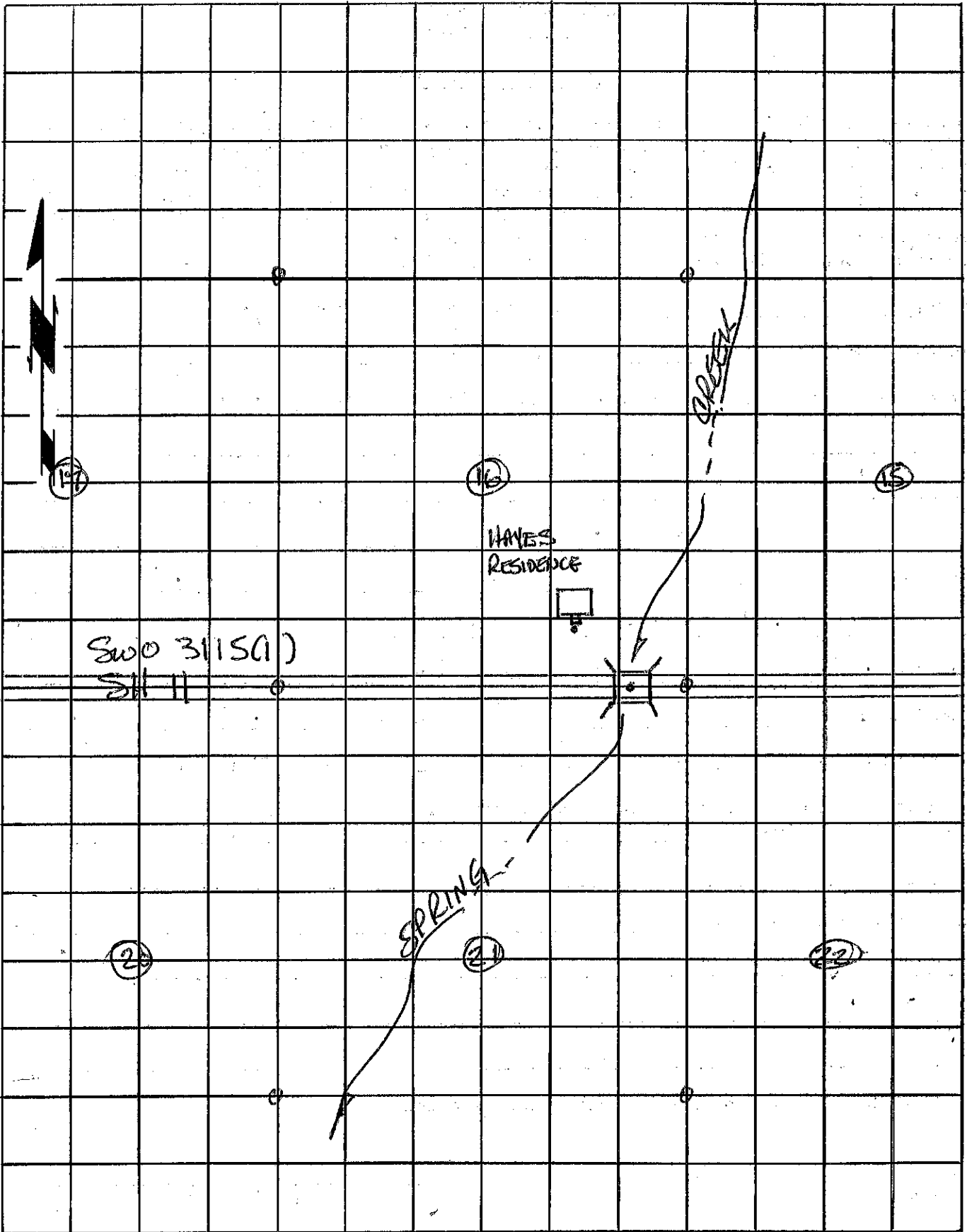

T  
27  
N

SWO 3115(1)

HAYES  
RESIDENCE

SPRING

SPRING

14

16

15

21

21

22