

STATE OF OKLAHOMA  
DEPARTMENT OF HIGHWAYS  
SURVEY DIVISION

FLOOD INFORMATION FORM

To be used in obtaining and transmitting flood water elevations for Survey Division office record files. This information to be obtained by all Chiefs of Party or others in their vicinity in times of unusual high water, or at any time available from a reliable source. The elevations can be recorded by level reading, by measurement from bridge floor, in relation to a house, above roadbed or any other dependable, clear manner that fits the situation, the highest order possible to be used. Separate report to be made on each crossing or place obtained.

County KAY Date highwater occurred OCT 11, 1973

Highway number SH 11 Name of stream THOMPSON CREEK

Direction and distance from nearest town, village or store 5 MI. W. OF BLACKWELL

Section, Township and Range SEC 23, T 27 N - R 2 W

Description of Location CENTER OF CREEK BRIDGE  
3.9' OVER BRIDGE FLOOR

Elevation \_\_\_\_\_ Source of levels \_\_\_\_\_

Method obtained STEEL TAPE Date obtained OCT 17, 1973

Did it appear to be  normal  medium  extreme  do not know

Was highwater mark obtained from actual water, drift, local resident, U. S. Engineers, etc.? WATER MARK ON BRIDGE

Explanatory Remarks THIS WATER WAS LEVEL WITH TOP OF CONC. BANNISTERS

Location to be shown on back of this sheet as a check.

Field Note: To be sent to  
Survey Engineer

Jeremy E. Shigginbotham  
Chief of Party

OCT 25, 1973  
Date

Loc. No. 34

R 2 W

R 1 W

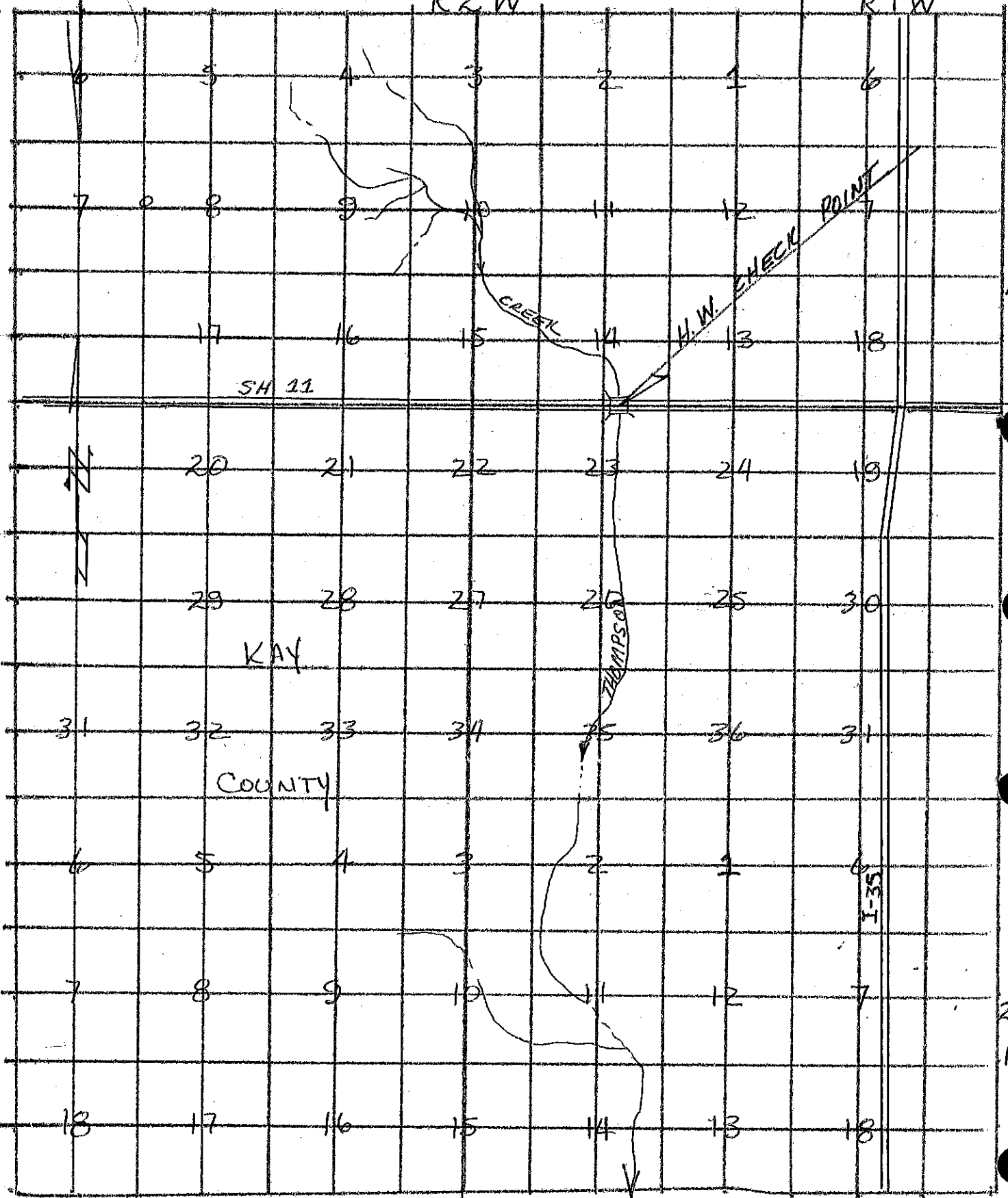

T 27 N

T 26 N