

RECEIVED
NOV 13 1973
SURVEY DIVISION

Survey Division
Form No. 16
Rev. Sept. 10, 1961

STATE OF OKLAHOMA
DEPARTMENT OF HIGHWAYS
SURVEY DIVISION

FLOOD INFORMATION FORM

To be used in obtaining and transmitting flood water elevations for Survey Division office record files. This information to be obtained by all Chiefs of Party or others in their vicinity in times of unusual high water, or at any time available from a reliable source. The elevations can be recorded by level reading, by measurement from bridge floor, in relation to a house, above roadbed or any other dependable, clear manner that fits the situation, the highest order possible to be used. Separate report to be made on each crossing or place obtained.

County KAY Date highwater occurred OCT 11, 1973

Highway number SH 11 Name of stream DEER CREEK (BRANCH)

Direction and distance from nearest town, village or store 1000' E. OF KAY - GRANT CO. LINE. 10 MI. W. OF BLACKWELL

Section, Township and Range SEC 19, T 27 N - R 2 W

Description of Location CENTER OF BRANCH BRIDGE
1.5' OVER PAVEMENT & BRIDGE

Elevation _____ Source of levels _____

Method obtained STEEL TAPE Date obtained OCT 17, 1973

Did it appear to be normal medium extreme do not know

Was highwater mark obtained from actual water, drift, local resident, U. S. Engineers, etc.? WATER MARK ON FENCES AND DRIFT

Explanatory Remarks _____

Location to be shown on back of this sheet as a check.

Field Note: To be sent to
Survey Engineer

Leroy E. Higginbotham
Chief of Party

OCT 25, 1973
Date

Loc. No. 35

R 2 W

R 1 W

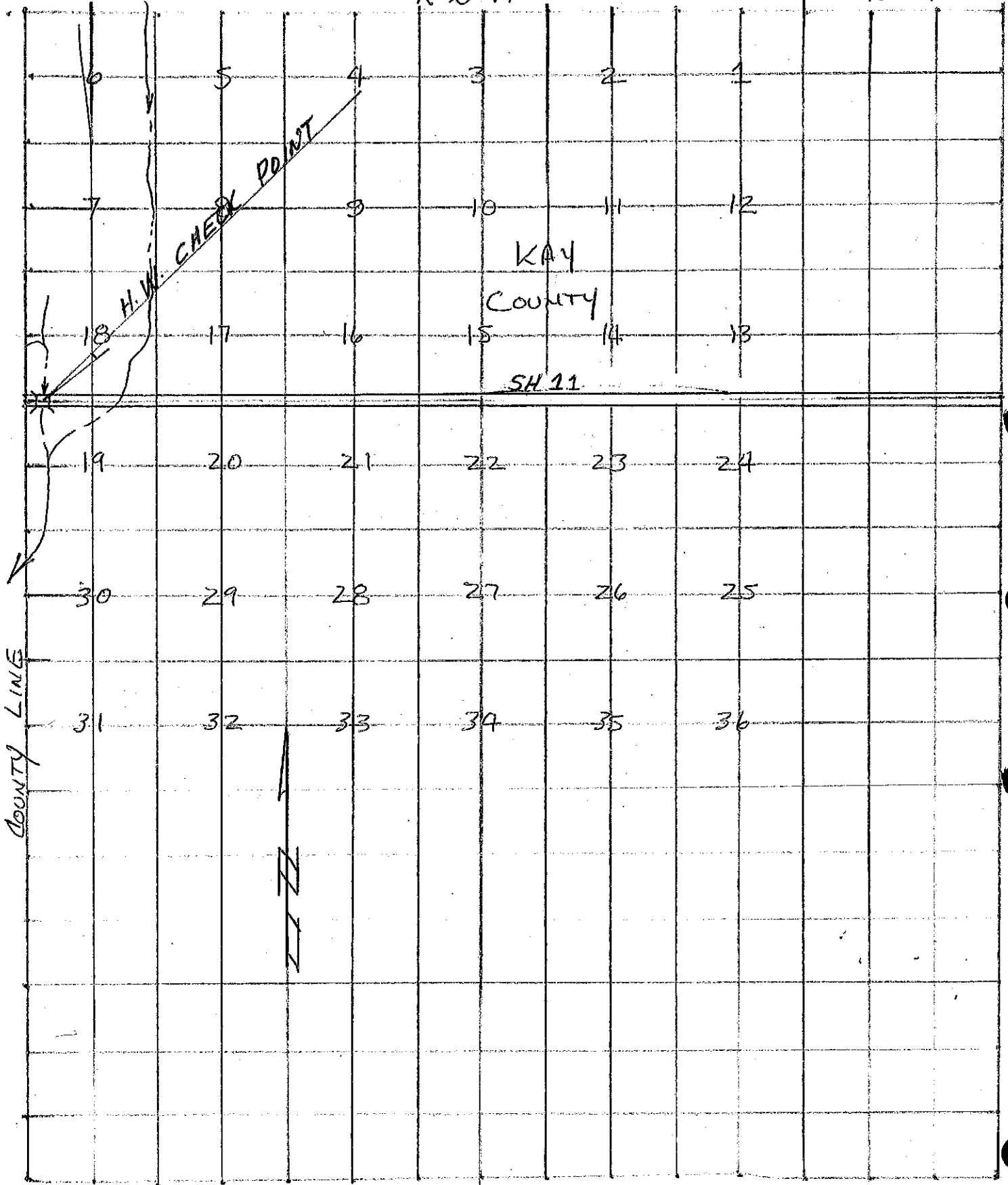

KAY
COUNTY

SH 11

H.W. CHECK POINT

COUNTY LINE

T
27
N