



**OKLAHOMA DEPARTMENT OF TRANSPORTATION
SURVEY DIVISION**

FLOOD INFORMATION FORM

Division #:	1 <input type="checkbox"/> 2 <input type="checkbox"/> 3 X 4 <input type="checkbox"/> 5 <input type="checkbox"/> 6 <input type="checkbox"/> 7 <input type="checkbox"/> 8 <input type="checkbox"/>
County:	Johnston
Date Highwater occurred:	12/26/2015
Highway Number:	SH 22
Name of Stream:	Butcher Pen Creek
Direction and distance from nearest town, or highway junction	From Nida, OK, SH22 & SH78, Go approx. 2.5 west & 1.5 Northwest to location.
Section, Township, Range:	Section 34, T-4-S, R-7-E
Description of Location:	No Plans found
Highwater Elevation:	666.86
Level Datum & Source:	NAVD 88 USING GEOID 12B
Method used:	Rapid Static GPS
Date Elevation Obtained:	12/29/2015
Apparent Magnitude:	Normal <input type="checkbox"/> Medium <input type="checkbox"/> Extreme X Don't Know <input type="checkbox"/>
Was Highwater Mark obtained from actual water, drift, local resident, or other source?	Highwater information was obtained from current drift left by recent Heavy Rain. Flooding had washed out part of the roadway
Explanatory Remarks:	Heavy rains in upper drainage area

Note: Show Vicinity Map on back of form

Name (signature)

Name (Printed)

Robert Uhles

Date:

12/29/1015

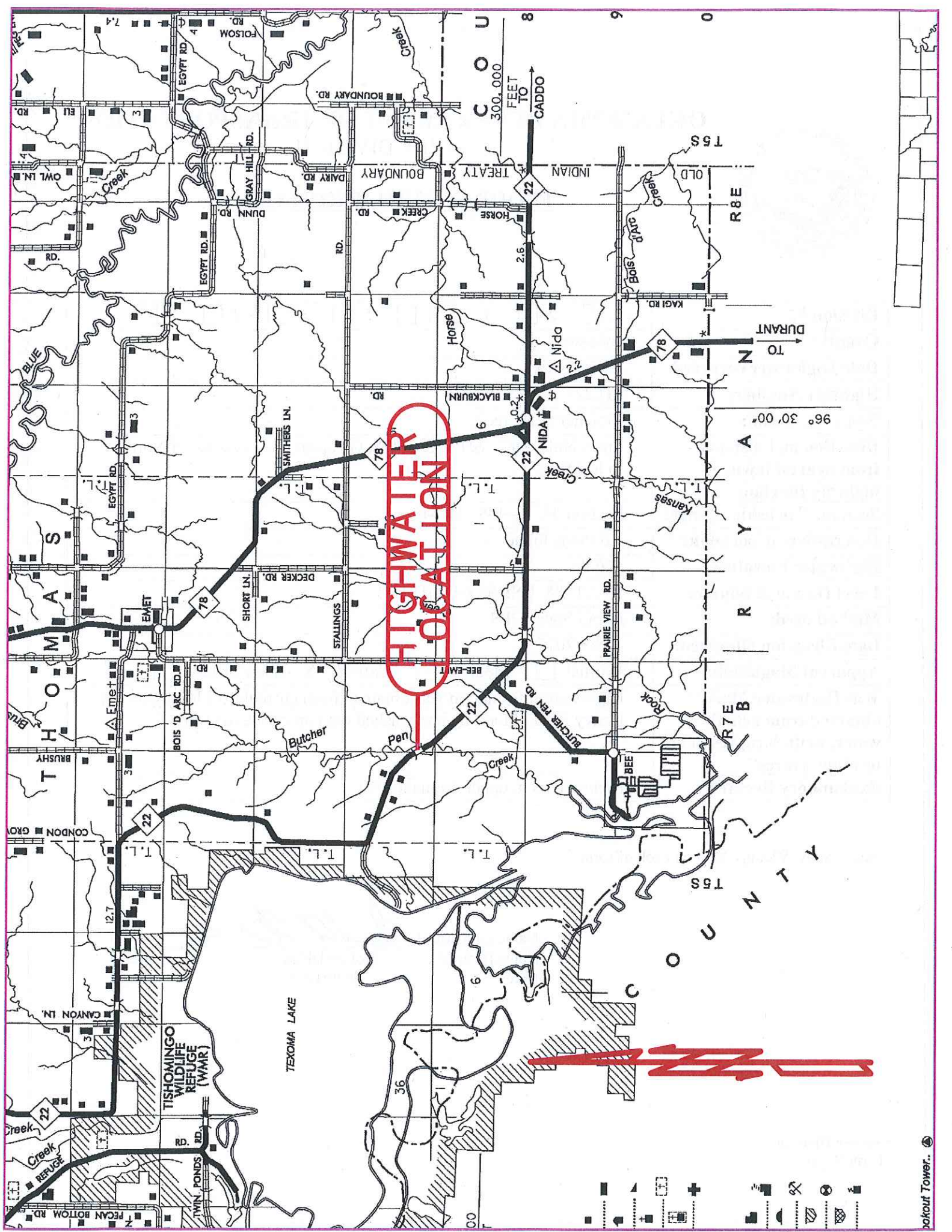

**HIGHWATER
LOCATION**