

Plans & Survey Dept.
Form No. 16
Rev. July 10, 1947

STATE OF OKLAHOMA
DEPARTMENT OF HIGHWAYS
PLANS AND SURVEY DEPARTMENT

FLOOD INFORMATION FORM

To be used in obtaining and transmitting flood water elevations for Plans & Survey office record files. This information to be obtained by all Chiefs of Party in their vicinity in times of unusual high water, or at any time available from a reliable source. The elevations can be recorded by level reading, by measurement from bridge floor, in relation to a house, above roadbed or any other dependable, clear manner that fits the situation, the highest order possible to be used. Separate report to be made on each crossing or place obtained.

County Johnston Date highwater occurred May 18, 1957

Highway number SH 99 Name of stream Washita River

Direction and distance from nearest town, village or store _____
2 miles south of Tishomingo

Section, Township and Range Sec. 8 - T 4 S - R 6 E

Description of Location At River bridge on present SH 99

Method obtained By measuring from bridge floor. 7.5 feet below bridge floor.

Elevation 7.5 feet below bridge floor Source of levels _____

Was highwater mark obtained from actual water, drift, local resident, U. S. Engineers, etc? Actual water

Explanatory Remarks Information by E.M. Brownlee

Location to be shown on back of this sheet as a check.

Field Note: To be sent to Engr. of Plans & Survey (1 copy).
Office Note: To be filed in Flood Information by Counties.

Ray M. Dudley
Chief of Party
6-7-57
Date

Location ~~NO~~ 4

R 6 E

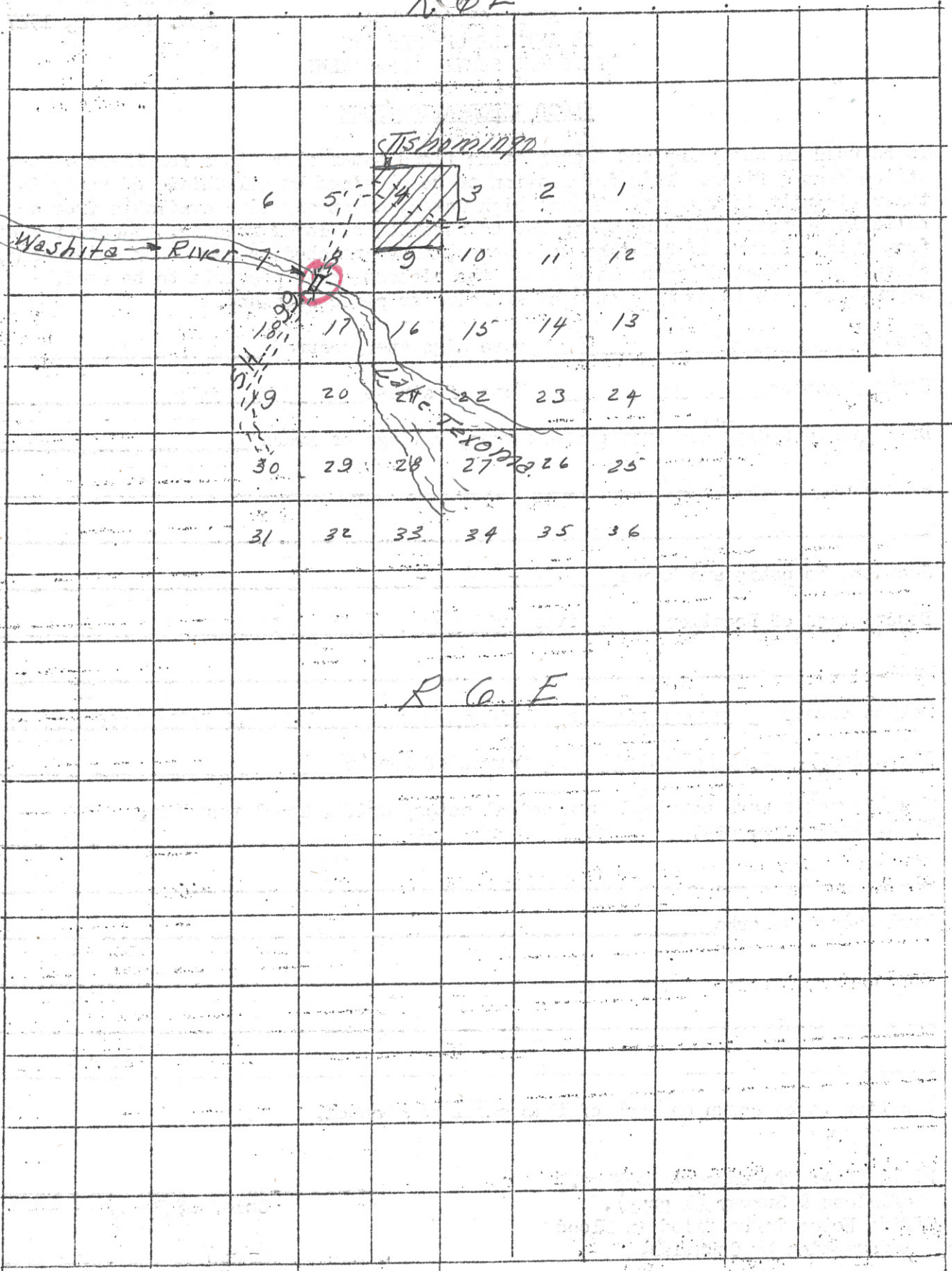

T
4
S

T
4
S

