

RECEIVED
MAY 16 1968
SURVEY DIVISION

STATE OF OKLAHOMA
DEPARTMENT OF HIGHWAYS
PLANS AND SURVEY DEPARTMENT

SURVEY DIVISION	PHS						
	HWY	✓	WIM	✓	GWP	OCC	GER
							SDD

57668
Plans & Survey Dept.
Form No. 16
Rev. July 10, 1947

FLOOD INFORMATION FORM

To be used in obtaining and transmitting flood water elevations for Plans & Survey office record files. This information to be obtained by all Chiefs of Party in their vicinity in times of unusual high water, or at any time available from a reliable source. The elevations can be recorded by level reading, by measurement from bridge floor, in relation to a house, above roadbed or any other dependable, clear manner that fits the situation, the highest order possible to be used. Separate report to be made on each crossing or place obtained.

County Johnston Date highwater occurred May 14, 1968

Highway number SH. 12 Name of stream Washita River

Direction and distance from nearest town, village or store Approx. 2.5 Miles southwest of Ravia, and 2.5 miles northeast of Russett.

Section, Township and Range Sec. 4 - T4S - R5E

Description of Location On edge of asphalt near intersection of SH. 12 and County road, 0.5 miles north of Washita river bridge.

Method obtained Y - Level

Elevation 647.29 Source of levels USC & GS. - F-89 (11) Plans

Was highwater mark obtained from actual water, drift, local resident, U. S. Engineers, etc? Actual water

Explanatory Remarks The Highwater Elev. shown was obtained 100 Ft. Right of Sta. 291+00 of FAP. No. F-89 (11) Plans

Location to be shown on back of this sheet as a check.

Field Note: To be sent to Engr. of Plans & Survey (1 copy).
Office Note: To be filed in Flood Information by Counties.

Ray M. Seely
~~Chief of Party~~
Location Engineer
5-14-68
Date

RECEIVED

NOV 21 1950

100' 0"

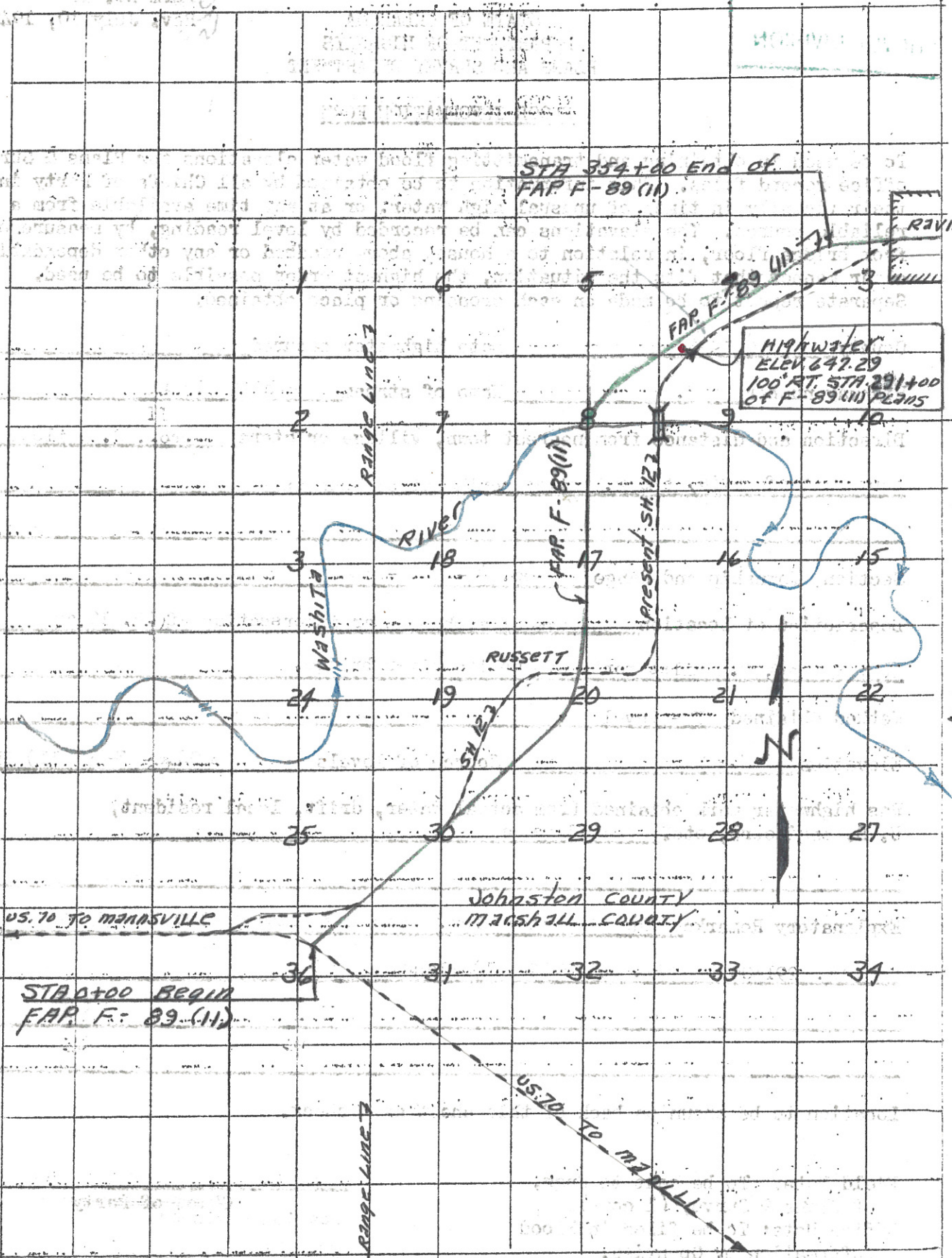

R4E

R5E