

STATE OF OKLAHOMA
DEPARTMENT OF HIGHWAYS
SURVEY DIVISION

Survey Division
Form No. 16
Rev. Sept. 10, 1961

FLOOD INFORMATION FORM

To be used in obtaining and transmitting flood water elevations for Survey Division office record files. This information to be obtained by all Chiefs of Party or others in their vicinity in times of unusual high water, or at any time available from a reliable source. The elevations can be recorded by level reading, by measurement from bridge floor, in relation to a house, above roadbed or any other dependable, clear manner that fits the situation, the highest order possible to be used. Separate report to be made on each crossing or place obtained.

County JOHNSTON Date highwater occurred 10-13-81 AND 5-5-90

Highway number S.H. 22 Name of stream ROCK CREEK

Direction and distance from nearest town, village or store _____

APPROX, 2½ MILES WEST OF NIDA

Section, Township and Range SEC. 2 T-5-S, R-7-E

Description of Location AT STA. 484+95.58 ON S.A.P. 844 PLANS

Elevation 10-13-81 589.20 5-5-90 585.6 Source of levels S.A.P. 844 PLANS

Method obtained HAND LEVEL AND LEVEL ROD Date obtained 10-15-81 AND 5-10-90

Did it appear to be normal medium extreme do not know

Was highwater mark obtained from actual water, drift, local resident, U. S. Engineers, etc.? DRIFT

Explanatory Remarks HEAVY RAINS IN UPER DRAINAGE AREA

Location to be shown on back of this sheet as a check.

Field Note: To be sent to
Survey Engineer

MC: Bridge Division
(5-18-90)

John Wayne Garland
~~XXXXXXXXXXXX~~
PROF. LAND SURVEYOR
5-17-90
Date

Copy to Bridge Div. 7-11-90

Location No. 13

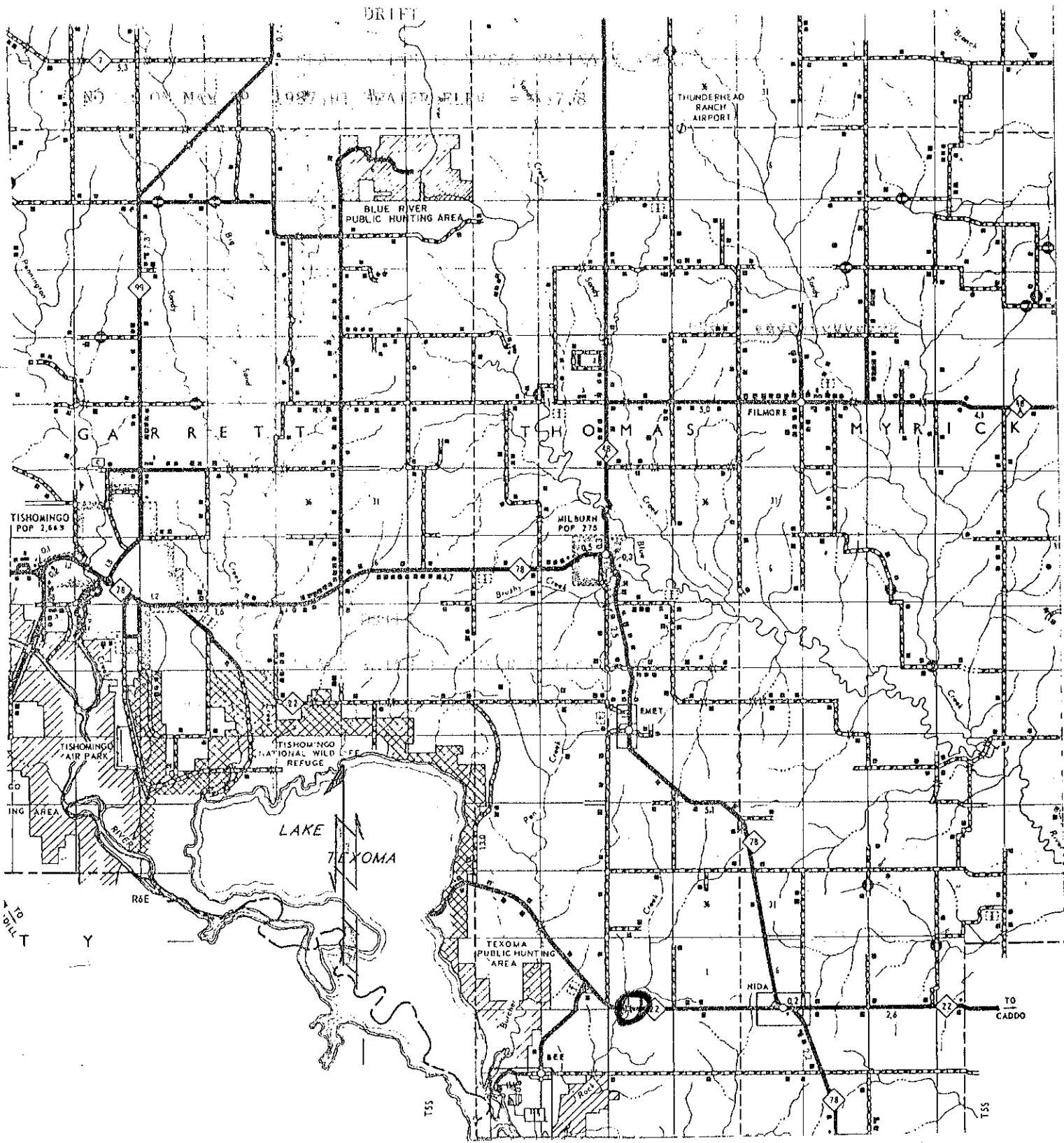

DRIFT

NO. 1 ON MAY 10 1927 THE WATER FLOW WAS 7.8

THUNDERHEAD RANCH AIRPORT

BLUE RIVER PUBLIC HUNTING AREA

FILMORE

G A R R E T T

T H O M A S

M Y R I C K

TISHOMINGO

WILBURN

POP 2,663

POP 275

TISHOMINGO AIR PARK

TISHOMINGO NATIONAL WILD REFUGE

LAKE TEXOMA

TEXOMA PUBLIC HUNTING AREA

NIDA

TO CADDO

TO STILL

T55