

STATE OF OKLAHOMA
DEPARTMENT OF HIGHWAYS
PLANS AND SURVEY DEPARTMENT

FLOOD INFORMATION FORM

To be used in obtaining and transmitting flood water elevations for Plans & Survey office record files. This information to be obtained by all Chiefs of Party in their vicinity in times of unusual high water, or at any time available from a reliable source. The elevations can be recorded by level reading, by measurement from bridge floor, in relation to a house, above roadbed or any other dependable, clear manner that fits the situation, the highest order possible to be used. Separate report to be made on each crossing or place obtained.

County Jefferson Date highwater occurred May 10 1950

Highway number S.H. 5 Name of stream Water from Cow Creek

Direction and distance from nearest town, village or store At the intersection of West "D" Ave. & N.W. 2nd St in Waurika

Section, Township and Range _____

Description of Location Sta 1007+01 - on N.P.S 347-F where S.H. 5 enters Waurika from the North and turns East to Main St

Method obtained Level Shots

Elevation 3.2' Higher than st. int. Source of levels _____

Was highwater mark obtained from actual water, drift, local resident, U. S. Engineers, etc? HW. Was obtained from Numerous Water Marks left on surrounding houses

Explanatory Remarks _____

Location to be shown on back of this sheet as a check.

Field Note: To be sent to Engr. of Plans & Survey (1 copy).
Office Note: To be filed in Flood Information by Counties.

C. S. Worth
C. S. WORTH Chief of Party
Ass't. Engr. of Plans & Surveys
May 12 1950
Date

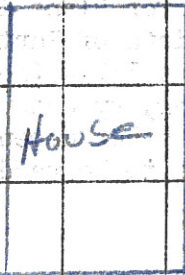

House

N. W. Road St

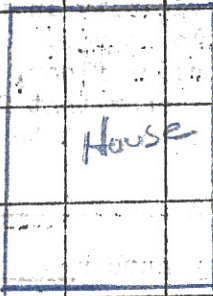

House



HW

'D' Ave

City of Wauvika

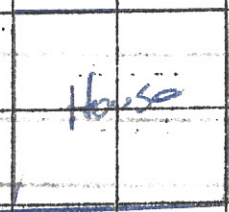

House

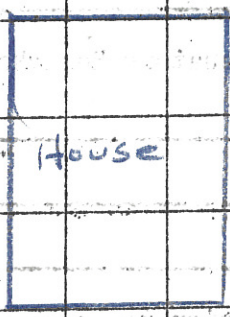

House

