

STATE OF OKLAHOMA  
DEPARTMENT OF HIGHWAYS  
PLANS AND SURVEY DEPARTMENT

FLOOD INFORMATION FORM

To be used in obtaining and transmitting flood water elevations for Plans & Survey office record files. This information to be obtained by all Chiefs of Party in their vicinity in times of unusual high water, or at any time available from a reliable source. The elevations can be recorded by level reading, by measurement from bridge floor, in relation to a house, above roadbed or any other dependable, clear manner that fits the situation, the highest order possible to be used. Separate report to be made on each crossing or place obtained.

County Jefferson Date highwater occurred May 10, 1950

Highway number U.S. 81 Name of stream Backwater from Cow Creek

Direction and distance from nearest town, village or store Just North of Addington, At 1st Culvert North of the City limits

Section, Township and Range Sec 32 T-3-S R-7-W

Description of Location At 4x2 Culvert Just North of Addington Sta 352+61 on F.A.P. 244

Method obtained Level

Elevation N.W. on top of Pavement At Culvert Source of levels \_\_\_\_\_

Was highwater mark obtained from actual water, drift, local resident, U. S. Engineers, etc? N.W. was determined by Drift & Silt Deposit

Level on Pavement at Sta 352+61 on F.A.P. 244 At Culvert

Explanatory Remarks \_\_\_\_\_

Location to be shown on back of this sheet as a check.

Field Note: To be sent to Engr. of Plans & Survey (1 copy).  
Office Note: To be filed in Flood Information by Counties.

C. S. Wortham  
C. S. WORTHAM ~~Chief of Party~~  
Ass't. Engr. of Plans & Surveys  
5/12/50  
Date

R-8-W

R-7-W

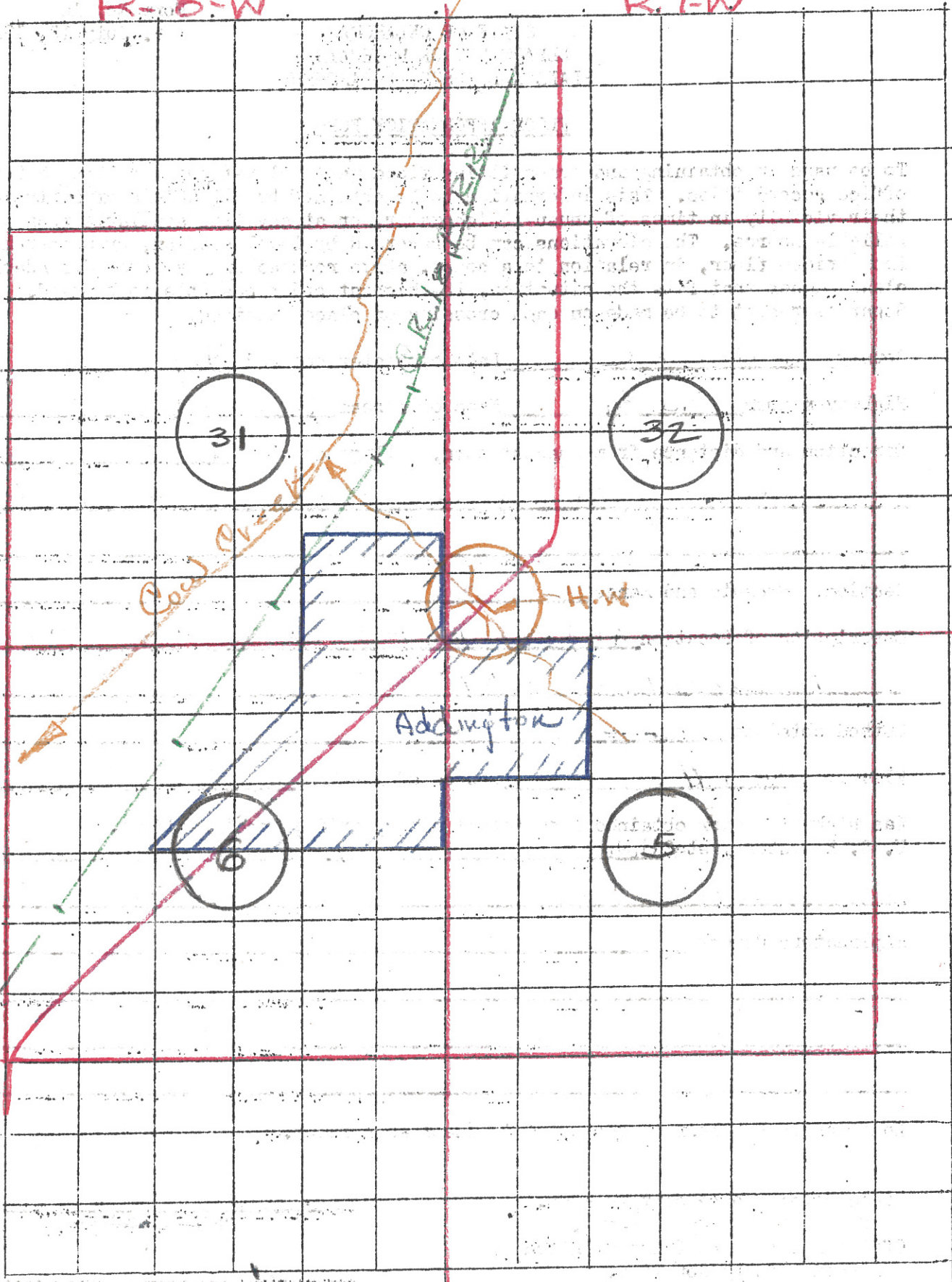

31

32

6

5

Addington

H.W.

Coad Creek

R.R.

T 6 W

T 4 S