

STATE OF OKLAHOMA
DEPARTMENT OF HIGHWAYS
PLANS AND SURVEY DEPARTMENT

FLOOD INFORMATION FORM

To be used in obtaining and transmitting flood water elevations for Plans & Survey office record files. This information to be obtained by all Chiefs of Party in their vicinity in times of unusual high water, or at any time available from a reliable source. The elevations can be recorded by level reading, by measurement from bridge floor, in relation to a house, above roadbed or any other dependable, clear manner that fits the situation, the highest order possible to be used. Separate report to be made on each crossing or place obtained.

County JEFFERSON Date highwater occurred May 18-19, 1951

Highway number S.H. 5 Name of stream Cow Creek & Beaver Creek

Direction and distance from nearest town, village or store At the C.R.I.&P.

C.R.I.&P. RR Grade Xing on S.H. 5 at the NW Edge of Navika

Section, Township and Range Sec 26 T 45 R 8W

Description of Location Sta 941+40.8 ± C.R.I.&P. RR N.R. 5347.F.

Method obtained _____

Elevation 22 H.W. is 4.6 Lower than Top Rail Source of levels N.R. 5347.F.

Was highwater mark obtained from actual water, drift, local resident, U. S. Engineers, etc? From actual water lines & drift.

Explanatory Remarks Obtained with a wye level by A. B. Stephens and Roy Flowers

Location to be shown on back of this sheet as a check.

Field Note: To be sent to Engr. of Plans & Survey (1 copy).
Office Note: To be filed in Flood Information by Counties.

A. B. Stephens
Chief of Party
Res Engineer
May 23, 1951
Date

NOTE: SEE NO. 4 ATTACHED MAP FOR LOCATION.

1:250,000
FEET

9600

S T E P H E N

R 9 W

R 8 W

R 7 W

T 3 S
T 4 S
T 5 S
T 6 S

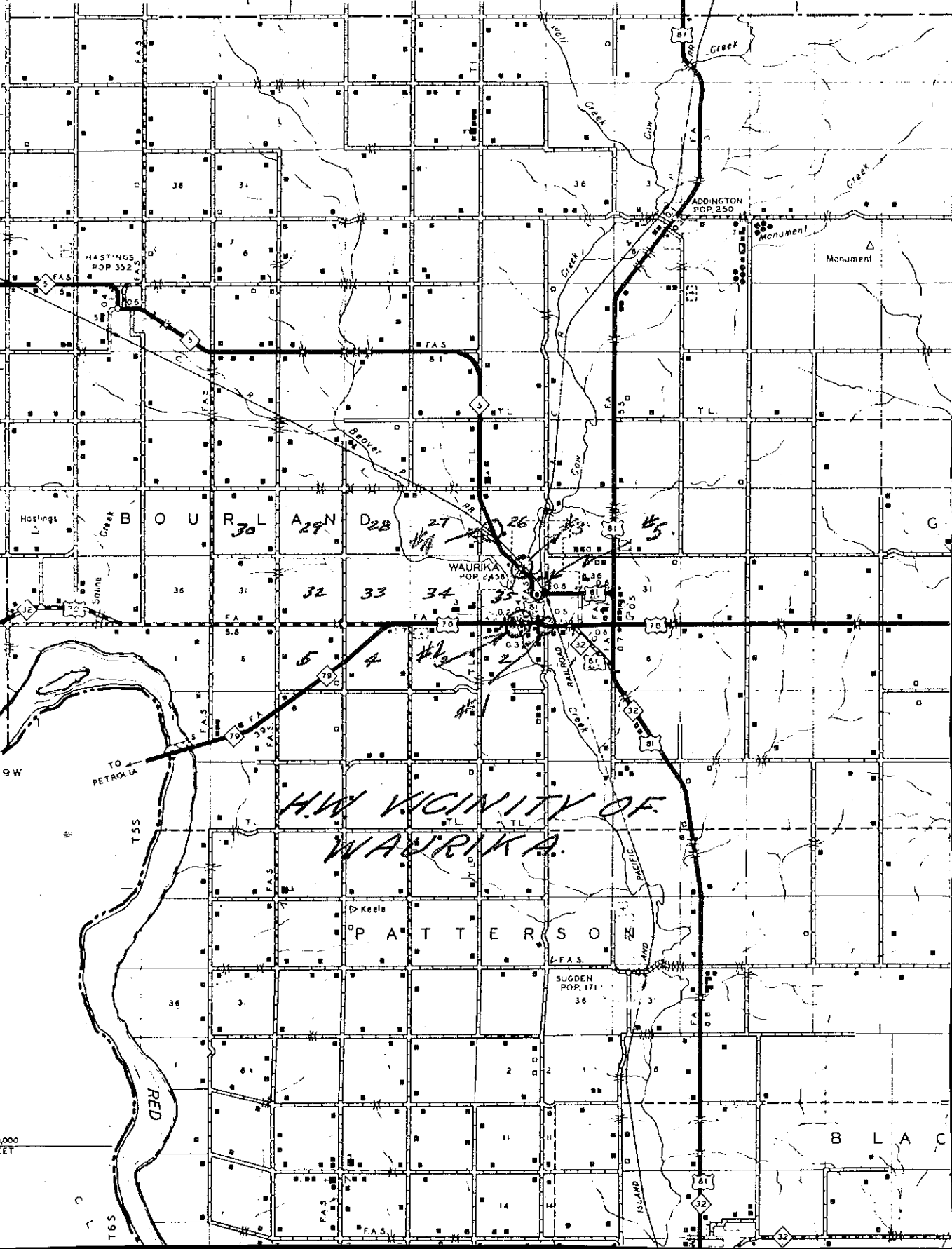

H.W. VICINITY OF
WAURIKA

PATTERSON

BLAC

240,000
FEET